

GREENVILLE, S.C.
AUG 13 4 10 PM '84
DORRIS & TANKERSLEY
R.L.M.C.

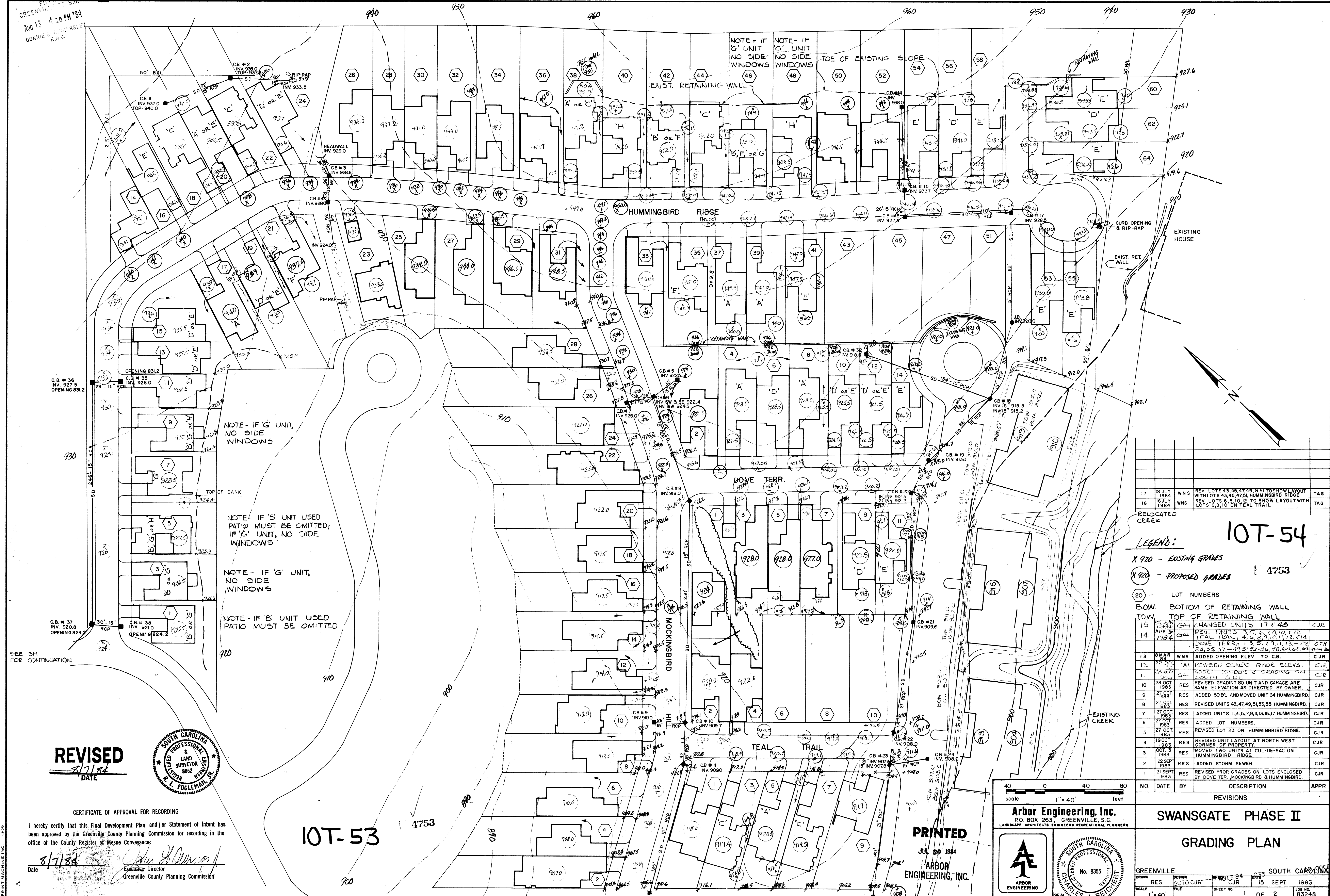

NOTE - IF 'G' UNIT,
NO SIDE
WINDOWS

NOTE - IF 'B' UNIT USED
PATIO MUST BE OMITTED;
IF 'G' UNIT, NO SIDE
WINDOWS

NOTE - IF 'G' UNIT,
NO SIDE
WINDOWS

NOTE - IF 'B' UNIT USED
PATIO MUST BE OMITTED

17	18 JULY 1984	WNS	REV. LOTS 43, 45, 47, 49, & 51 TO SHOW LAYOUT WITH LOTS 43, 45, 47, 51, HUMMINGBIRD RIDGE	TAG
16	16 JULY 1984	WNS	REV. LOTS 6, 8, 10, 12 TO SHOW LAYOUT WITH LOTS 6, 8, 10 ON TEAL TRAIL	TAG

RELOCATED CREEK

LEGEND:
X 920 - EXISTING GRADES
X 929 - PROPOSED GRADES
20 - LOT NUMBERS

NO.	DATE	BY	DESCRIPTION	APPR.
15	22 JUN 1984	GAH	CHANGED UNITS 17 & 43	CJR
14	17 APR 1984	GAH	REV. UNITS 3, 5, 6, 7, 8, 10, 11, 12, 13, 14, 15, 16, 17, 18, 19, 20, 21, 22, 23, 24, 25, 26, 27, 28, 29, 30, 31, 32, 33, 34, 35, 36, 37, 38, 39, 40, 41, 42, 43, 44, 45, 46, 47, 48, 49, 50, 51, 52, 53, 54, 55, 56, 57, 58, 59, 60, 61, 62, 63, 64	CJR
13	8 MAR 84	WNS	ADDED OPENING ELEV. TO C.B.	CJR
12	22 FEB 84	TAH	REVISED CONDO FLOOR ELEV. SOUTH SIDE	CJR
11	28 OCT 1983	RES	ADDED 50' PL. AND MOVED UNIT 64 HUMMINGBIRD, SAME ELEVATION AS DIRECTED BY OWNER.	CJR
10	27 OCT 1983	RES	REVISED UNITS 43, 47, 49, 51, 53, 55 HUMMINGBIRD.	CJR
9	27 OCT 1983	RES	ADDED UNITS 1, 3, 5, 7, 9, 11, 13, 15, 17 HUMMINGBIRD.	CJR
8	27 OCT 1983	RES	ADDED LOT NUMBERS.	CJR
7	27 OCT 1983	RES	REVISED LOT 23 ON HUMMINGBIRD RIDGE.	CJR
6	19 OCT 1983	RES	REVISED UNIT LAYOUT AT NORTH WEST CORNER OF PROPERTY.	CJR
5	22 SEPT 1983	RES	MOVED TWO UNITS AT CUL-DE-SAC ON HUMMINGBIRD RIDGE.	CJR
4	22 SEPT 1983	RES	ADDED STORM SEWER.	CJR
3	21 SEPT 1983	RES	REVISED PROP. GRADES ON LOTS ENCLOSED BY DOVE TER., MOCKINGBIRD & HUMMINGBIRD.	CJR

10T-54

4753

REVISED
8/7/84
DATE



CERTIFICATE OF APPROVAL FOR RECORDING

I hereby certify that this Final Development Plan and/or Statement of Intent has been approved by the Greenville County Planning Commission for recording in the office of the County Register of Mesne Conveyances.

Date 8/7/84
Executive Director
Greenville County Planning Commission

10T-53

4753

PRINTED

JUL 30 1984
ARBOR
ENGINEERING, INC.

40 0 40 80
scale 1" = 40' feet

Arbor Engineering, Inc.
P.O. BOX 263, GREENVILLE, S.C.
LANDSCAPE ARCHITECTS ENGINEERS RECREATIONAL PLANNERS

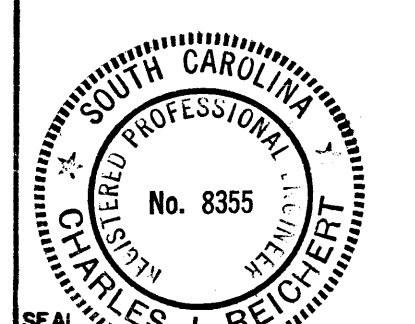
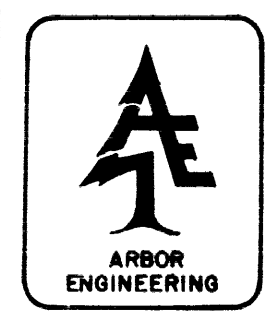

SWANSGATE PHASE II

GRADING PLAN

GREENVILLE	RES	15 SEPT. 1983	SOUTH CAROLINA
SCALE 1" = 40'	FILE	SHEET NO. 1 OF 2	JOB NO. 832-43