

MICROFILMED

FILED
GREENVILLE CO. S.C.
APR 3 3 56 PM '84
DONNIE S. TANKERSLEY
R.M.C.

SOUTHERN BANK & TRUST COMPANY

EAST COFFEE STREET

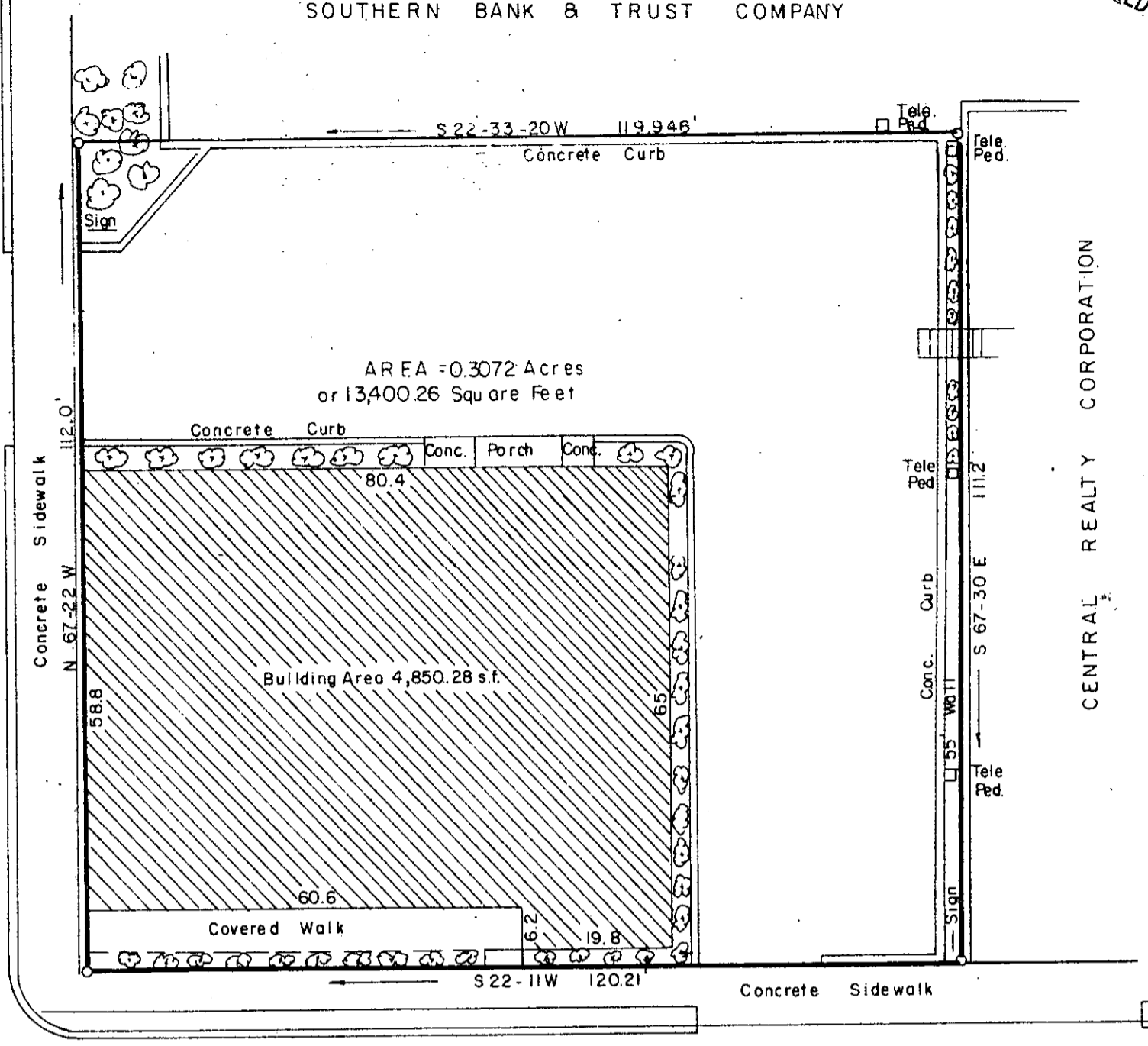

CENTRAL REALTY CORPORATION

NORTH CHURCH STREET (U.S. HWY. NO. 29)

30855

PROPERTY OF
STOKES BUILDING INVESTORS,
A GENERAL PARTNERSHIP
GREENVILLE COUNTY, S. C.

10-I-83

APR 3 1984

Scale 1" = 20' March, 1984
DALTON & NEVES CO., INC ENGINEERS
121 MANLY STREET
GREENVILLE, S. C.

REFERENCE PLAT

This is not a subdivision. This plat is for reference purposes only and is not to be used to create new lots or roads.

John George GKH

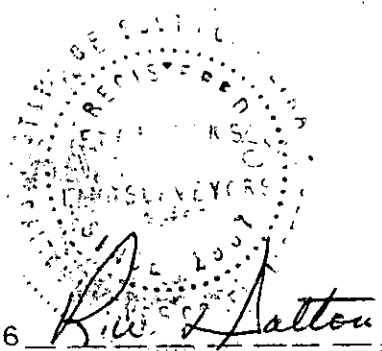

S. C. Reg. No. 916

500 8 005
31801