

MICROFILMED

Note:
5' Drainage & utility
encroachment each side all
side & rear lot lines
unless otherwise noted.

FILED
GREENVILLE CO. S. C.
DEC 21 3 24 PM '83

DONNIE S. YELLOWSLEY
R.M.C.

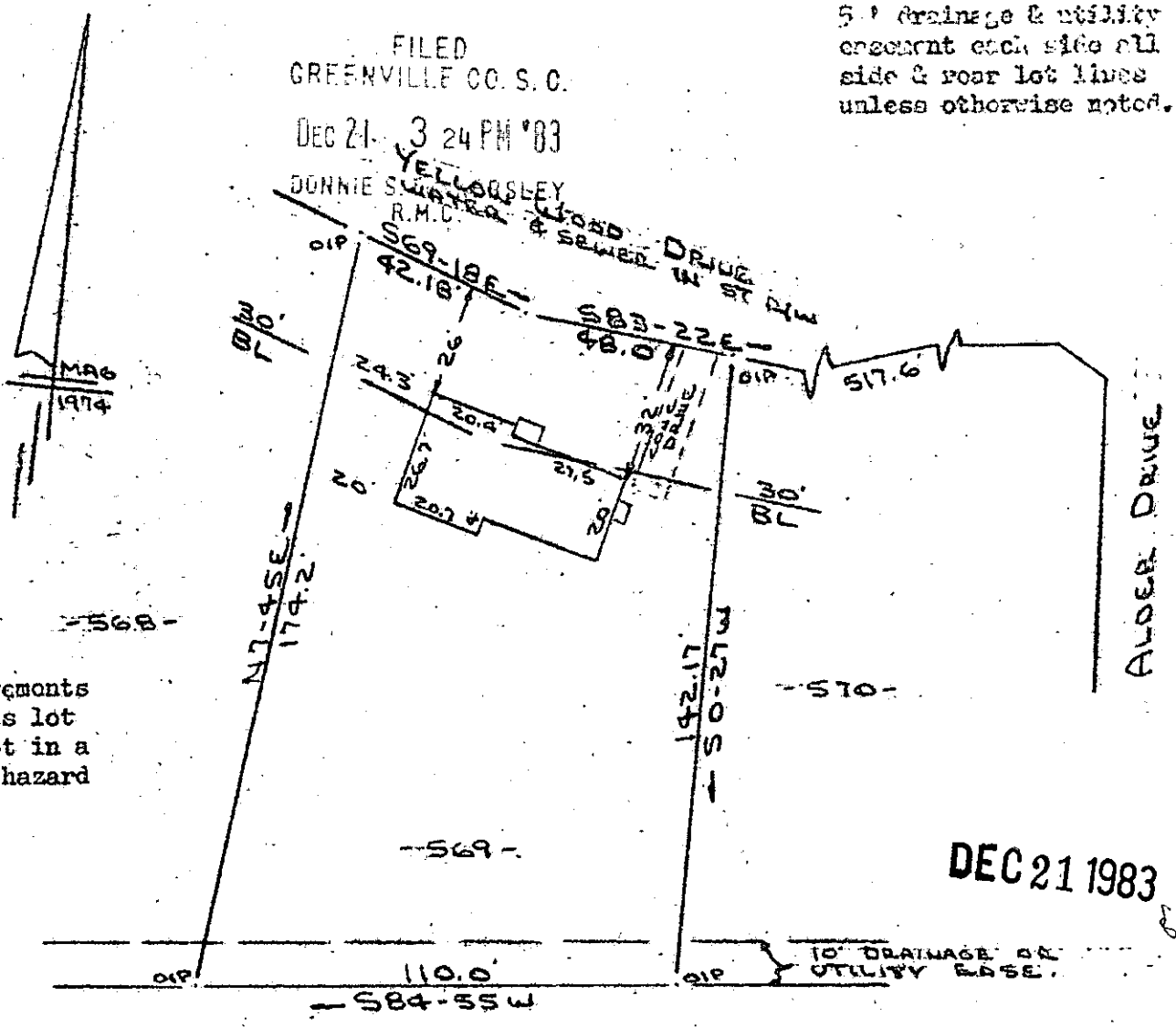

Note:
Improvements
on this lot
are not in a
flood hazard
area.

DEC 21 1983

JANIE D. DETRAVILLE
PROPERTY OF
ALLEN G. HUSE & SCARLETT H. HUSE
SIMPSONVILLE, S.C.
13 DEC 1983

106-14

19765

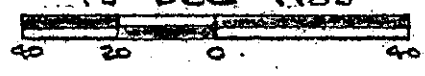

This is to certify that on the 13th day of December, 1983, I surveyed the property shown on this plat, being known as lot 569 on plat of Sheet No. 1 of 2 WESTWOOD SECTION VI and recorded in the REC Office Greenville County, S. C., in Plat Book " 4 - X " at Page 100; and that the property lines, walls and buildings are as shown hereon, and that the walls and buildings located on said lot do not encroach or project on adjacent street or property, and that no adjacent walls or buildings encroach or project on said premises, and no power lines cross this property except as shown hercon.

Recordable Plat

R. B. BRUCE
R. B. BRUCE, RLS #1952
SOUTH CAROLINA
REGISTERED
LAND SURVEYOR
OFFICE

CAROLINA TO SURVEYING
112 Mainly St., Greenville 29615 S. C. 3.00CD

574.13-1-15