

MICROFILMED

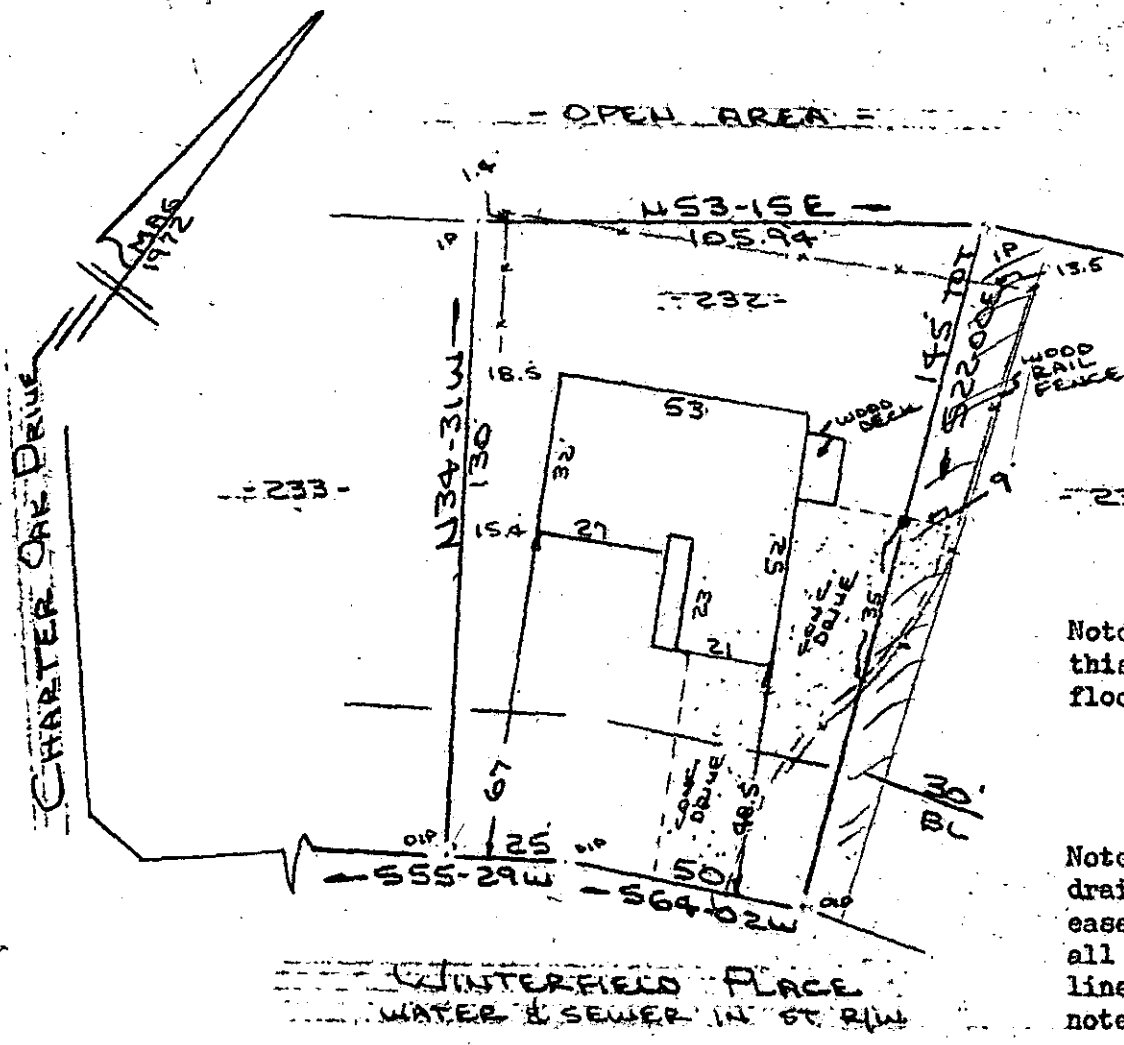

Note: Improvements on this lot are not in a flood hazard area.

Note: There is a 5' drainage & utility easement each side of all side and rear lot lines, unless otherwise noted.

PROPERTY OF  
**CRAIG A. WALKER & JANE R. WALKER**  
 NEAR GREENVILLE, S.C.  
 27 SEPT 1983

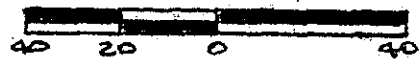

This is to certify that on the 27th day of September, 1983, I surveyed the property shown on this plat, being known as lot 232 on plat of SECTION NO. 2 PEPPERTREE and recorded in the RMC Office Greenville County, S. C., in Plat Book "4 - X" at Page 3; and that the property lines, walls and buildings are as shown hereon, and that the walls and buildings located on said lot do not encroach or project on adjacent street or property, and that no adjacent walls or buildings encroach or project on said premises, and no power lines cross this property except as shown hereon.

FILED  
 GREENVILLE S.C.  
 OCT 7 11 32 AM '83  
 BONNIE S. WILKESLEY  
 R.M.C.

10-B-61

11671

R. B. Bruce  
 R. B. Bruce  
 R. B. Bruce, RLS #1952

CAROLINA SURVEYING CO.  
 112. Manly St.  
 Greenville, S. C.

