

South Carolina Pursuant to a warrant from John Thomas Esq. Com. of Saluda River. Dated the 24th Nov. 1793. I have admeasured & laid out unto Robert Middleton a tract of one thousand acres of land. Situate in Greenville County bounded on all sides by the said Robert Middletons Land & hath such form & marks as the above plat represents. Certified the 1st Nov. 1793 James Little Deput. Recorded the 9th Nov. 1793

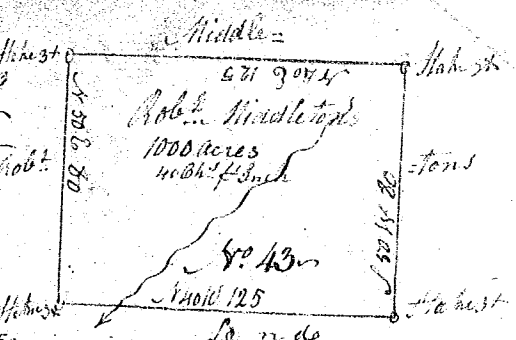

South Carolina Pursuant to a warrant from John Thomas Esq. Com. of Saluda River. Dated the 24th Oct. 1793. I have admeasured & laid out unto Robert Middleton a tract of one thousand acres of land. Situate in Greenville County on a branch of Saluda, bounded on all sides by the said Robert Middletons Land & hath such shape & marks as the above plat represents. Certified the 1st Nov. 1793 James Little Deput. Recorded the 9th Nov. 1793

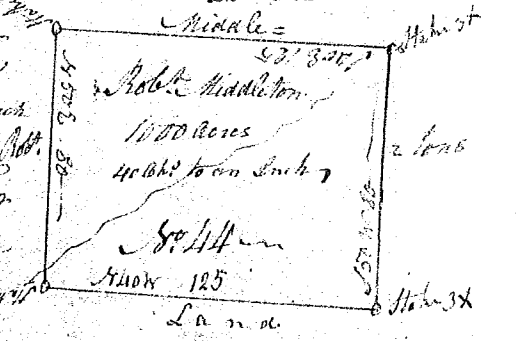

South Carolina Pursuant to a warrant from John Thomas Esq. Com. of Saluda River. Dated the 24th Oct. 1793. I have admeasured & laid out unto Robert Middleton a tract of one thousand acres of land. Situate in Greenville County on a branch of Saluda River. Bounded on all sides by the said Robert Middletons Land & hath such shape & marks as the above plat represents. Certified the 1st Nov. 1793 James Little Deput. Recorded the 9th Nov. 1793

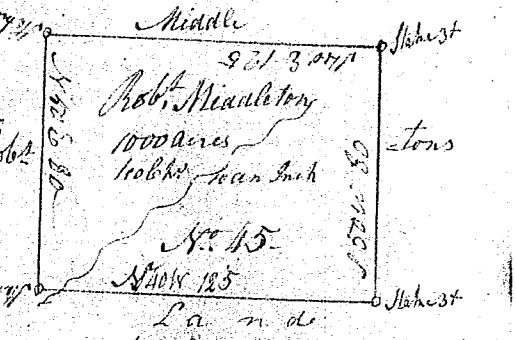

South Carolina Pursuant to a warrant from John Thomas Esq. Com. of Saluda River. Dated the 24th Oct. 1793. I have admeasured & laid out unto Robert Middleton a tract of one thousand acres of land. Situate in Greenville County on a branch of Saluda River. Bounded on all sides by the said Robert Middletons Land & hath such form & marks as the above plat represents. Certified the 1st Nov. 1793 James Little Deput. Recorded the 9th Nov. 1793

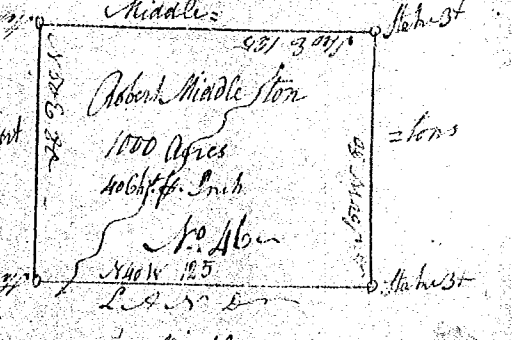

South Carolina Pursuant to a warrant from John Thomas Esq. Com. of Saluda River. Dated the 24th Oct. 1793. I have admeasured & laid out unto Robert Middleton a tract of one thousand acres of land. Situate in Greenville County on a branch of Saluda River. Bounded on all sides by the said Robert Middletons Land & hath such shape & marks as the above plat represents. Certified the 1st Nov. 1793 James Little Deput. Recorded the 9th Nov. 1793

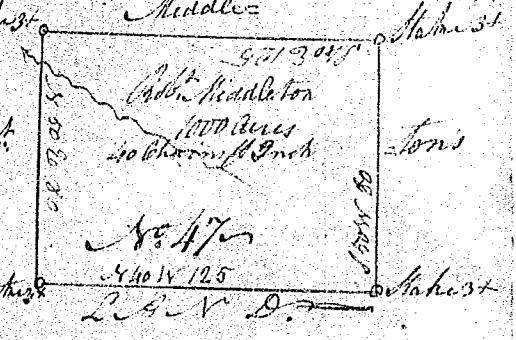

South Carolina Pursuant to a warrant from John Thomas Esq. Com. of Saluda River. Dated the 24th Oct. 1793. I have admeasured & laid out unto Robert Middleton a tract of one thousand acres of land. Situate in Greenville County on a branch of Saluda River. Bounded on all sides by the said Robert Middletons Land & hath such shape & marks as the above plat represents. Certified the 1st Nov. 1793 James Little Deput. Recorded the 9th Nov. 1793

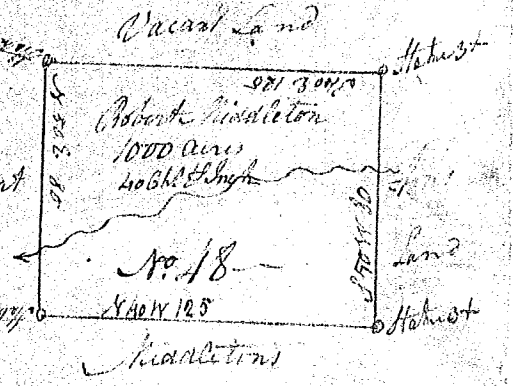

Recorded the 9th Nov. 1793 James Little Deput.