

State of South Carolina Pursuant to a warrant from John Thomas Esq. Commissioner of Locations Dated the 12th July 1785, I have admeasured and laid out unto Philemon Waters a tract of one hundred and fifty five acres of land in Ninety Six District, on the waters of Cannon's Creek, branches of Broad River and hath such shape, Marks, buttings & Boundings as the above Plat Represents, Survey the 16th July 1786 - N^o 17 April 1786. Recorded 17th April 1786, - P. Phil^l Waters Esq.

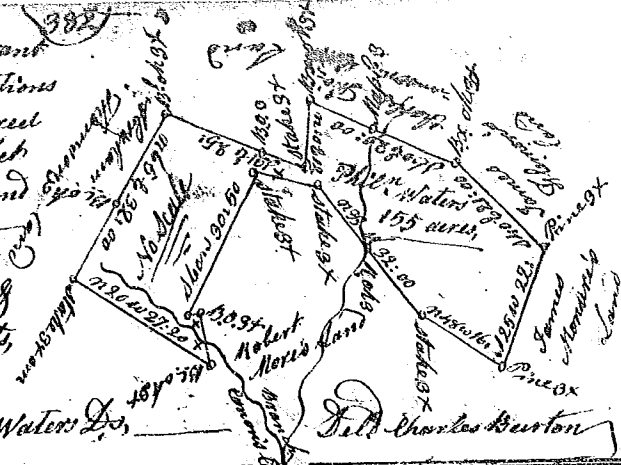

State of South Carolina Pursuant to a warrant from John Thomas, Commissioner of Locations, I have admeasured and laid out unto Thomas Wadsworth, William Surpin & John Meurs, a tract of thirty four acres of Land, situate in Ninety Six District, below the ancient boundary line, on the waters of Second Creek a branch of Broad River, and hath such shape, Marks, buttings and boundings as the above plat Represents, Survey 10th March 1786, James Dougharty Esq. Recorded 19th April 1786,



State of South Carolina Pursuant to a warrant from John Thomas Esq. Commissioner of Locations, N^o of saluda to me Directed, I have admeasured and laid out unto William Gilkey a tract of one hundred and thirty acres of land, in Ninety Six District, on the branches of Gilkey's Creek a fork of Sheehy's, branch of Broad River, bounded S^o by Henry's, South, E^o by Isaac Chapman & Jonathan Gilkey, and hath such shape form and Marks as the above Plat Represents, Survey the 20th febr^y 1786 Esq. Vardry M^osee Esq. Recorded 20th April 1786,

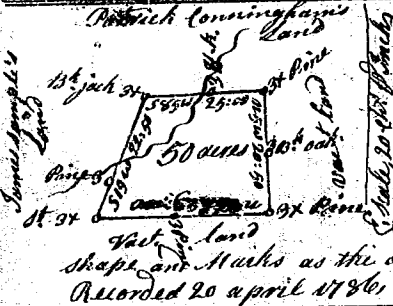
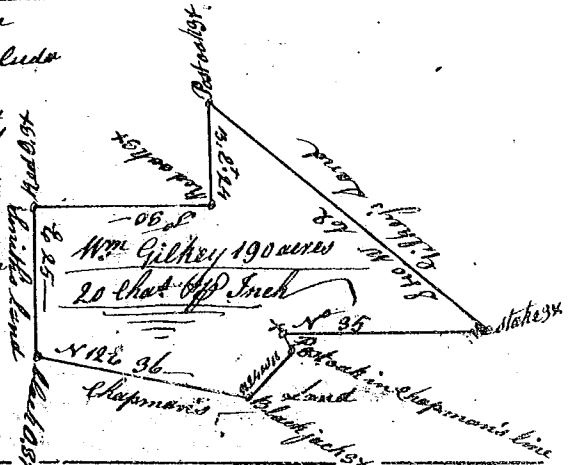

State of South Carolina Pursuant to a warrant from John Thomas Esq. Commissioner of Locations for the north side of Saluda River in 96 district Dated 27th Dec^r 1785, I have admeasured and laid out unto James Sample a tract of fifty acres of land, it being of said warrant, which tract of land is situate on the waters of Goldmans Creek, waters of the N^o side of Saluda River in 96 District, butting and bounding as above, and hath such shape and Marks as the above Plat Represents, Certified 30th Dec^r 1786, P. Cunningham Esq.

State of South Carolina

Pursuant to a warrant from John Thomas Esquire Commissioner of Locations N^o of Saluda to me Directed I have admeasured and laid out unto Joseph Morris a tract of one hundred and fifty three acres of Land situate the aforesaid State on the waters of Bush Creek on the south side of Parolote River bounded west by Land laid out to John Reuoniel Vall at the side by N^o 17 Lane & hath such shape form & marks as the above Plat Represents

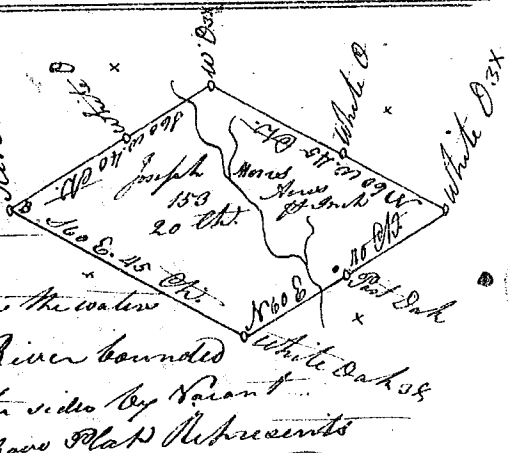

Vardry M^osee Esq.

Surveyed the 10 Day of January 1786
Recorded the 21st of April 1786