

State of South Carolina Pursuant to a warrant from John Thomas Esq. Commissioner of locations North of Saluda River I have admeasured and laid out unto Arthur Bennett a tract of two hundred acres of land, on the county, situate in Ninety Six district on a branch of Needy River, Having such Marks, buttings & boundings as the above Plat represents, Survey, the 3rd Oct. 1785, Recorded 17th Nov. 1785, by Robt. Prince D^y, Del. R. Prince

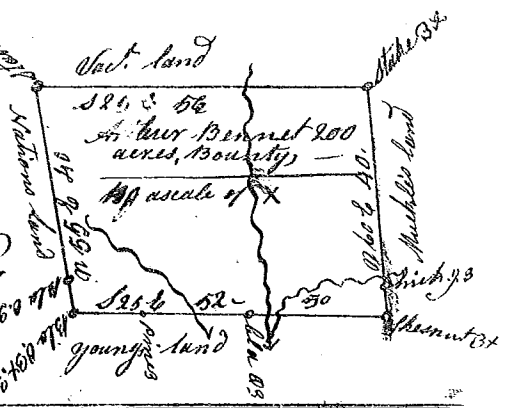

South Carolina Pursuant to a warrant from John Thomas Esq. Commissioner of locations & side Saluda I have admeasured and laid out unto Silvester Springer a tract of two hundred acres of land on the county, situate in Ninety Six District, on the waters of Needy River, and hath such buttings and boundings, and other shape and marks, as the above Plat represents, Survey, 17th Nov. 1785, Recorded 17th Nov. 1785, by Robt. Prince D^y, Del. R. Prince

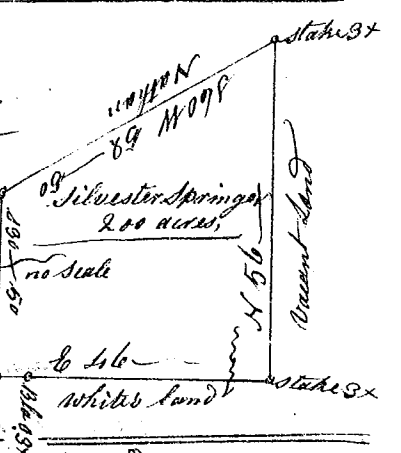

State of South Carolina Pursuant to a warrant from John Thomas Esq. Commissioner of locations Dated 16th August 1785, I have admeasured and laid out unto William M. Dozel a tract of land containing two hundred acres situate in Ninety Six District, East of the ancient boundary line in Lawson's forke of Pacolite river, and hath such shape, Marks, buttings and boundings as the above Plat represents, Survey, 16 Sept. 1785, Recorded 17th Nov. 1785, by Wm. Benson D^y

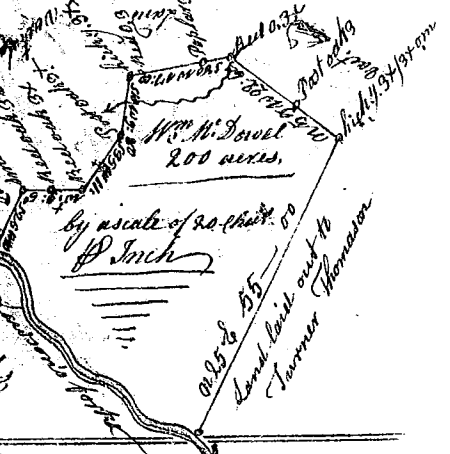

State of South Carolina Pursuant to a warrant from John Thomas Esq. Commissioner of locations & side Saluda River, Dated 17th Oct. 1785, I have admeasured and laid out unto John Hall a tract of land containing three hundred and eighty five acres, situate in Lawrence County, below the ancient boundary line on Saluda River, bounding S.E. on William News Land, all other sides by Vacant Land, and hath such form and marks as the above Plat represents, Survey, 26 Oct. 1785, Adam C. Jones D^y, Del. James Cox

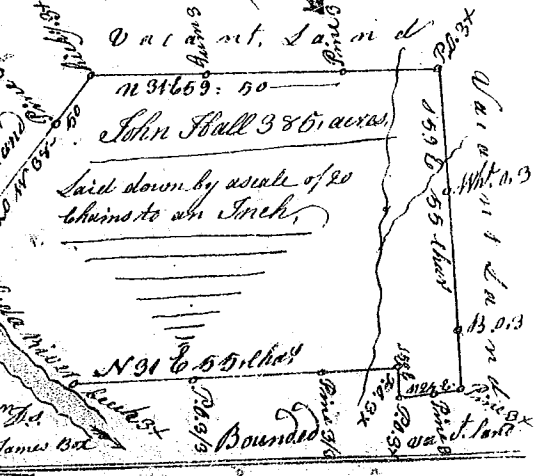

State of S^c Carolina Pursuant to a warrant from John Thomas Commissioner of locations, N^o of Saluda, I have admeasured and laid out unto Richard Lewis a tract of eighty eight acres of land, on Towns of North Upper in 96th District, and hath such buttings & boundings and other shape and marks as the above Plat represents, Survey, the 15 Sept. 1785, Recorded the 17th Nov. 1785, by Robt. Prince D^y

