

State of South Carolina

(305)

Pursuant to a warrant from John Thomas Esq. Commissioner of Locations Dated the 26th Day of October 1785, I have admeasured and laid out unto Samuel Earle, a tract of eight hundred and twenty acres of land, situate in ninety six District on both sides of French Broad River, including Indian old fields on both sides said River, and hath such shape marks, buttings and boundings as the above Plat represents, Survey'd the 4th Novr 1785,

by Joseph Whitmer Esq.
Recorded 16th Novr 1785,

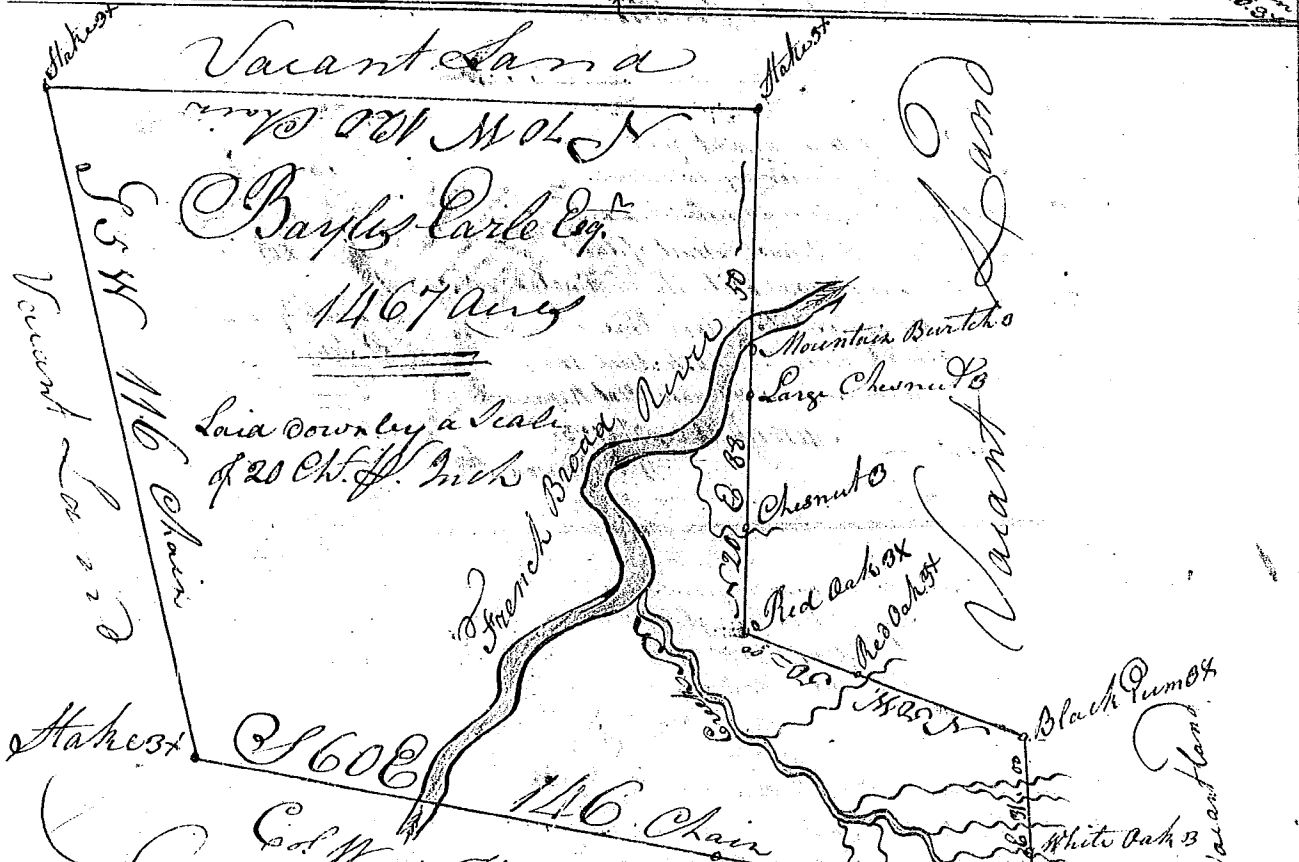
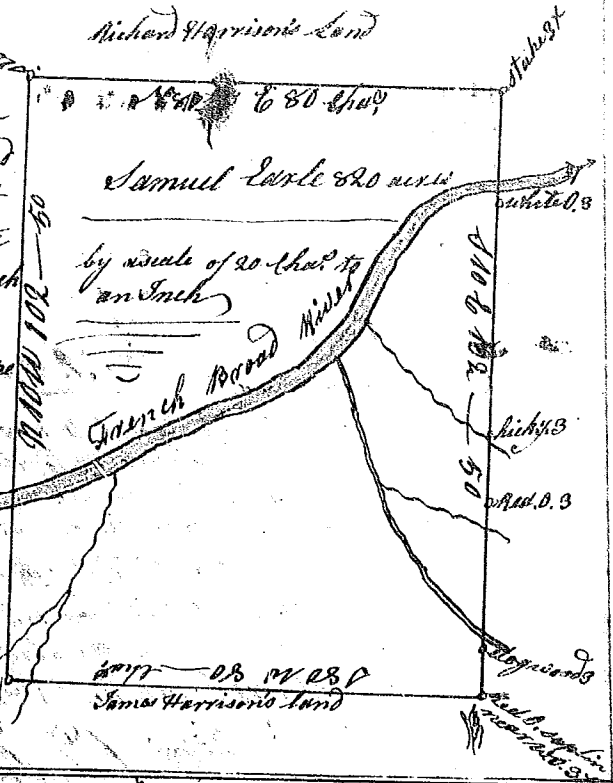

State of South Carolina

Pursuant to a warrant from John Thomas Esq. Commr. of Locations Dated the 26th Novr 1785, I have admeasured & laid out unto Baylis Earle Esq. a tract of one thousand four hundred & sixty seven acres of Land situate in 96 District on both sides of French Broad River, & hath such shape of marks buttings & boundings as the above plat represents.

Survey'd the 4th November 1785 by Joseph Whitmer Esq.
Recorded this 16th Novr 1785 Sicut Peter Dempster