

State of South Carolina
 Pursuant to warrant from John Thomas Esq. Commissioner of Location dated 9th of April 1784. I have admeasured and laid out unto Edmund Larwood a Plantation or Tract of Land containing 600 Acres Situated in Ninety Six Dis. Below the ancient Boundary on a Branch of Little River call'd Bearwood Creek Bound. - vizg N. E. by Iron Pottery Swales Richd Howland Alfred Goodes Land NW & W on Neal Hamilton Daniel Oxburns and the Widow Harvey, and on all other sides on Old Land. That such White Cornmarks as the above plat represents Survey'd this 11th Oct. 1784 by Thomas Dodson Esq. Surveyor
 Recorded this 11th Day of Jan'y 1785

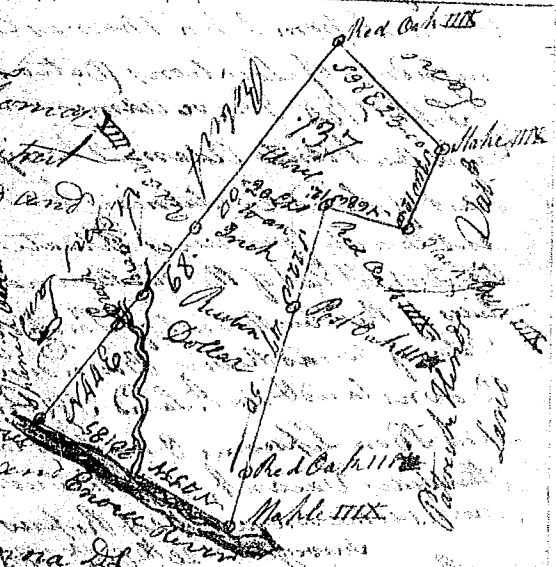

State of South Carolina
 Pursuant to warrant from John Thomas Esq. Commissioner of Location on 9th of April 1784. I have admeasured and laid out unto Reuben Dolar a Tract of Land containing one hundred & thirty seven acres on the N. Side of Enore River Below the ancient Boundary. Boundary N. E. on Robert Dolar NW & W on Patrick Dolar & N. W. by Enore River all other sides Vacant & that such White Cornmarks as the above plat represents Survey'd this 24th Oct. 1784 by Robert Thomas Esq. Surveyor
 Recorded this 12th January 1785



State of South Carolina
 Pursuant to warrant from John Thomas Esq. Commissioner of Location on 9th of April 1784. I have admeasured and laid out unto John Shep a Tract of Land containing 590 Acres Situated on 96th Street East of the old Boundary on the N. Side of Pacolet River. Boundaries S. on Pacolet River S. on Shep's Land all other sides Vacant & that such White Cornmarks as the above plat represents Survey'd this 19th Oct. 1784
 Recorded this 14th Jan'y 1785

