

State of South Carolina,

1807

Pursuant to a warrant from John Thomas Esq. Commissioner of Locations Dated 22 of May 1784 I have admeasured and laid out unto Thomas A. Stander a tract of Land containing Two hundred acres, Situate in Ninety Six District of the North Side of Saluda River west of the old Indian Boundary line about two miles above the upper Indian Path bounding S on Saluda River all other Sides on Vacant Lands and hath form and Marks as the annexed Plat represents.

Surveyed the 9th day of June 1784
George Salmon D.S.
Recorded the 24th day of August 1784

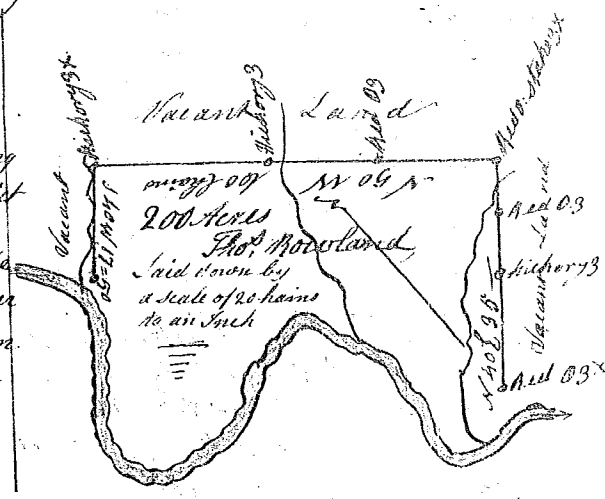

State of South Carolina.

Pursuant to a warrant from John Thomas Esq. Commissioner of Locations Dated the 9 day of August 1784 I have admeasured and laid out unto Henry Metcher a tract of Land containing Three hundred Acres situate in Ninety Six District East of the old Boundary on the South Side of Pacolale River and on both Sides of Sawton's Fork of said River including the Healing Spring bounding on the N.E. on Pacolale River all other Sides on Vacant Land and hath such form and Marks as the above Plat represents.

Surveyed the 9th day of Aug. 1784
George Salmon D.S.
Recorded the 28th day of August 1784

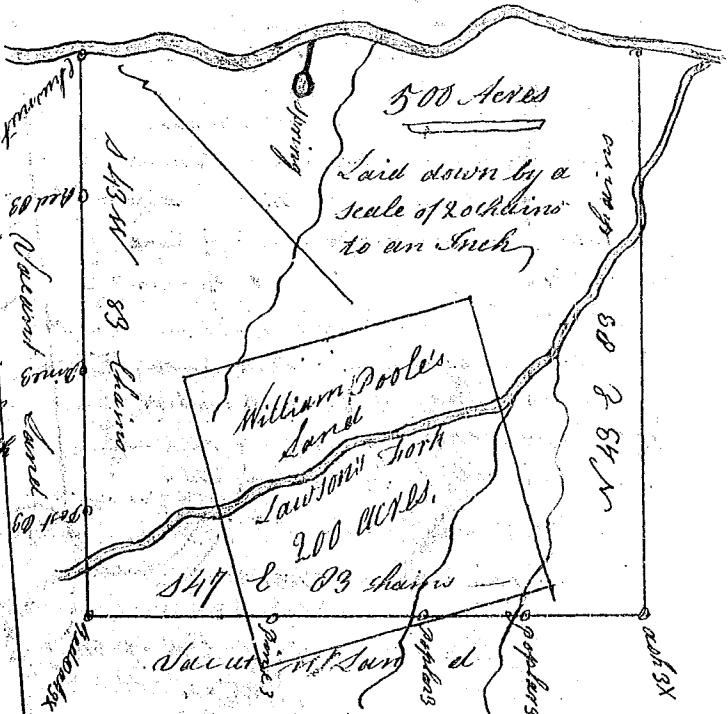

South Carolina.

Pursuant to a precept from John Thomas Esq. officer of Location dated 21 July 1784 I have admeasured and laid out unto William Wright a tract of Land containing two hundred acres Situate in Ninety Six District on the North Side of Saluda River on the upper Fish dam Creek on the South Side of Broad River bounded on all Sides on Vacant Land and hath such shape form and Marks as the annexed plat represents.

Surveyed the 10th Day of August 1784
David Hopkins D.S.
Recorded the 28th day Aug. 1784

