

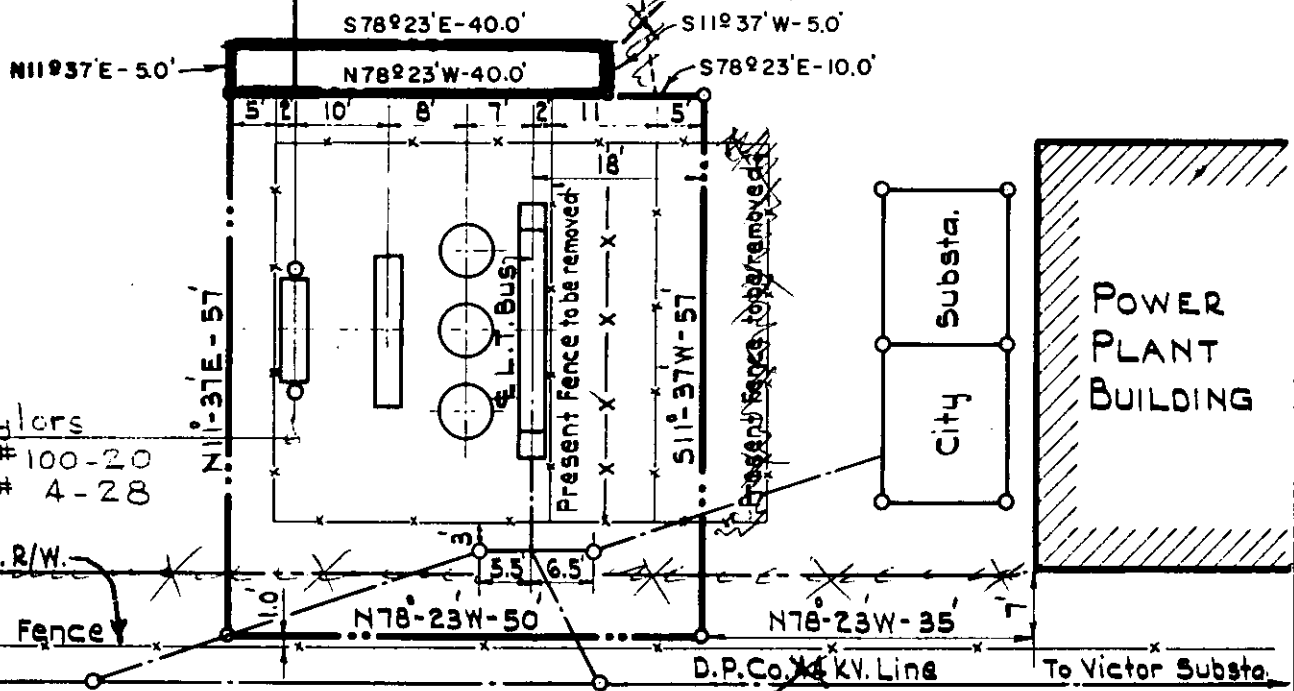

New Location  
4.4 KV. Line to Saxon Ref: Dwg. # B-15-e  
Dec 22

~~Present 4.4 KV. Line  
To be removed and  
relocated to  
New Location~~

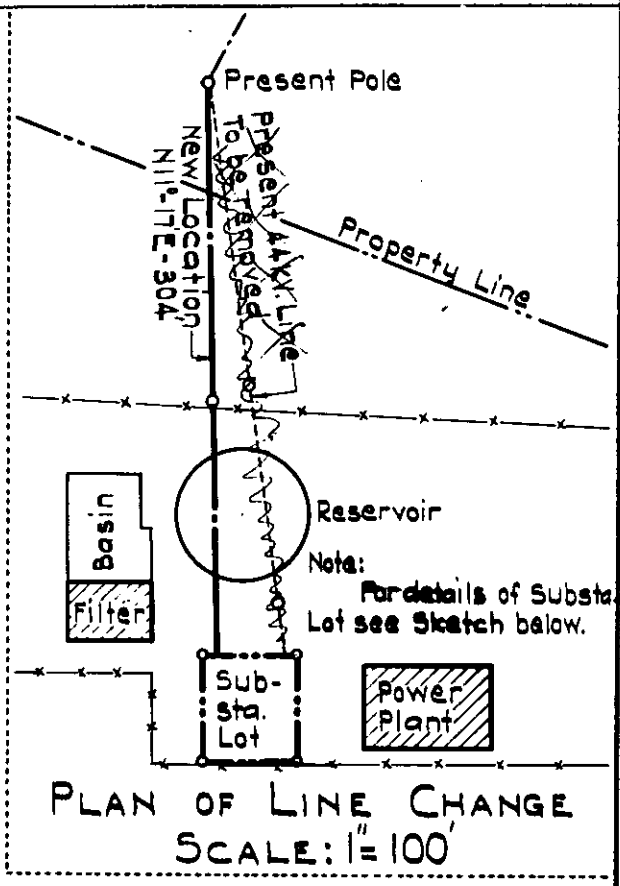

DUKE POWER COMPANY  
RELOCATION OF  
SUBSTATION LOT  
AND  
TRANSMISSION LINE  
CITY OF GREER  
GREER, S.C.

NOTE:  
SUBSTATION LOT REVISED  
4-16-62

SCALES: NOTED MARCH 26, 1945  
BOOK NO. 228 BOOK FILE NO. 1-13

Recorded July 12, 1962 at 9:30 A. M. #1464