

APPROXIMATE LOCATION OF 100 YEAR FLOODLINE AS SCALED FROM F.I.R.M. # 45045C05110 DATED 12/2/04.

GEORGE L & VIOLA G. MASH
N/E
T.M.# 562-1-1-35.00
D.B. # 1498-136
664.75(1E)

DIMINIUMUS PUD OWNERSHIP LEGEND

A. FEE SIMPLE OWNERSHIP - LOTS ARE INDIVIDUALLY OWNED

B. LIMITED COMMON OWNERSHIP - EQUALLY OWNED BY THE INDIVIDUAL LOT OWNERS

C. COMMON OWNERSHIP - HOMEOWNERS ASSOCIATION WITH LAND TRUST GROUP, BOUND BY A CONSERVATION AGREEMENT

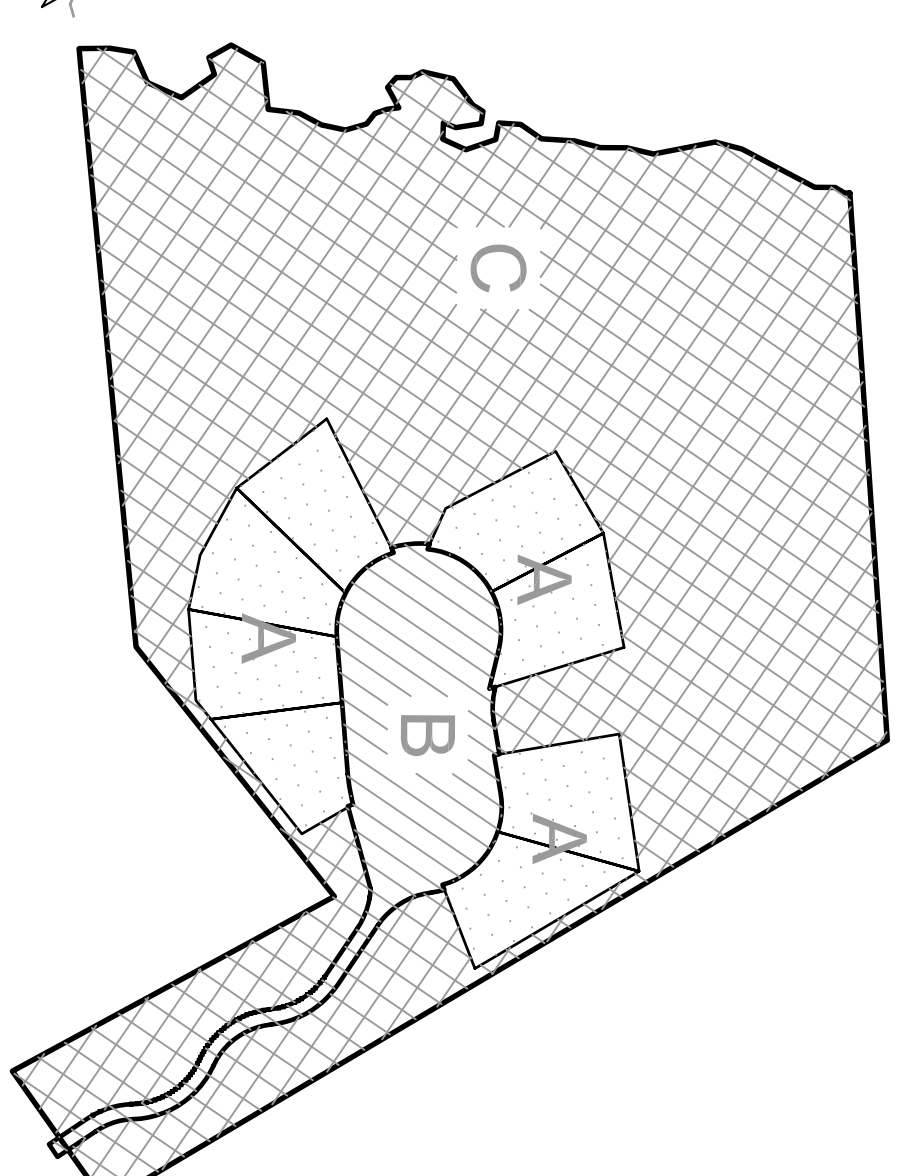

NOTES:

PROPOSED ENTRANCE DRIVE AND LOOP DRIVE WILL BE LIMITED COMMON PROPERTY AND OWNED EQUALLY BY INDIVIDUAL LOT OWNERS. SEE DIMINIUMUS PUD LEGEND.

PRESENTLY ZONED R-S

TOPOGRAPHIC INFORMATION TAKEN FROM COUNTY GIS DATA.

SURVEY FOR ERIC C. WEIR, DATED 12-1-05, PROVIDED BY SITE DESIGN, INC.

POWER TO BE PROVIDED BY DUKE POWER.

TELEPHONE TO BE PROVIDED BY BELL SOUTH.

WATER TO BE PROVIDED BY LAURENS COUNTY WATER AND SEWER. A UTILITY EASEMENT WILL BE PROVIDED ALONG ENTRANCE DRIVE FOR WATER MAIN.

ON-SITE WASTEWATER SYSTEMS TO BE APPROVED BY SOHREC.

STORMWATER MANAGEMENT AND SEDIMENT REDUCTION PLAN WILL BE PREPARED FOR THIS PROPERTY AND WILL BE APPLIED FOR LAND DISTURBING ACTIVITIES. EACH PROPERTY OWNER WILL COMPLY WITH THIS PLAN UNLESS AN INDIVIDUAL PLAN IS PREPARED AND APPROVED FOR THAT PROPERTY.

FINAL PLAT WILL INDICATE FINAL DRAINAGE AND UTILITY EASEMENTS.

TEMPORARY AND PERMANENT STORM WATER AND EROSION CONTROL MEASURES TO BE APPROVED BY COUNTY ENGINEER.

EXISTING VEGETATION IN COMMON AREAS TO REMAIN EXCEPT AS NEEDED FOR UTILITY PLACEMENT.

ALL LOTS ARE A MINIMUM OF 40,000 SQUARE FEET.

SHARED DRIVEWAY WILL MEET REQUIREMENTS OF THE FOUNTAIN INN FIRE SERVICE DISTRICT. DRIVES ARE SHOWN WITH A MINIMUM RADIUS OF 125 FEET.

TAX MAP NUMBER IS 0562010104000

ENTRANCE DRIVE IS 16' WIDE WITH 2 GRAVEL SHOULDER ON EACH SIDE. DRIVE CONSISTS OF 6' BASE AND 2" ALL-WEATHER SURFACE.

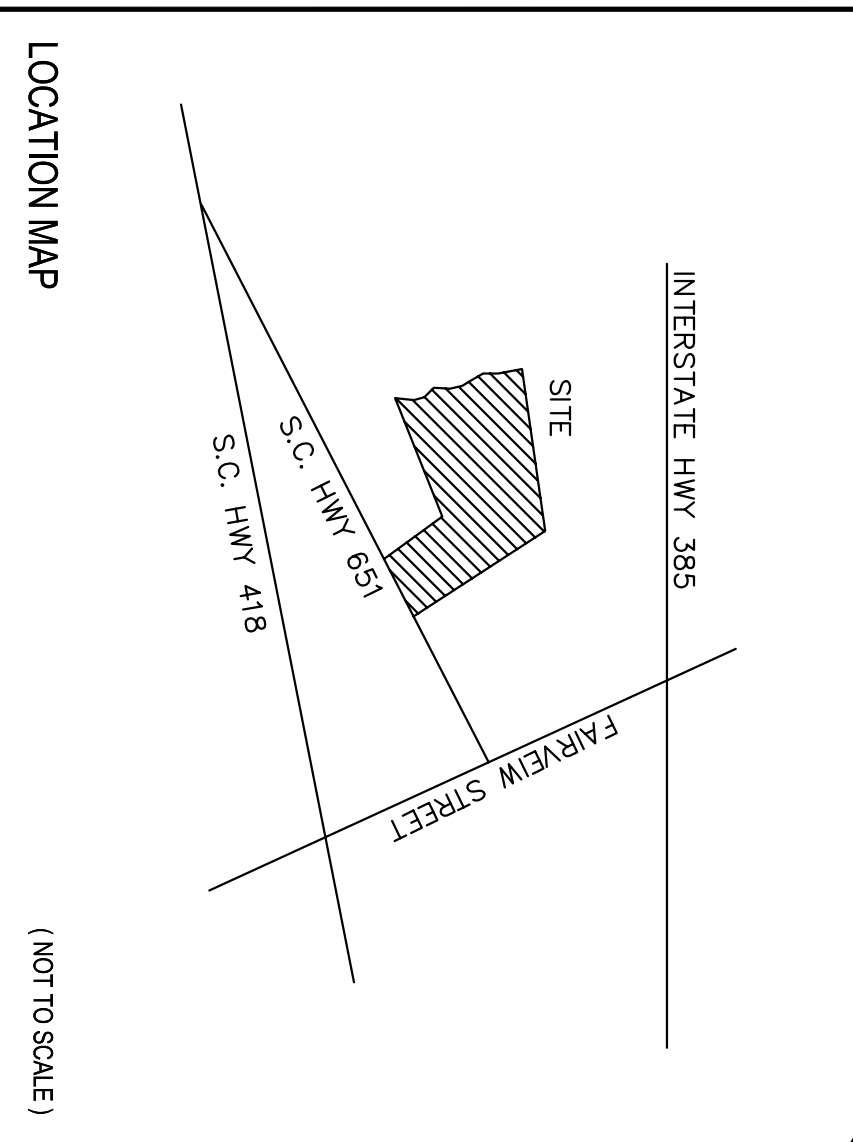

REVISIONS

NO.	DATE	DESCRIPTION	BY
A	FEB. 1, 2006	ISSUED FOR REVIEW	BRS

PRELIMINARY PLAN

WEIR PROPERTY

OWNER ERIC C. WEIR
ENGINEER ARBOR ENGINEERING, INC.

NO. OF ACRES: 47.87
MILEAGE NEARROAD: N/A
NO. OF LOTS: 8

Arbor Engineering, Inc.
LANDSCAPE ARCHITECTS - CIVIL ENGINEERS - LAND SURVEYORS
RECREATIONAL PLANNERS - LAND PLANNERS

Box 263 Greenville, S.C. 29602
Telephone: (864) 235-3589
Fax: (864) 233-6274
Email: psimms@arborengineering.com

PROJECT: BRS
DESIGNER: BRS
APPROVER: JDM
DATE: 02-01-06
FILE: 06005-PL1.DWG
DRAWING NO.: 06005.02