

TOTAL AREA  
1,566,841 SQ.FT.  
35.97 ACRES  
AREA WITHIN FLOOD PLANE  
148,688 SQ.FT.  
3.41 ACRES  
NET USABLE AREA  
1,418,173 SQ.FT.  
32.56 ACRES  
(INCLUDES ANY AND ALL RIGHTS OF WAY)

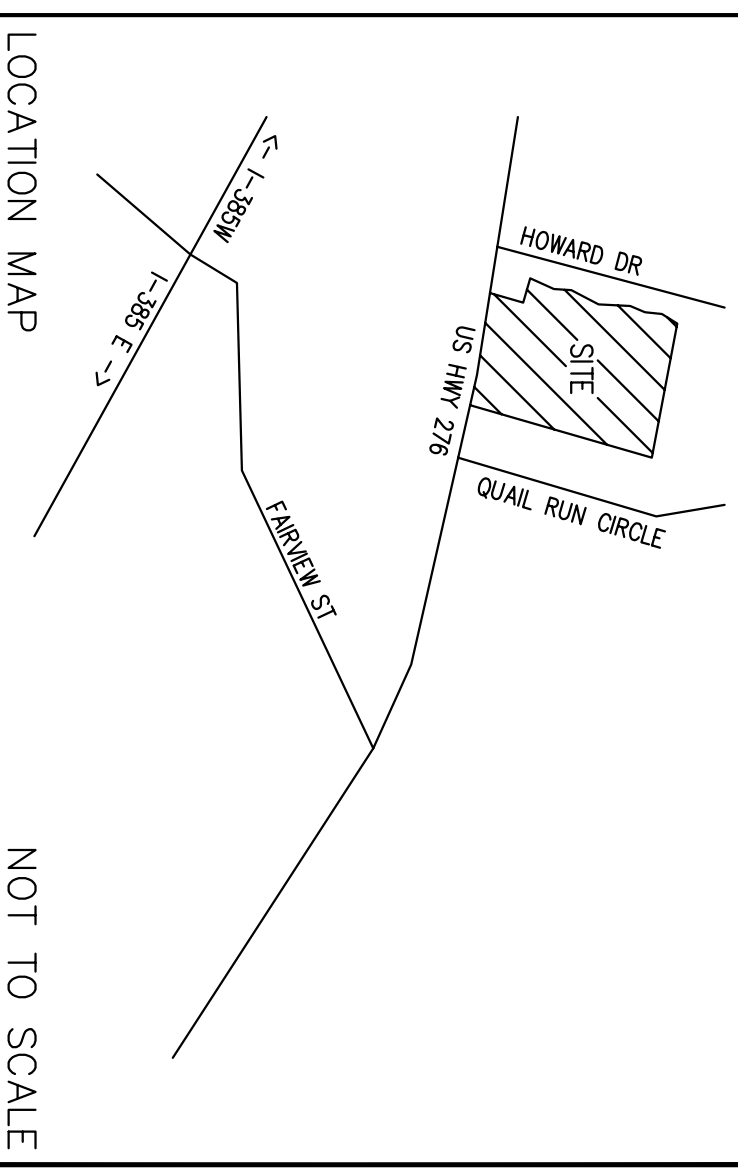

LOCATION MAP  
NOT TO SCALE

CERTIFICATE OF ACCURACY  
I HEREBY STATE THAT TO THE BEST OF MY KNOWLEDGE, INFORMATION, AND BELIEF, THE SURVEY SHOWN HEREON WAS MADE IN ACCORDANCE WITH THE REQUIREMENTS OF THE CONSTITUTION AND LAWS OF THE STATE OF SOUTH CAROLINA, AND MEETS OR EXCEEDS THE REQUIREMENTS FOR A CLASS "B" SURVEY AS SPECIFIED THEREIN.  
DATE \_\_\_\_\_ T.A. SHERARD, P.E., R.L.S.  
S.C. REGISTRATION NO. 12314

CERTIFICATE OF OWNERSHIP AND DEDICATION  
THE UNDERSIGNED HEREBY ACKNOWLEDGE THAT I AM (WE ARE) THE OWNER(S) OF THE PROPERTY SHOWN AND DESCRIBED HEREON AND THAT I (WE) HEREBY AGREE THAT THIS PLAN COMPLETES THE SURVEY AND DEDICATES TO THE PUBLIC USE AS ROADS, STREETS, MINIMUM BUILDING RESTRICTION LINES AND HEREBY DEDICATE TO PUBLIC USE AS ROADS, STREETS, AND EASEMENTS, FOREVER ALL AREAS SO SHOWN OR INDICATED ON SAID PLAN.  
DATE \_\_\_\_\_ SIGNED \_\_\_\_\_  
DATE \_\_\_\_\_ SIGNED \_\_\_\_\_  
DATE \_\_\_\_\_ SIGNED \_\_\_\_\_

CERTIFICATE OF APPROVAL FOR RECORDING  
I HEREBY CERTIFY THAT THE SUBMISSION PLAN SHOWN HEREON HAS BEEN FOUND TO COMPLY WITH THE REQUIREMENTS FOR RECORDING AS SET FORTH IN THE CONSTITUTION AND LAWS OF THE STATE OF SOUTH CAROLINA, AND THAT IT HAS BEEN APPROVED FOR RECORDING IN THE OFFICE OF THE COUNTY CLERK.  
DATE \_\_\_\_\_ AUTHORIZED REPRESENTATIVE \_\_\_\_\_  
COUNTY PLANNING COMMISSION

**VILLAGE AT FOUNTAIN INN**  
ENGINEER/SURVEYOR  
**SDI** SITE DESIGN, INC.  
420 E. Park Avenue, Suite 100  
Greenville, SC 29601  
www.sitedesign-inc.com  
OWNER  
FOUNTAIN INN PARTNERS, LLC  
PO BOX 1458  
GREER, SC 29652

NO. OF ACRES: 35.97 MILES OF NEW ROAD: 0.057  
NO. OF LOTS: 2 DATE: 09-02-2009  
CURRENT ZONING: PD  
TAX MAP: 34.1-1-5  
SCALE: 1" = 100'  
100 0 100 200