

PRELIMINARY PLAT: DECEMBER 2008

SUBDIVISION NAME: WALNUT RIDGE (CLUSTER)

FILE: 08-195

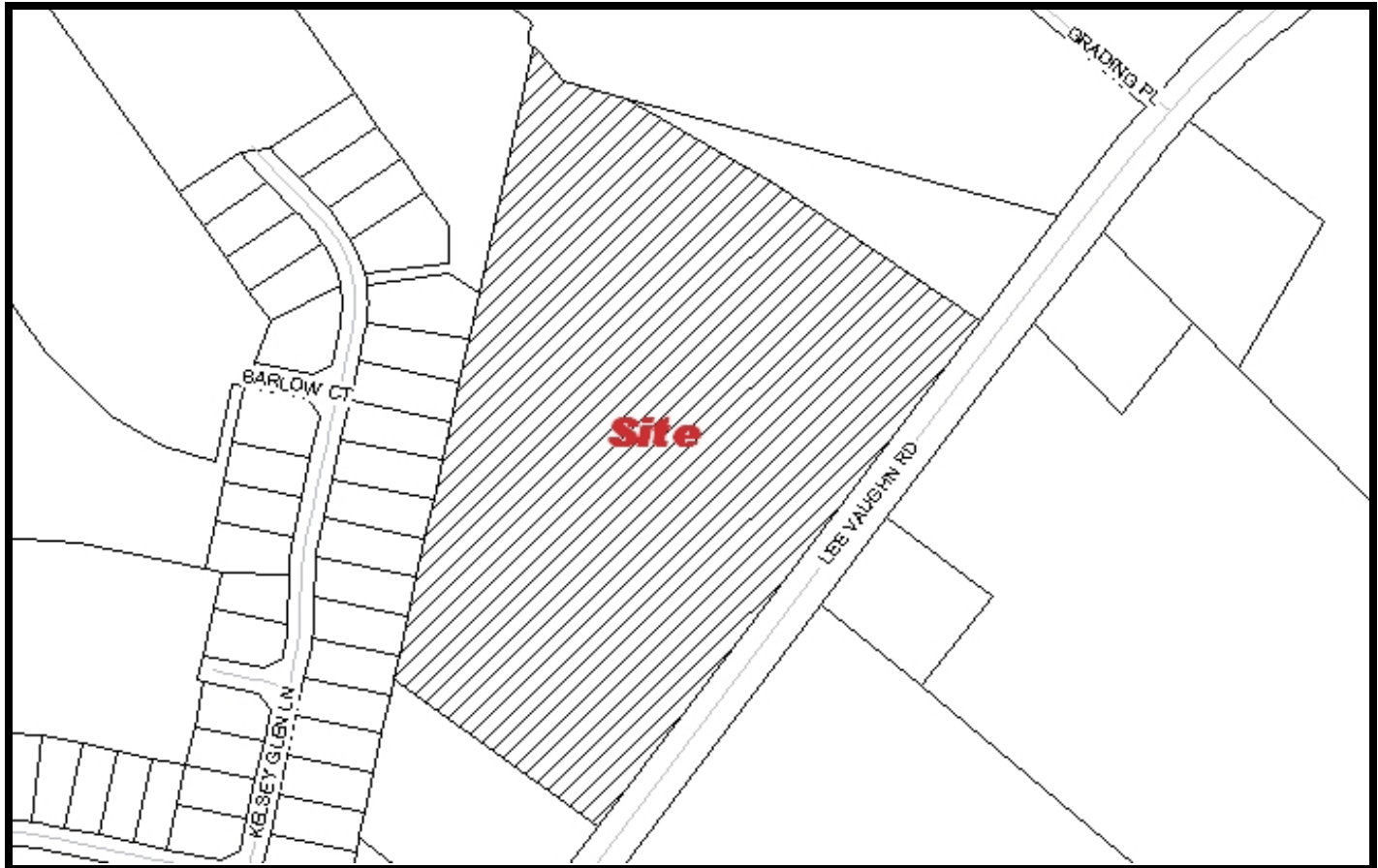

Developer: Doug Snipes
D.C. Snipes Company

Engineer/Surveyor: Chuck Reichert, P.E.
FRF, Inc.

Address: Post Office Box 26713
Greenville, SC 29616

Address: 725 Lowndes Hill Road

Telephone Number: (864) 288-7772

Telephone Number: (864) 271-8633

Block Book Number: 554.1-1-13

Acres: 16.7 Acres

Zoning: R-15 Cluster

Acres Saved: 3.3 Acres

Existing Access: Lee Vaughn Road

Tree Credits: 584.2

Planning Area: Enoree

Lots: 44

Extension of An Existing Development: No

Streets: 0.3 Miles (Public)

Proposed Sewer: Public

Fire District: Clear Springs

Sewer District: Metropolitan

County Council District: 27 (Kirven)

Proposed Water Source: GWS

Census Tract: 30.03

TAZ: 326

Variance: No