

STREET NAME	'A'	'B'	'D'
PRIVATE UNPAVED DRIVE	20'	10.0'	35'

CUL-DE-SAC DETAIL

- NOTES:
- ZONED: UNZONED
 - BOUNDARY TAKEN FROM SURVEY DONE BY IGNAIO A. ROMO, SCPLS 12250 ON 07-01-08 FOR NEIL DAVIS
 - TOPOGRAPHICAL INFORMATION TAKEN FROM GREENVILLE COUNTY GIS.
- 1.) PT OF TMS# 0640.03-01-008.03
- 2.) THERE IS A S DRAINAGE AND UTILITIES EASEMENT EACH SIDE OF ALL INTERIOR LOT LINES AND TO DRAINAGE AND AND UTILITIES EASEMENT INSIDE OF EXTERIOR LOT LINES.

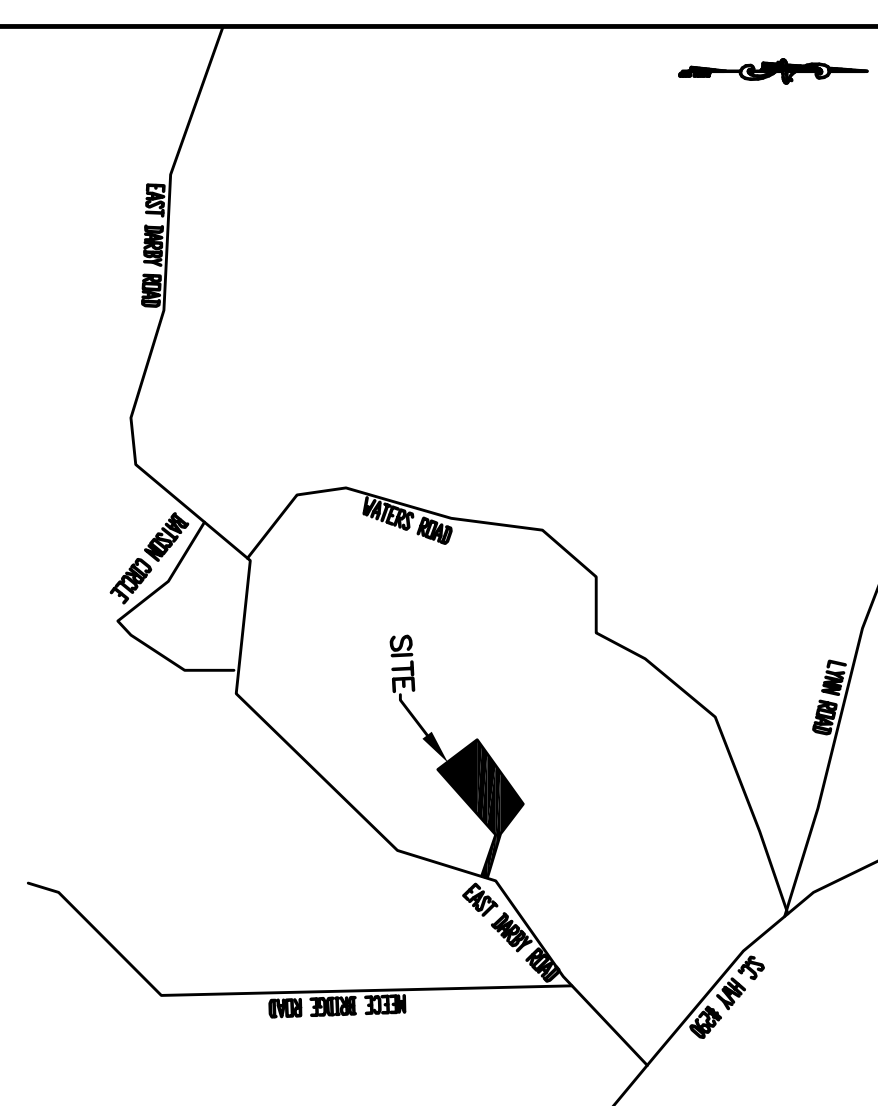

VICINITY MAP
N.T.S.

PRELIMINARY PLAN
SOUTHERN HILLS PLANTATION

NEIL DAVIS
511 E. DARBY ROAD
TAYLORS SC 29687
(864) 320-0053

LAND DESIGN SERVICES, INC.
P.O. BOX 432
EASLEY, SC 29641
PHONE: (864) 220-7051
ENGINEER

No. ACRES: 7.72
MILES OF COUNTY ROAD: 0.00

No. LOTS: 8
DATE: 8-5-08

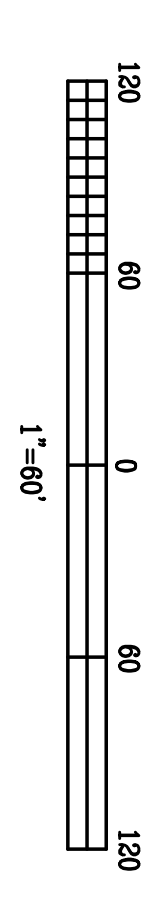

No.	DATE	REVISIONS	BY

Land Design Services, Inc.
Civil Engineering, Land Planning & Consulting
P.O. Box 432 Easley, S.C. 29641 (864) 220-7051
DRAWN BY: KR PROJECT NO: L-08-060