

PRELIMINARY PLAT: AUGUST 2008 WITHDRAWAL BY APPLICANT

AUGUST 19, 2008

SUBDIVISION NAME: SALUDA POINTE (CLUSTER)

FILE: 08-170

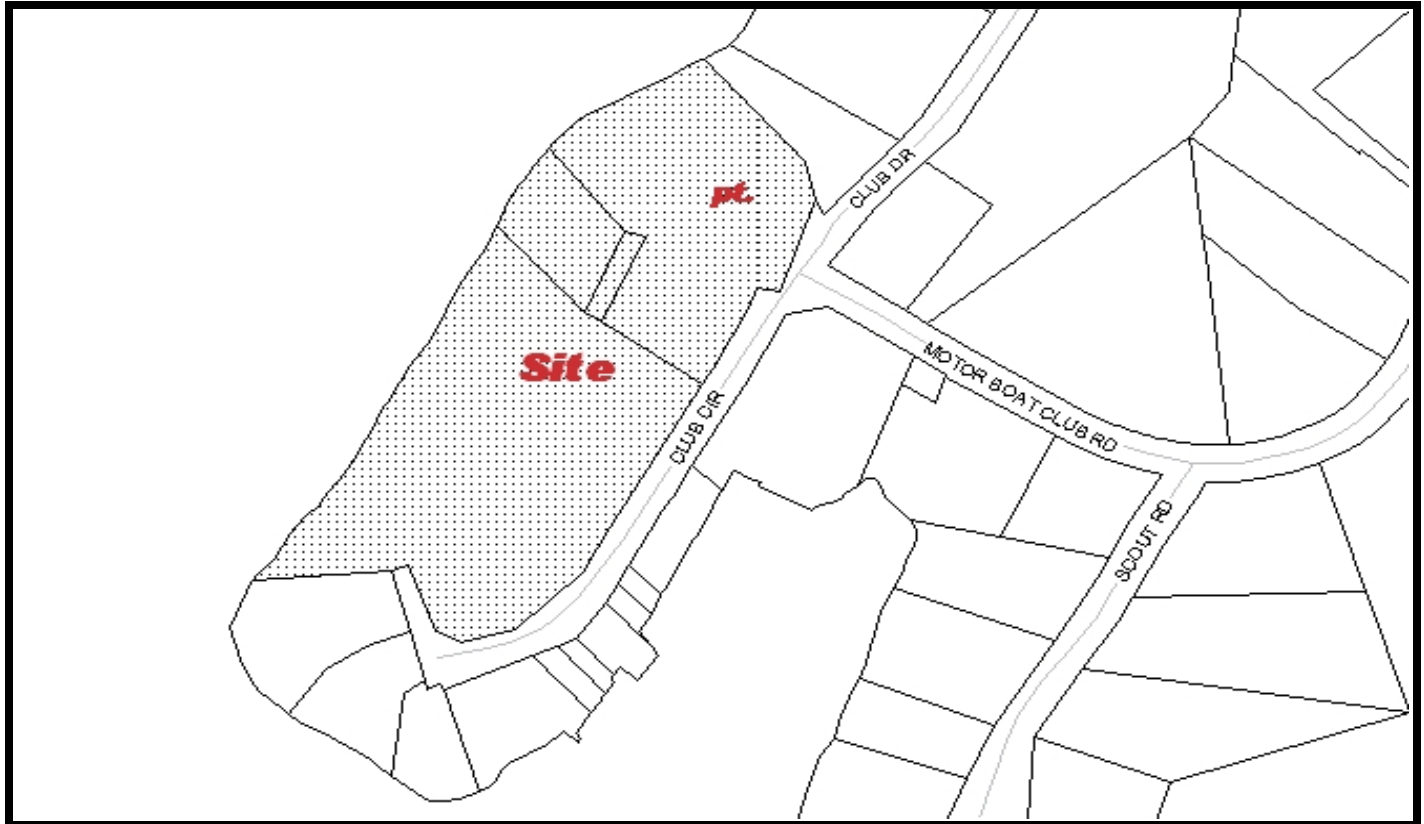

**Developer:** Donna McAbee

**Engineer/Surveyor:** Kevin Tumblin  
Freeland & Associates

**Address:** 600 Motor Boad Club Road  
Greenville, SC 29611

**Address:** 323 West Stone Avenue  
Greenville, SC 29609

**Telephone Number:** (864) 561-4781

**Telephone Number:** (864) 271-4924

**Block Book Number:** B4.4-1-64, 65 pt, 67 & 143

**Acres:** 3.21

**Zoning:** R-12 (Cluster)

**Acres Saved:** 0.49

**Existing Access:** Club Circle Drive

**Tree Credits:** Will Plant new Trees

**Planning Area:** Berea

**Lots:** 11

**Extension of An Existing Development:** No

**Streets:** 0.06 Miles (Public)

**Proposed Sewer:** Public

**Fire District:** Berea

**Sewer District:** Berea

**County Council District:** 26 (Gilstrap)

**Proposed Water Source:** GWS

**Census Tract:** 37.01

**TAZ:** 286

**Variance:** No