

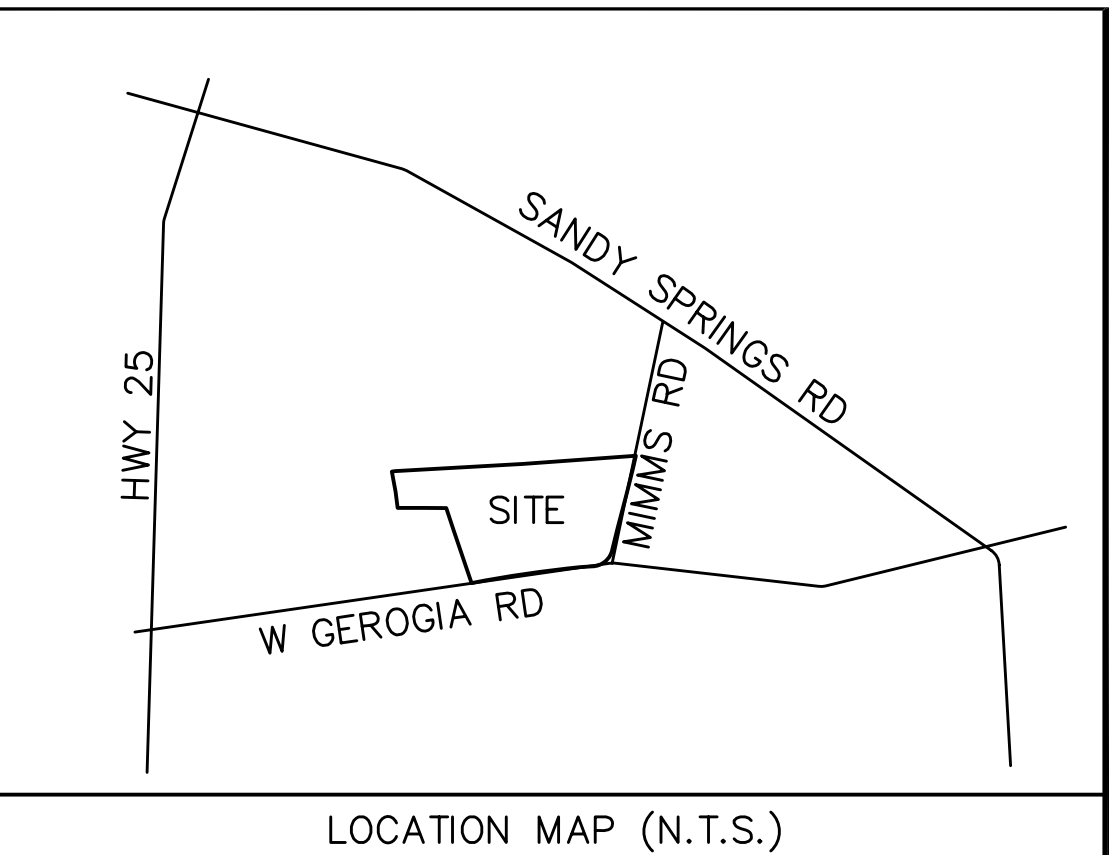

- GREENVILLE COUNTY GENERAL NOTES**
1. ALL NEW LOTS TO HAVE INTERNAL ACCESS ONLY.
  2. ALL NEW ROADS WILL HAVE A 44' R/W.
  3. THERE IS A 5' DRAINAGE AND UTILITY EASEMENT ALONG EACH SIDE OF ALL INTERIOR LOT LINES AND A 10' DRAINAGE AND UTILITY EASEMENT INSIDE ALL EXTERIOR LOT LINES, EXCEPT WHERE NOTED.
  4. A STORMWATER MANAGEMENT PLAN AND SEDIMENT REDUCTION PLAN HAS BEEN PREPARED FOR THIS PROPERTY AND WILL BE APPLIED FOR LAND DISTURBING ACTIVITIES. EACH PROPERTY OWNER WILL COMPLY WITH THIS PLAN UNLESS AN INDIVIDUAL PLAN IS PREPARED AND APPROVED FOR THAT PROPERTY. GREENVILLE COUNTY IS NOT RESPONSIBLE FOR THE MAINTENANCE OF THE DETENTION AREA.
- SETBACKS:**
1. THERE IS AN ASSUMED 50' SETBACK ALONG W. GEORGIA RD
  2. THERE IS AN ASSUMED 30' SETBACK ALONG MIMMS RD
  3. THERE IS A 30' FRONT SETBACK ALONG ALL NEW INTERNAL ROADS.
  4. THERE ARE 5' SIDE AND REAR SETBACKS



NO.	DATE	BY	REVISION

**GRAY ENGINEERING CONSULTANTS, INC.**  
*engineering · sitework · land planning*

132 PILGRIM ROAD · GREENVILLE, SC 29607  
 P/E (864) 297-3027 · F.A.X. (864) 297-5187  
 GRAY @ GRAYENGINEERING.COM

THIS DRAWING AND ASSOCIATED CAD FILES ARE AN INSTRUMENT OF SERVICE. THEY ARE TO BE USED ONLY FOR THE PROJECT AND SITE SHOWN AND SHALL NOT BE REPRODUCED OR USED IN ANY MANNER WITHOUT THE WRITTEN AUTHORIZATION OF GRAY ENGINEERING CONSULTANTS, INC. IN WRITING.

PRELIMINARY PLAT

**DESTINY ACRES**

WEST GEORGIA ROAD  
 GREENVILLE COUNTY, SC

**DESTINY ACRES**

TYPE OF DEVELOPMENT: RR-1

**OWNER**  
 DOUGLAS JOHNSON ENTERPRISES  
 PO BOX 80741  
 SIMPSONVILLE, SC 29680  
 864-363-3415

**ENGINEER**  
 GRAY ENGINEERING  
 RODNEY GRAY, P.E.  
 132 PILGRIM ROAD  
 GREENVILLE, SC 29607  
 864-297-3027

NO. OF ACRES 40.8 AC      MILES OF NEW ROAD .59 MI.  
 NO. OF LOTS: 35      TM# P/O 0594020101500

**GRAPHIC SCALE**

( IN FEET )  
 1 inch = 100 ft.

DRAWN BY: BWE  
 CHECKED BY: JSR  
 PROJECT DATE: 1/20/05  
 SCALE: 1"=100'  
 JOB No.: 270014  
 PLOT DATE: 02/07/07

SHEET  
**P-1**

270014-PRELIM.DWG