

*****CAUTION*****

PLANNING UNIT LOCATION SERVICE
 1. THIS PLAN IS A PRELIMINARY DESIGN AND IS NOT TO BE USED FOR CONSTRUCTION OR AS A BASIS FOR ANY OTHER ACTION.
 2. THE DESIGNER ASSUMES NO LIABILITY FOR ANY DAMAGE OR INJURY TO PERSONS OR PROPERTY ARISING FROM THE USE OF THIS PLAN.
 3. THE DESIGNER ASSUMES NO LIABILITY FOR ANY DAMAGE OR INJURY TO PERSONS OR PROPERTY ARISING FROM THE USE OF THIS PLAN.

STAKEOUT FOR CONSTRUCTION

1. THERE IS A 2' BUFFER ZONE AROUND THE PERIMETER OF THE POND.
2. THERE IS A 2' BUFFER ZONE AROUND ALL UTILITIES.
3. THERE IS A 2' BUFFER ZONE AROUND ALL UTILITIES.

OPEN SPACE

1. OPEN SPACE SHALL BE MAINTAINED.

2. OPEN SPACE SHALL BE MAINTAINED.

STAKEOUT FOR CONSTRUCTION

1. ALL UTILITIES SHALL BE MAINTAINED.
2. ALL UTILITIES SHALL BE MAINTAINED.
3. ALL UTILITIES SHALL BE MAINTAINED.
4. ALL UTILITIES SHALL BE MAINTAINED.
5. ALL UTILITIES SHALL BE MAINTAINED.

SITE DATA:

TM# 54703-1-61
 AREA: 30.74 AC
 ZONING: R-12
 NEW ROAD: 4.531 L.F.
 TYP. LOTS: 65'X100'
 LOTS: 98

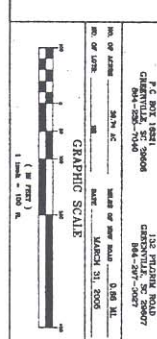

05-146

CARDINAL LAKE SUBDIVISION

TYPE OF DEVELOPMENT: R-12 (CLUSTER)

LAND DEVELOPMENT SOLUTIONS
 1100 PINE HILLS ROAD
 GREENVILLE, SC 29607
 (864) 297-2007

GRAY ENGINEERING CONSULTANTS, INC.
 132 PILGRIM ROAD - GREENVILLE, SC 29607
 (864) 297-2007
 (864) 297-2007
 FAX: (864) 297-2007
 WWW.GRAYENGINEERING.COM

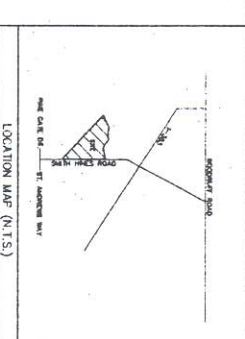

CV-1

DATE: 04/26/06
 DRAWN BY: JAC
 CHECKED BY: JAC
 PROJECT DATE: 3/21/05
 SCALE: 1"=400'
 PLATT DATE: 04/26/06

STAKEOUT PLAN

CARDINAL LAKE SUBDIVISION

SMITH HINES ROAD
 GREENVILLE COUNTY, SC

GRAY ENGINEERING CONSULTANTS, INC.
 engineering • site work • land planning

132 PILGRIM ROAD - GREENVILLE, SC 29607
 (864) 297-2007
 (864) 297-2007
 FAX: (864) 297-2007
 WWW.GRAYENGINEERING.COM

REV.	DATE	BY	REVISION
A	1/2	REG	SUBMITTED TO COUNTY FOR REVIEW AND APPROVAL