

INSTALL AGGREGATE BASE IN MAXIMUM 8" LIFTS.

PERVIOUS PAVING SYSTEMS
NTS

2-4 INCHES PERMEABLE ASPHALT OR 4-12 INCHES PERMEABLE CONCRETE WITH 15-20% VOID SPACE
NON-WOVEN GEOTEXTILE FABRIC
UN-COMPACTED SUBSOIL

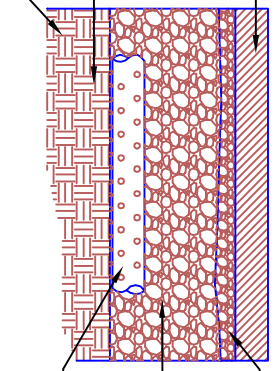

1-2 INCH CHOKER COURSE LAYER WITH 1.5 - 0.0937 INCH (NO. 8 STONE) CRUSHED & WASHED STONE
18-36 INCH STORGE LAYER WITH 2.5 - 0.5 INCH CRUSHED & WASHED STONE (AASHTO NO. 3)
UNDERDRAIN REQUIRED FOR SOILS WITH LONG TERM INFILTRATION RATES LESS THAN 0.5 IN/HR

POROUS ASPHALT & CONCRETE DETAIL
NTS

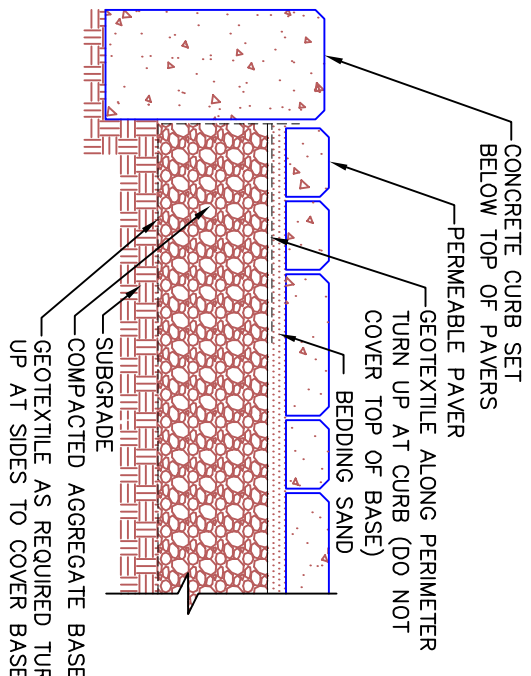

PERMEABLE PAVERS
NTS

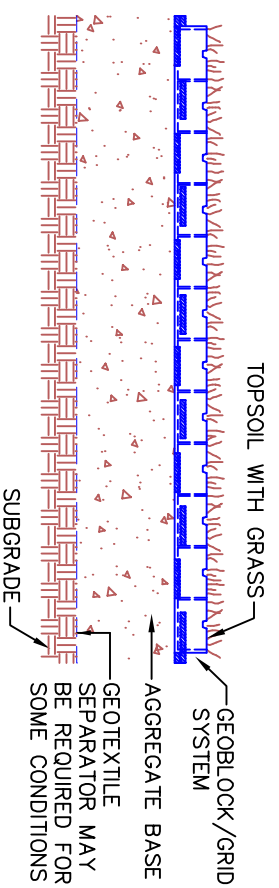

REINFORCED GRID SYSTEMS
NTS



Greenville County
Storm Water Management
PERVIOUS PAVEMENT

STANDARD DRAWING NO. **LID-01A**

APPROVED BY: GREENVILLE COUNTY STORM WATER MANAGEMENT January, 2013
DATE