

REF: PLAT OF PROPERTY OF J. P. STEVENS & CO., INC.
FILED IN PLAT BOOK 'MM', PAGE 101

CEDAR LANE ROAD (S.C. HWY. 416)

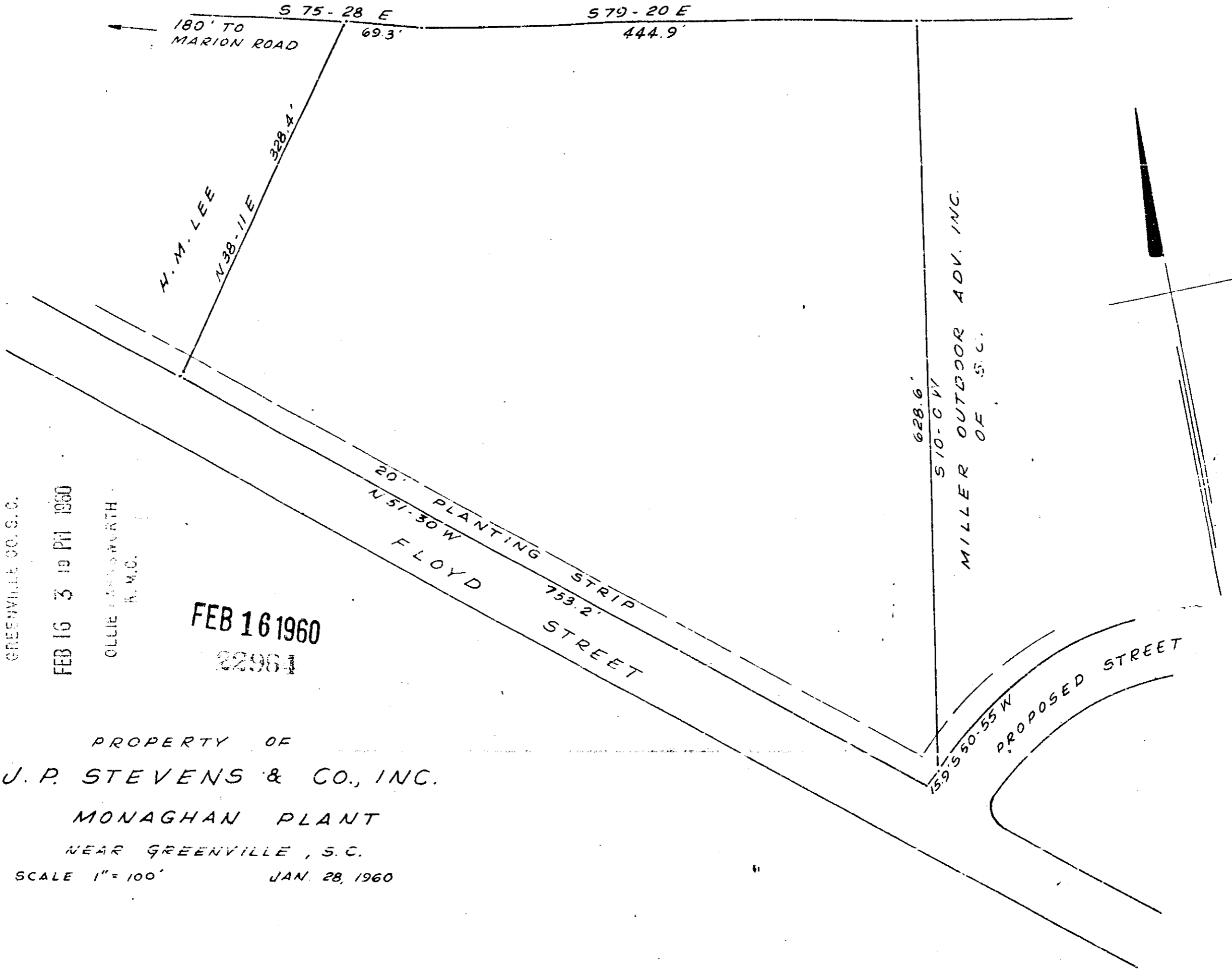

FILED
GREENVILLE CO. S.C.

FEB 16 3 19 PM 1960

OLLIE BARNWORTH
R.M.O.

FEB 16 1960
22964

PROPERTY OF
J. P. STEVENS & CO., INC.
MONAGHAN PLANT
NEAR GREENVILLE, S.C.
SCALE 1" = 100' JAN. 28, 1960

\$1.00
TT-139

PIEDMONT ENGINEERING SERVICE
GREENVILLE, SOUTH CAROLINA

22964
and recorded in TT-139
OLLIE BARNWORTH
Registered Professional Surveyor Greenville, S.C.