

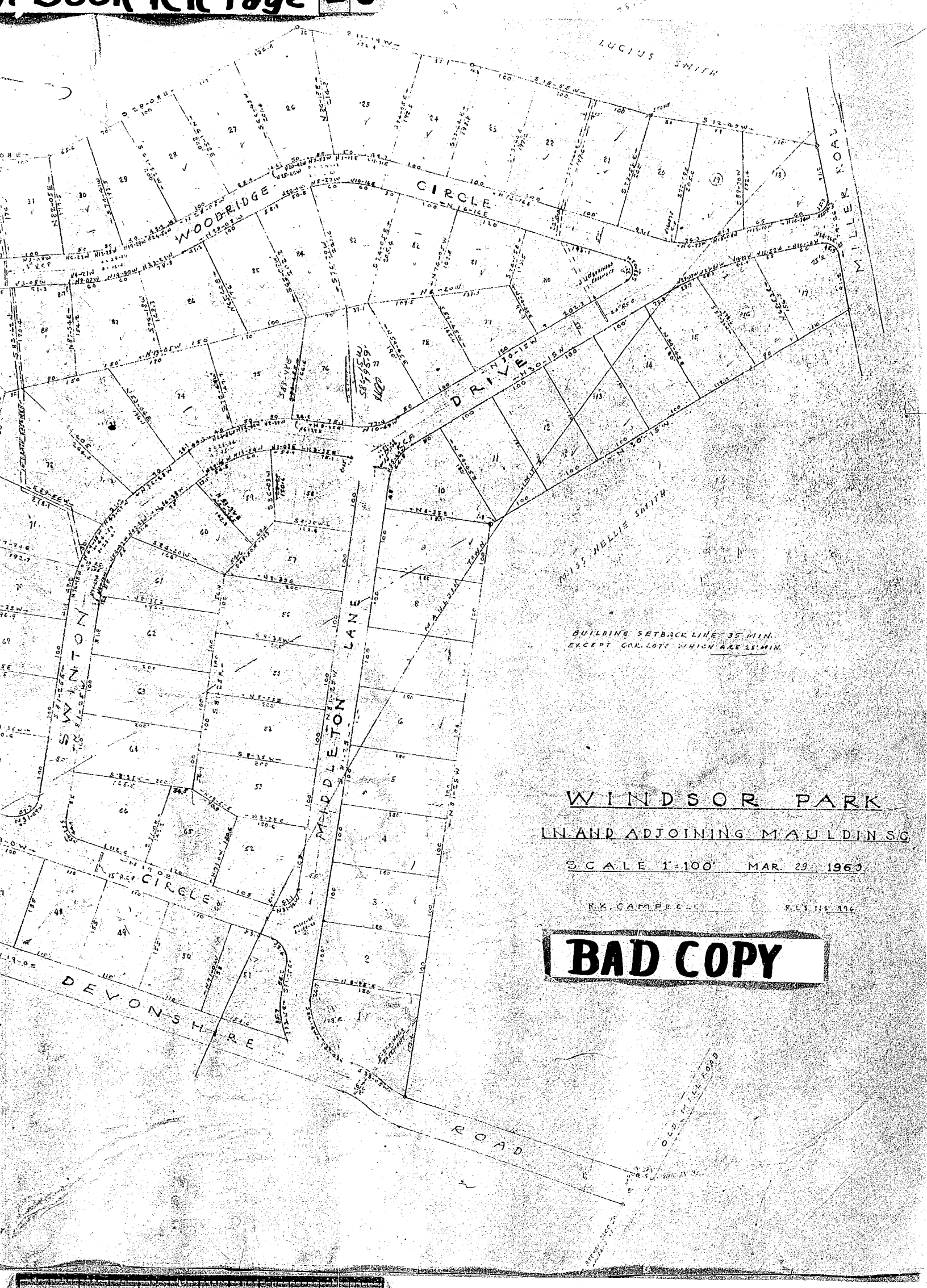

March 31, 1960
 # 10:30 P.M.
 # 26738
 #
 Book RP
 Page 25

R.C. COLLINS

26738, filed this 31 day of March 1960
 and recorded in Vol. 115 Page 25
 R.C. COLLINS
 Register Meane Conveyance Greenville County, S.C.



LUCIUS SMITH

WOODBRIDGE

CIRCLE

DRIVE

MIDDLETON LANE

SWINTON

CIRCLE

DEVONSHIRE

ROAD

OLD MILL ROAD

MISS HELLE SMITH

BUILDING SETBACK LINE 35 MIN. EXCEPT GAR. LOTS WHICH ARE 25 MIN.

WINDSOR PARK
INLAND ADJOINING MAULDIN SC

SCALE 1"=100' MAR. 29 1960

R.K. CAMPBELL

S.L.S. 114 196

BAD COPY