

CERTIFICATE OF SURVEY
 I HEREBY CERTIFY THAT THIS IS AN ACCURATE
 MAP OF AN ACTUAL SURVEY COMPLETED
 BY US ON DEC. 10, 1956
 PICKELL & PICKELL - ENGINEERS
 BY: *Walter Pickell* R.P.E.G.S.
 REG. NO. 540

CERTIFICATE OF OWNER
 I HEREBY CERTIFY AS OWNER OF THE
 PROPERTY AS SHOWN ON THIS MAP, APPROVE
 OF THE SUBDIVISION THEREOF AS SHOWN.
 GROVE PARK ESTATES
 BY: *John T. Douglas*

NOTE:
 THE EASEMENTS SHOWN HEREON ARE FOR DRAINAGE
 AND UTILITIES. IN ADDITION TO THOSE SHOWN, A 10' EASEMENT
 EASEMENT - 5 FEET ON EACH LOT - IS EVIDENCED ALONG
 ALL LOT SIDE LINES.

BAD COPY

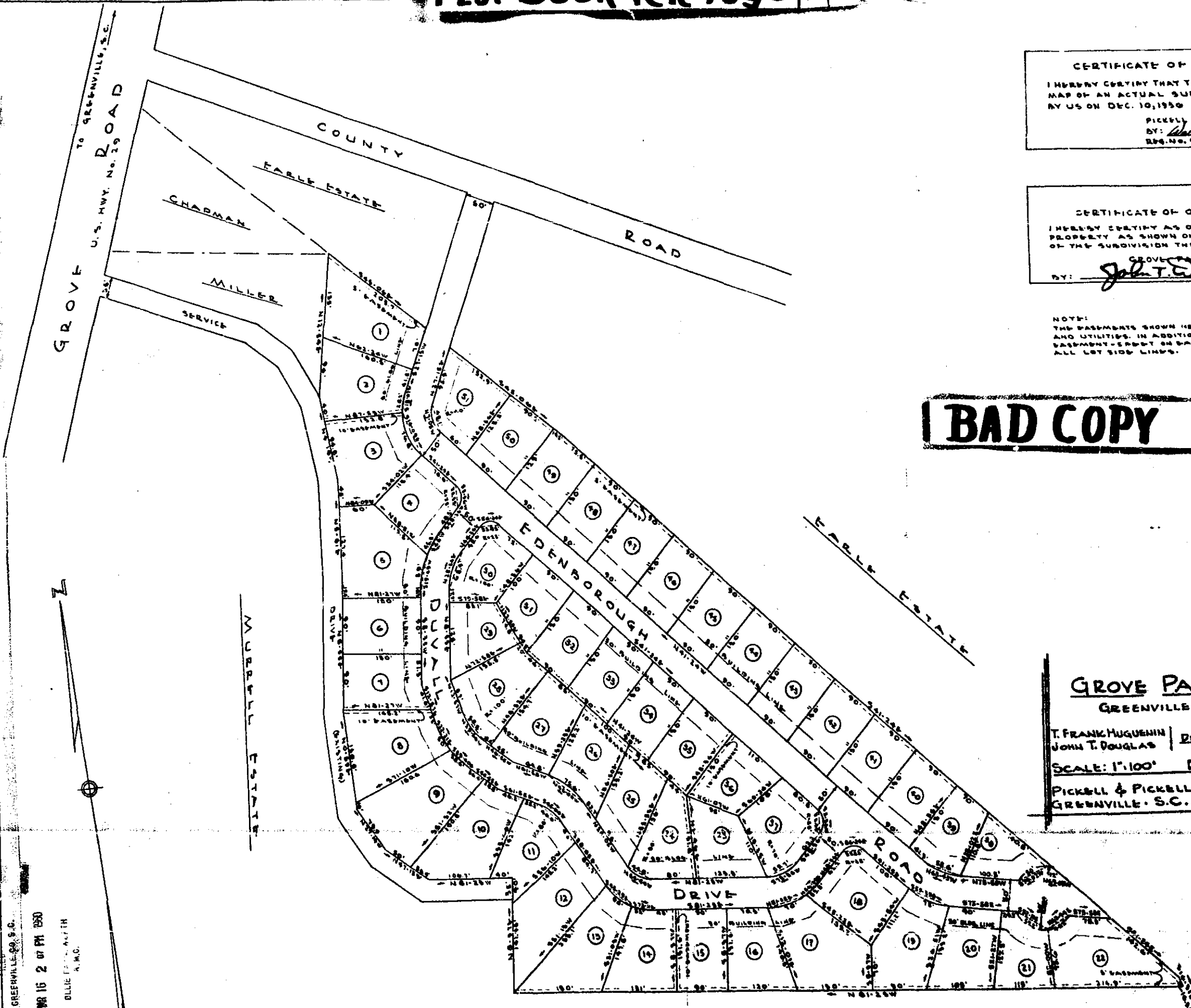

GROVE PARK ESTATES
 GREENVILLE COUNTY, S.C.

T. FRANK HUGENIN | DEVELOPER
 JOHN T. DOUGLAS
 SCALE: 1"=100' DATE: DEC. 10, 1956
 PICKELL & PICKELL - ENGINEERS
 GREENVILLE, S.C.

REVISED FEB. 16, 1960
 LOTS 20, 21, 22, 23, 24, 25

FINAL PLAN APPROVED
 GREENVILLE CITY PLANNING & ZONING COMMISSION
 DATE: 2-7-60 BY: *W. Louis Halliday*
 REGISTRAR

GREENVILLE, S.C.
 MAR 16 2 07 PM 1960
 BLUE PRINT A.C.T.H.
 A.M.C.

\$2.00
 RR-23
 25338
 MAR 16 1960

25338 Plat This 16 day of Nov 1960
 and Recorded in Vol. R.R. Page 23 of
 Registrar Elmer Connerly Greenville County, S.C.

E 171