

FILED  
GREENVILLE CO. S. C.

JAN 8 1 25 PM 1959

OLLIE FARNSWORTH  
R. M. C.

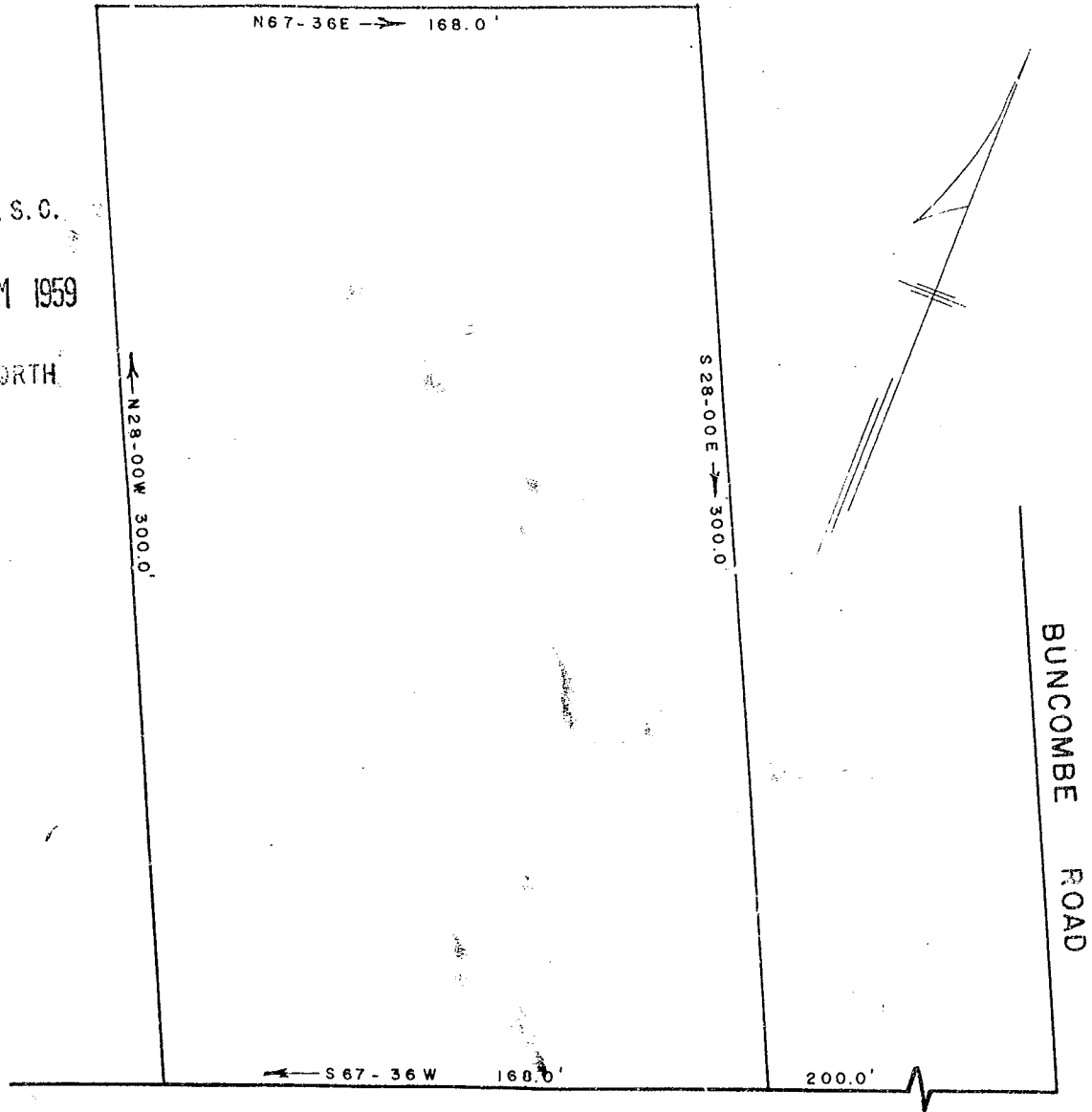

U. S. HIGHWAY NO. 29

PROPERTY OF  
C. L. KING, ESTATE  
NEAR GREER, S. C.  
SCALE 1" = 50' 11 OCT 1958

17147

JAN 8 1959

PG-29 = MC

SURVEY BY R. B. BRUCE R.L.S. 1952