

# Plat Book-NN-Page 81 B

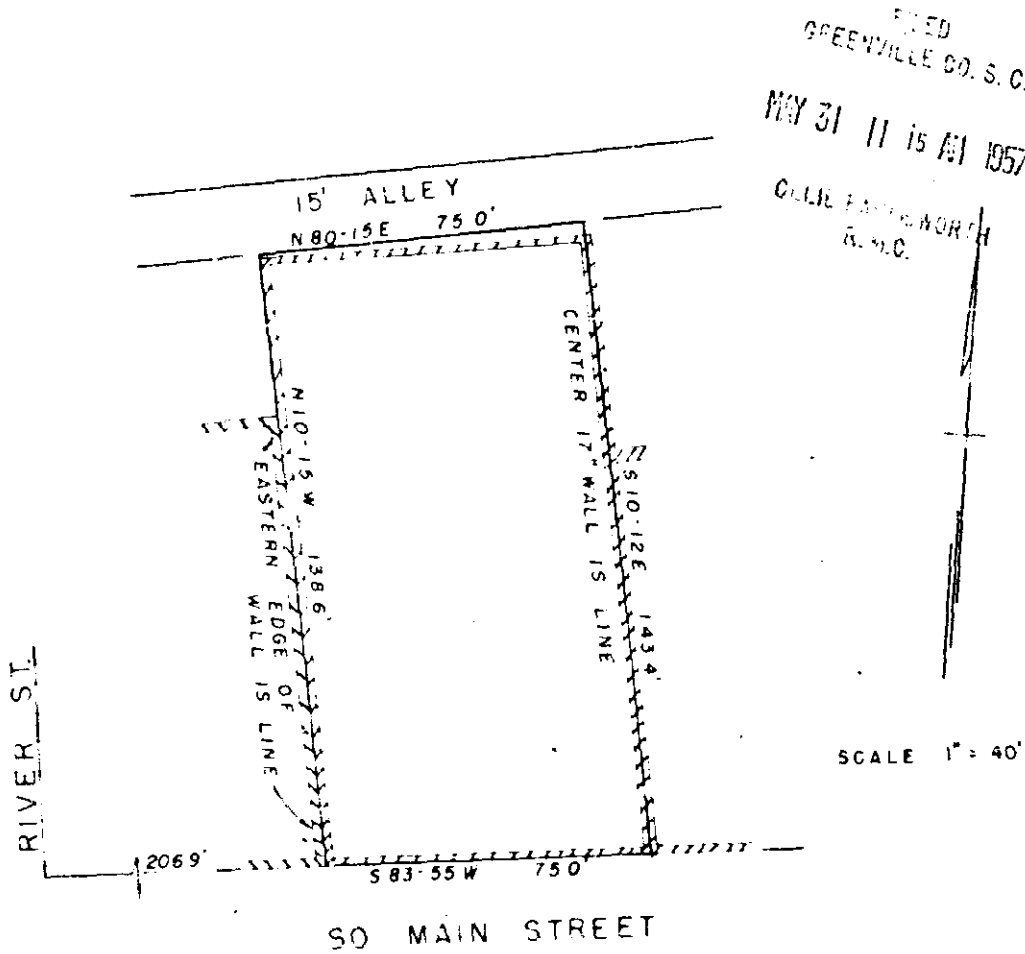

FILED  
GREENVILLE CO. S. C.  
MAY 31 11 15 AM 1957  
GODDIE BANSWORTH  
R.M.C.

SCALE 1" = 40'

PROPERTY OF  
BELK SIMPSON COMPANY, GREENVILLE, SOUTH CAROLINA

GREENVILLE, S.C.  
SCALE 1" = 40' 10 MAY 1957

This is to certify that on the 10th day of May, 1957, I surveyed the property shown on this plat; and that the property lines, walls and buildings are as shown hereon; that the buildings located on said lot do not encroach or project on adjacent streets or property, and that no adjacent walls or buildings encroach or project on this lot; and that there are no utility lines crossing this property except as shown.

MAY 31 1957

12997



12997-81

PIEDMONT ENGINEERING SERVICE  
GREENVILLE, S. C.

*[Signature]*  
Registered Engineer No. 808

3341

12997 Filed This 31 day of May 1957  
and Recorded in Vol. N Page 81  
Goddie Bawsorth  
Register Maps Cornerpiece Greenville County, S.C.