

EXISTING PARK AVE. SEWER
SCALE 1" = 50'

EXISTING BRUSHY CREEK SEWER

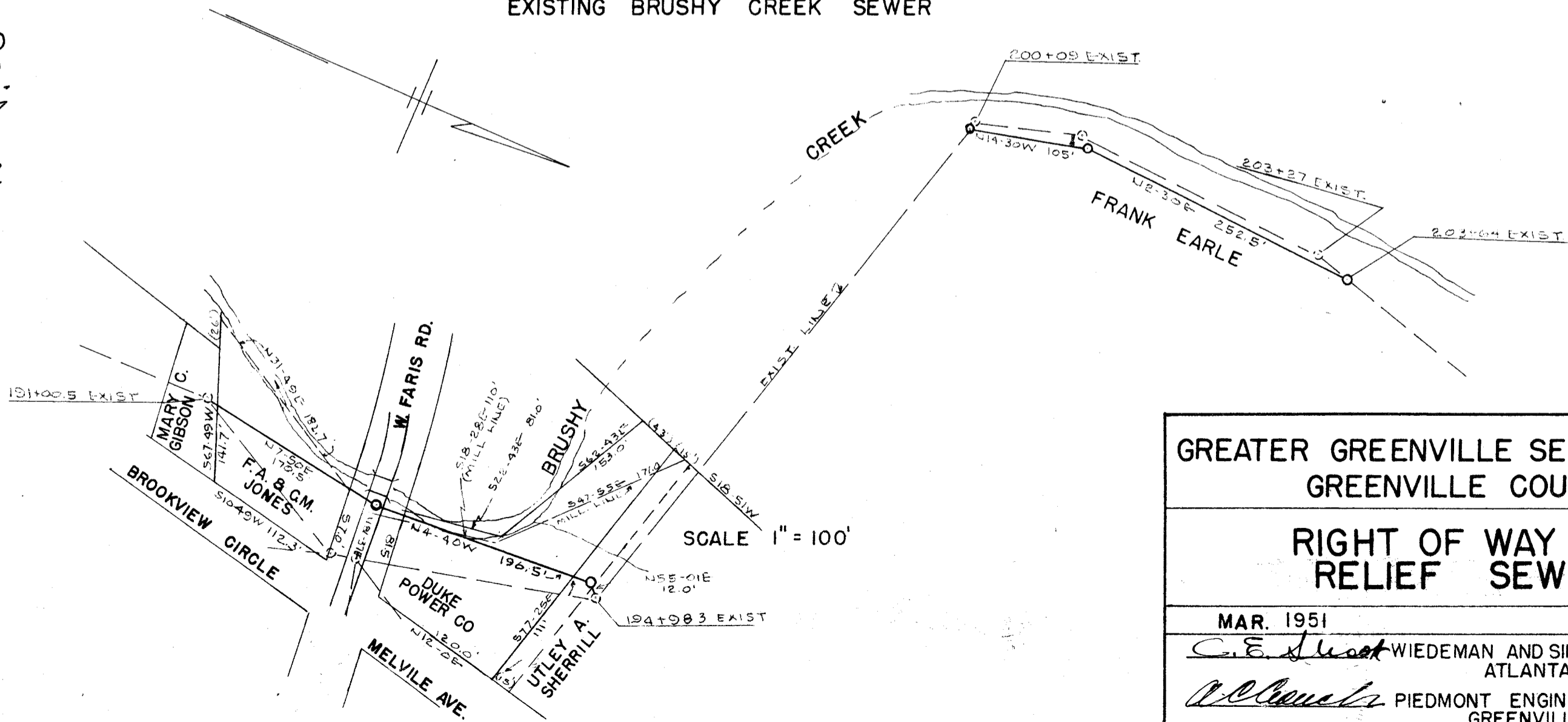

SCALE 1" = 100'

8971
APR 13 1951

GREATER GREENVILLE SEWER DISTRICT
GREENVILLE COUNTY, S.C.

RIGHT OF WAY PLAN
RELIEF SEWERS

MAR. 1951

SHEET NO. 1

C. E. Wiedeman WIEDEMAN AND SINGLETON, ENGRS.
ATLANTA, GA.
A. C. Singleton PIEDMONT ENGINEERING SERVICE
GREENVILLE, S.C.

8971
And Recorded in Vol. FR Page 57
Register Middle Conveyance Greenville County, S.C.