

M. C. GREEN or formerly

S30-30W 324.1

CHARPING
I.P. → N70-40W 101.9' I.P.

N30-30E → 344.5

WILLIAM M. OREM

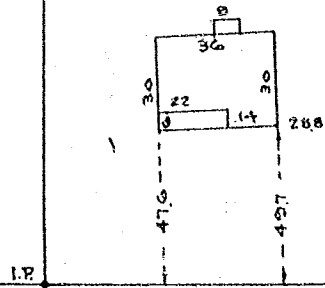
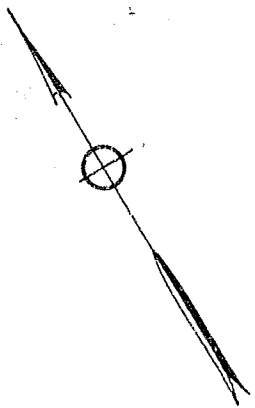

S58-30E 100 →

PARK AVE.

340

RUTHERFORD ROAD

PROPERTY OF
WILLIAM LEWIS FARMER
NEAR GREENVILLE S.C.
Scale 1"=50' April 1951

APR 9 - 1951

7934

#9434 Filed This 6 day of April 1951
And Recorded in Vol. 3 Page 197 of 507

Carrie H. Hamsworth
Register Mesne Conveyance Greenville County, S.C.