

Sealed at 10 chain 1/4 inch

L. 25

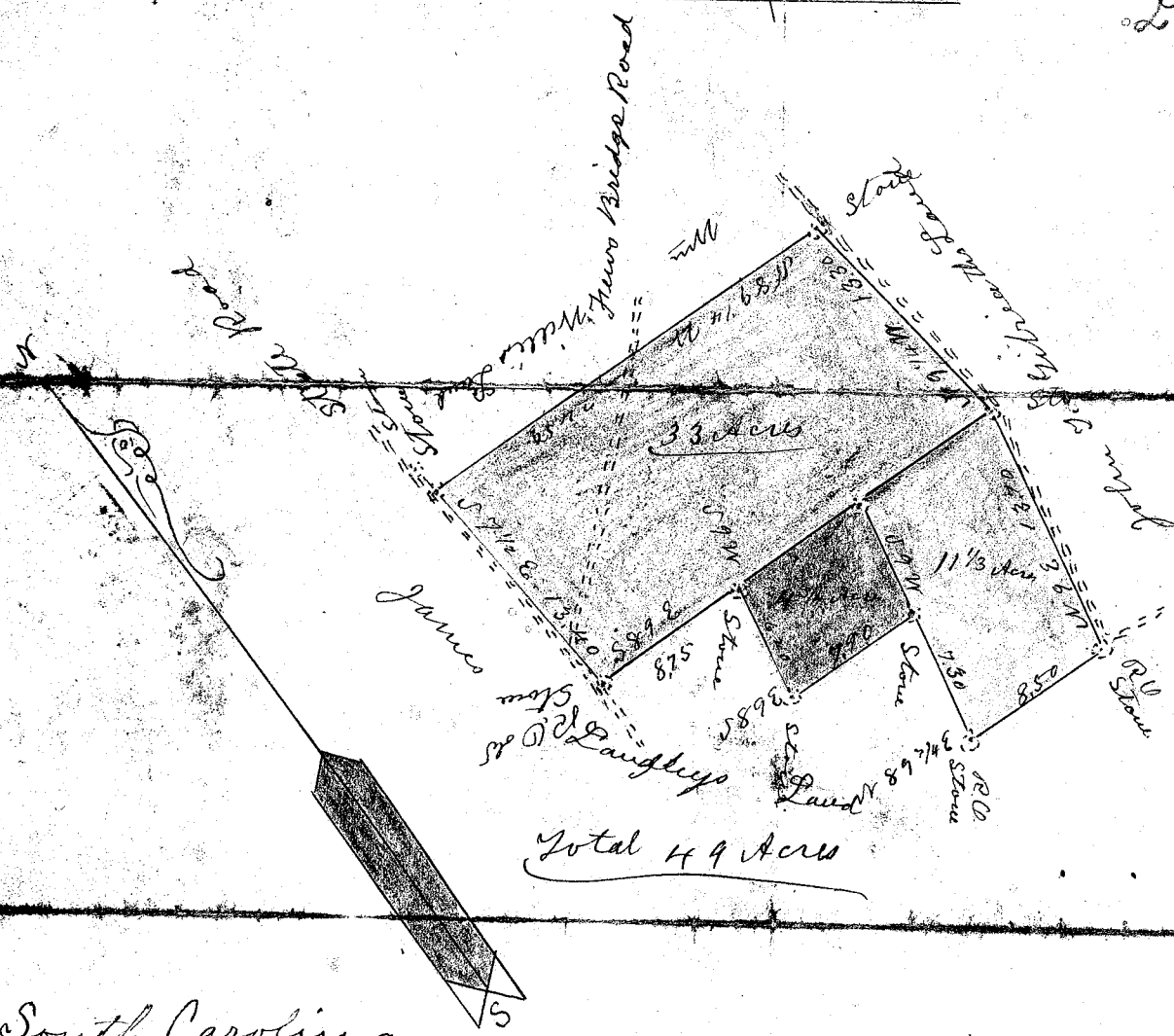

South Carolina

County of Greenville

The above 3 lots of land were sold to Henry S. Willis by Wadsworthville Trustees being the late Edwards, Aronie Edwards and Johnathan Hawks lands of the Lease to expire 1900 and situated about 13 miles from Greenville waters of Childers Beaverdam creek and hath such shape, marks and boundaries as above.

July 2nd 1897

Wm A. Hudson

D.S.

Filed for record in the office of
 the Clerk of the County of
 Greenville, S. C. on the
 17th day of Feb. 1901
 and recorded in Book L
 Page 25
 Ollie Farnsworth
 By # 2278