

E. S. COTHRAN

8,000

25,000

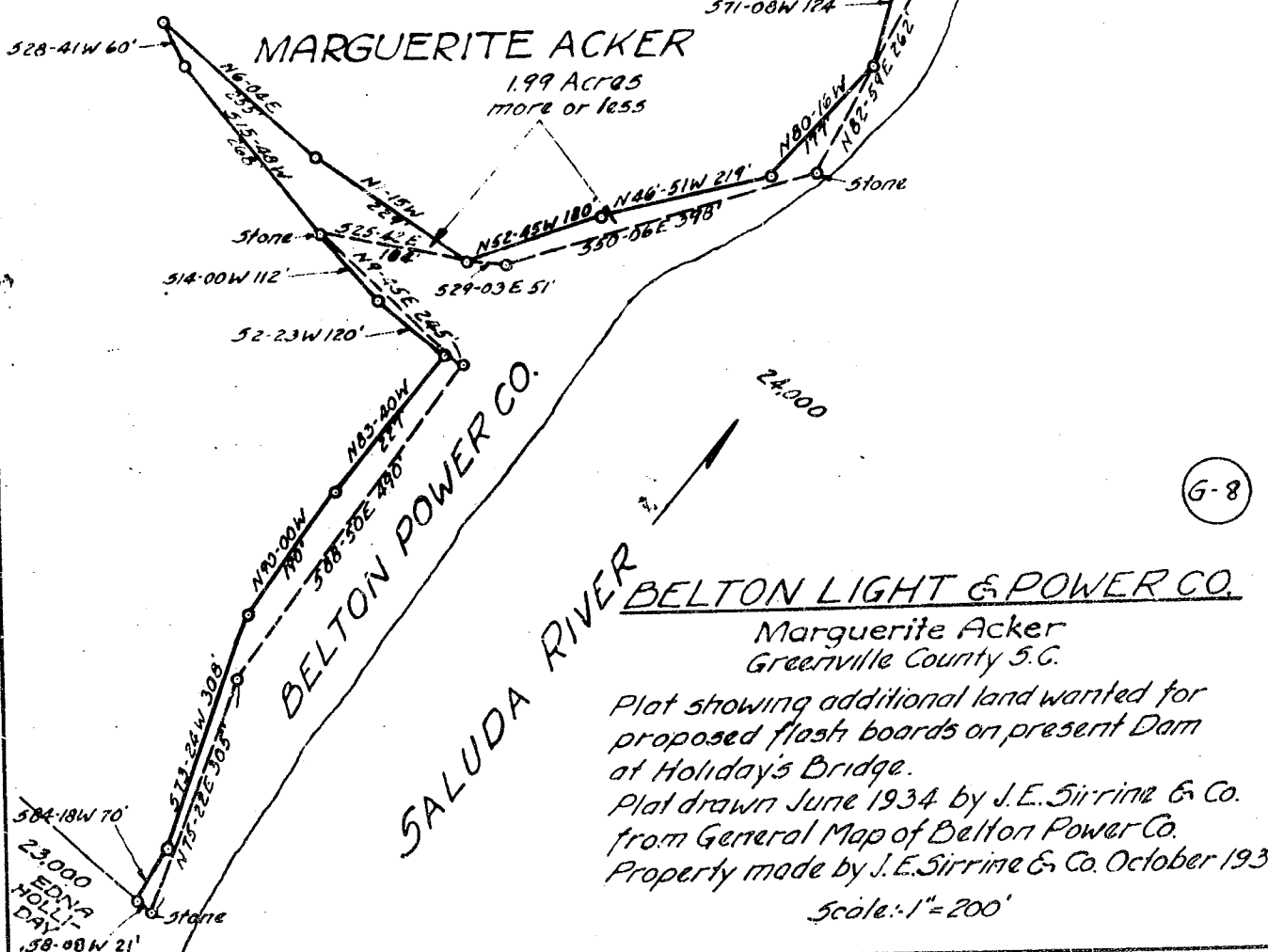
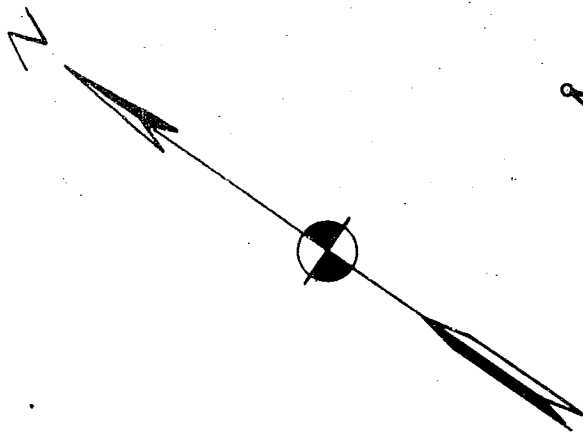

MARGUERITE ACKER  
1.99 Acres  
more or less

BELTON POWER CO.

BELTON LIGHT & POWER CO.

Marguerite Acker  
Greenville County S.C.

Plat showing additional land wanted for  
proposed flash boards on present Dam  
at Holiday's Bridge.  
Plat drawn June 1934 by J.E. Surrine & Co.  
from General Map of Belton Power Co.  
Property made by J.E. Surrine & Co. October 1930.

Scale: 1" = 200'

G-8

23,000  
EDNA  
HOLLI-  
DAY  
58-08W 21'