

MICROFILMED

NOTE: IRON PINS AT ALL PROPERTY CORNERS UNLESS NOTED.

FILED
GREENVILLE CO. S.C.

JUL 3 4 00 PM '86

DONNIE S. TANKERSLEY
R.M.C.



LOT 105

N 12°-03' E 191.70'

LOT 101

S 79°-28' E 100.10'

LOT 104

LOT 103

S 12°-03' W 194.40'

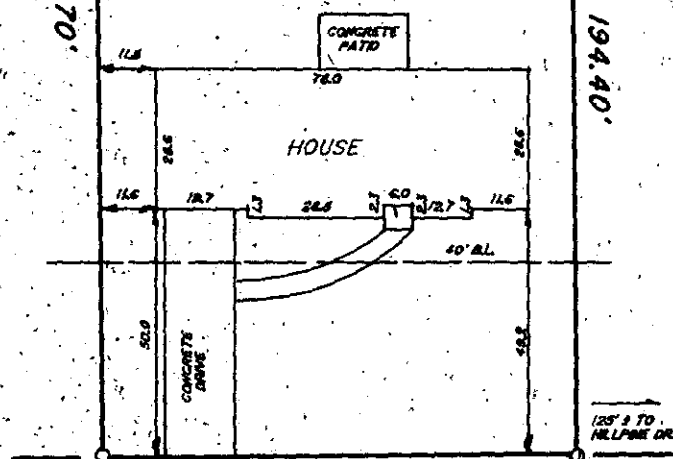

N 77°-57' W 100.00'

ASTER DR.

JUL 23 1986

3331

12-Y-80

This is to certify that on July 16, 1986, I surveyed the property shown on this plat, known as Lot 104 on plat of Poinsettia, Section 3, recorded in the R.M.C. Office of Greenville County, in Plat. Book PPP at Page 141, and that the property lines, walls and buildings are as shown hereon, that the building located on said lot does not encroach or project on adjacent streets or property, and that no adjacent walls or buildings encroach or project on said premises, and that no utility R/W's cross this property except as shown hereon. According to the Flood Rate Insurance Map and to the best of my knowledge, this structure is not in an Established Flood Zone.

Fredrick E. Landrith

Recordable plat

Fredrick E. Landrith RLS 9545

THIS PROPERTY IS SUBJECT TO ANY AND ALL RIGHTS OF WAY AND EASEMENTS OF RECORD.

LANDRITH SURVEYING

Land Surveys - Topographical Maps
Construction Layout

628-C WADE HAMPTON BLVD.
GREENVILLE, S.C. 29609
1803) 271-8536

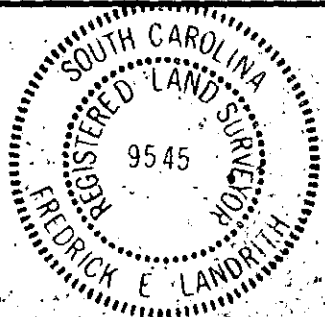
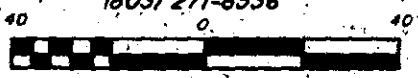

STATE of SOUTH CAROLINA
COUNTY of GREENVILLE

POINSETTIA
SEC. 3 LOT 104

PROPERTY OF
LAWRENCE N. GREER, Jr.
ANNELLE B. GREER

SURVEYED BY FEL

CHK'D BY FEL

DRAWN BY JMW

DATE JULY 17, 1986

SEAL

PROJECT NO. 86-853

THE PRINT MACHINE, INC. N74244