



FILED
GREENVILLE CO. S.C.
JUN 3 9 58 AM '86
DONNIE S. TANKERSLEY
R.M.C.

10' RESERVATION
FOR PIPES & POLES
N 39-25 W 78.31

133

S 33-58 W 275.33

132

131

130

129

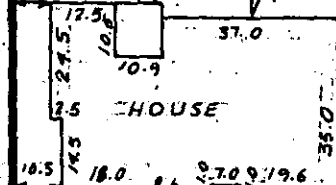
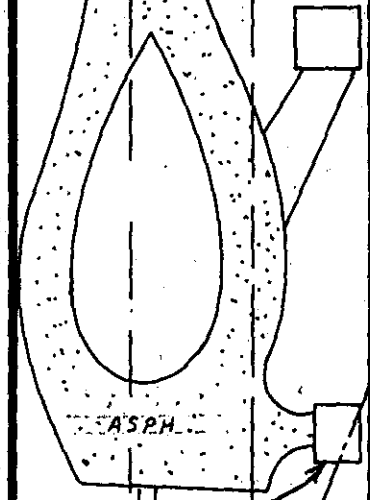

S 55-44 E 75.06

HEATHER WAY

325' TO CLUB DR

JUN 3 1986

12-V-7 40360

SCALE 1" = 40' FEET

THIS IS TO CERTIFY THAT THE PROPERTY SHOWN ON THIS PLAT WAS SURVEYED UNDER MY DIRECT SUPERVISION. PROPERTY LINES AND IMPROVEMENTS SHOWN ARE LOCATED CORRECTLY AND THAT NO VISIBLE ENCROACHMENTS EXIST UNLESS OTHERWISE SHOWN. THIS PROPERTY IS NOT LOCATED IN A DESIGNATED FLOOD HAZARD AREA.

STATE OF SOUTH CAROLINA
GREENVILLE COUNTY

FREELAND-CLINKSCALES
& ASSOCIATES, INC.
Engineers • Land Surveyors
323 WEST STONE AVENUE
GREENVILLE, S.C.
(803) 271-4924

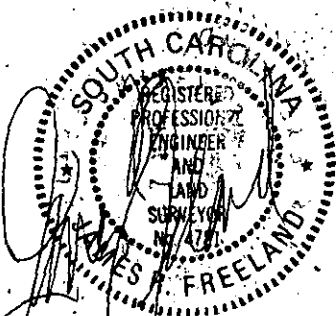

R/S: JAMES R. FREELAND
NO: 4781

MARSHALL FOREST
LOTS 130, 131, 132
PROPERTY OF
ALI SAIFI
NANCY P. SAIFI

PLAT BOOK	H-133-134
DEED BOOK	1203-250
TAX MAP	210-5-14
PARTY CHIEF	J.C.C.
DRAWN	D.L.B.
DATE	5-29-86
DWG. NO.	15361