

FILED
GREENVILLE CO. S.C.
JUL 18 4 22 PM '86
DORRIS S. TANKERSLEY
R.M.C.

MICROFILMED

FILED
GREENVILLE CO. S.C.
JUL 18 4 22 PM '86
DORRIS S. TANKERSLEY
R.M.C.

MICROFILMED

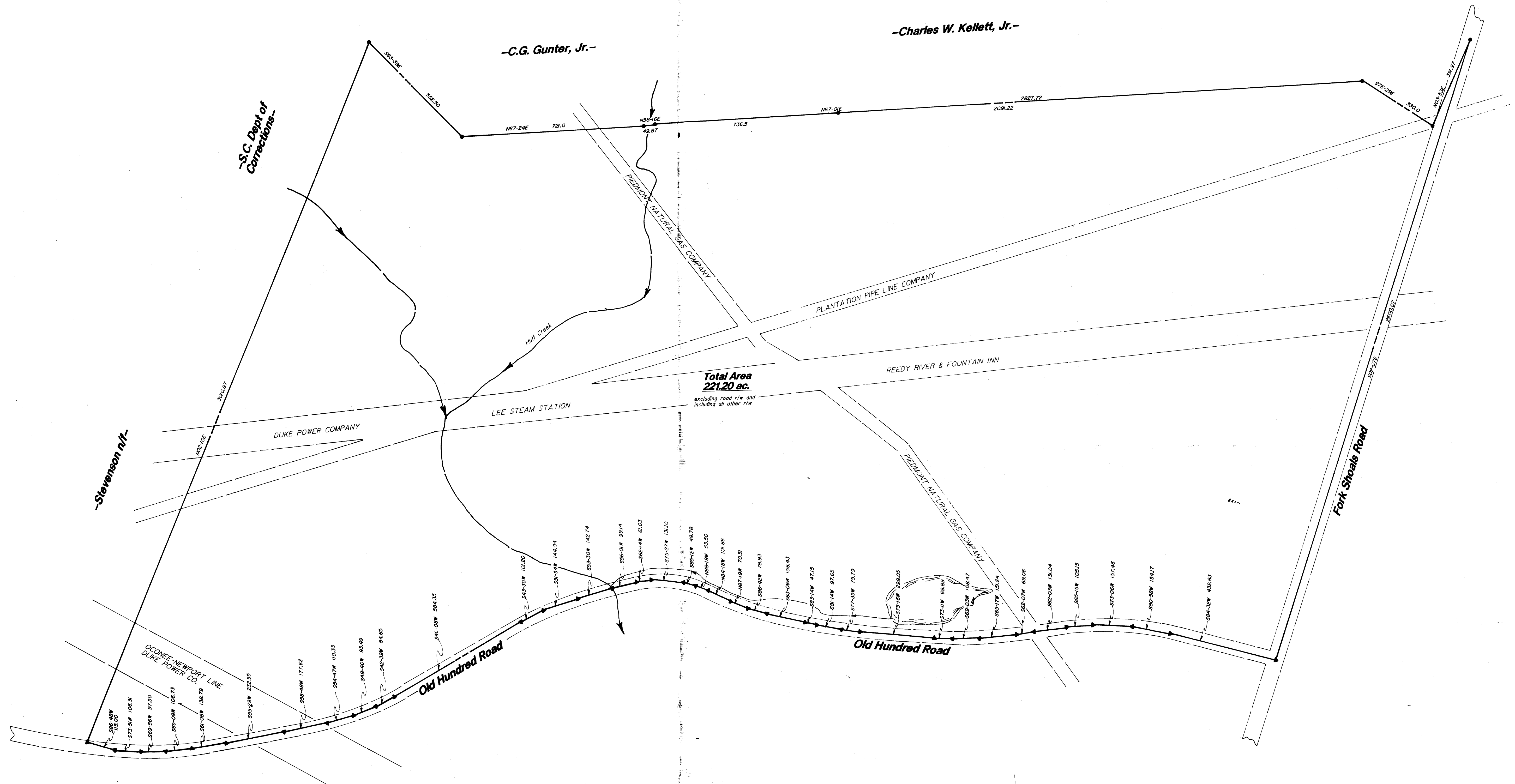

JUL 18 1986

12-P-99

12-P-100 JUL 18 1986

2748

2748

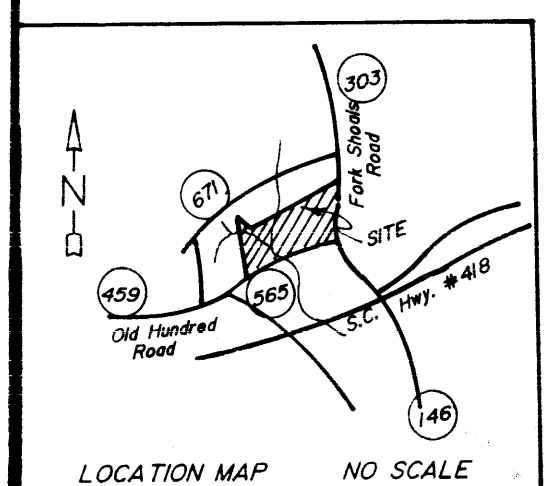

I do hereby certify that the ratio of precision of the field survey is "as shown hereon" and that the area was determined by the Method of area calculation.

Robert R. Spearman
 Robert R. Spearman, R.L.S. #3615
 Post Office Box 4
 Eastley, South Carolina
 Phone 1803/859-2309

FINAL SURVEY FOR
Kellett's Well Boring, Inc.
 greenville county south carolina
 july 10, 1986 scale 1"=200'
 200 0 200 400
 scale

6210 1-118 96 194 10-0000