

STANDING SPRINGS ROAD

MAG 1971

S22-20E

400.0

250.1 TO
MECALL
ROAD

N71-12E
603.3
GRAVEL DRIVE

OIP
19.7

418.5 TOT
- S61-30W

- W. J. KNIGHT -

- B. KEITH GARRETT -

FILED
GREENVILLE CO. S.C.
APR 15 1 45 PM '86
JUNNIE S. ANKERSLEY
R.M.C.

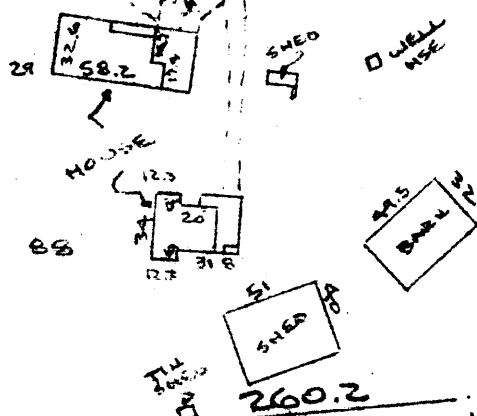

S20-43E
104.0

Note: Improvements on this lot are not in a flood hazard area.

- 10.04 AC -

IRIS L. & J. BENNETT JINSON

445.8
- S61-04W

- C. C. GARRETT -

PROPERTY OF
EVELYN C. EDMINISTER
NEAR SIMPSONVILLE, GREENVILLE CO., S.C.
SCALE: 1"=100' 14 APR 1986

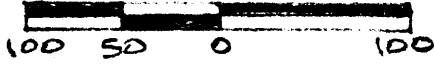

APR 15 1986

12 P - 13

33763

5.0001
469
1 AP1586
GCTD

This is to certify that on the 14th day of April, 1986, I surveyed the property shown on this plat, being known as 10.04 acres on plat of PROPERTY OF G. W. HUGH BROWN and recorded in the RMC Office Greenville County, S. C., in Plat Book " 4 - J " at Page 31; and that the property lines, walls and buildings are as shown hereon, and that the walls and buildings located on said lot do not encroach or project on adjacent street or property, and that no adjacent walls or buildings encroach or project on said premises no power lines cross this property and no visible encroachments except as shown hereon.

R. B. Bruce
R. B. Bruce, RLS # 1952

CAROLINA SURVEYING CO.
112 Manly St.
Greenville, S. C.

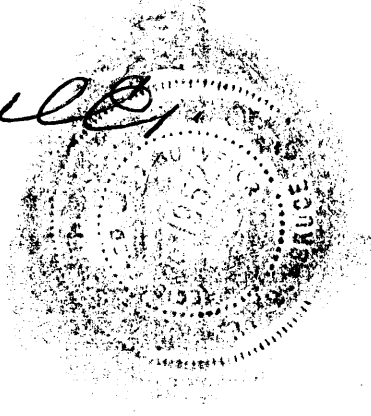

Recordable Plat