

FILED
GREENVILLE S.C.

APR 17 11 52 AM '86

LANEWOOD STREET

WATER & SEWER IN ST R/W

MAR 1921

JUNNERS LANE
R.M.C.

172-241
146.4
SARCEL DRIVE
OLD LOT LINES

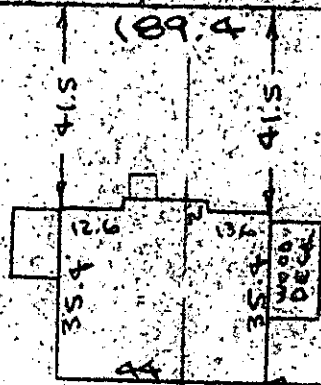

154.0
55.4
BENNETT AVENUE
BENNETT AVENUE

Note: Improvements on this lot are not in a flood hazard area.

APR 17 1986

PROPERTY OF
LEROY F HOAGLAND JR & MARGARET F HOAGLAND
GREENVILLE COUNTY GREER, S.C.
SCALE 1"=40' 28 MAR 1986



This is to certify that on the 28th day of March, 1986, I surveyed the property shown on this plat, being known as lots 33, 34 & part of lot 32 on plat of WESTMORELAND CIRCLE and recorded in the RMC Office Greenville County, S.C., in Plat Book " T " at Pages 198 & 199, and also being known as PROPERTY OF LEROY F. HOAGLAND, JR. & MARGARET F. HOAGLAND and recorded in Plat Book _____ at Page _____; and that the property lines, walls and buildings are as shown hereon, and that the walls and buildings located on said lot do not encroach or project on adjacent street or property, and that no adjacent walls or buildings encroach or project on said premises, no power lines cross this property and no visible encroachments except as shown hereon.

12-0-81

34054

R. B. Bruce

R. B. Bruce

CAROLINA SURVEYING
Greenville, S.C.

CO.

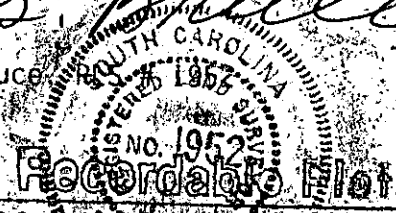

Recordable Plat