

FILED *MAG. NORTH*
GREENVILLE, S.C.

FEB 28 4 29 PM '86

DONNIE S. TANKERSLEY
R.M.C.

S 73-44 E 6.05

S 19-16 W 244.86

N 67-38 E 284.88

N 70-49 W 177.93

9

10

11

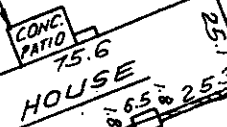
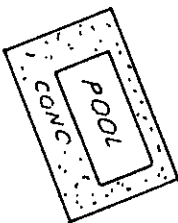

806.2' ± TO
VERNER DRIVE

OVERTON AVE.

FEB 28 1986

N 12-06 W 50.0
N 31-42 W 20.0

12-K-94

28380

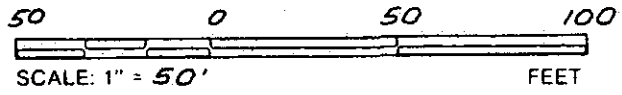

This is to certify that the property shown on this plat was surveyed under my direct supervision. Property lines and improvements shown are located correctly and that no visible encroachments exist unless otherwise shown. This property is not located in a designated flood hazard area.

**STATE OF SOUTH CAROLINA
GREENVILLE COUNTY**

FREELAND & ASSOCIATES
Engineers • Land Surveyors
318 WEST STONE AVENUE.
GREENVILLE, S.C.
(803) 271-4924

CEDAR VALE
LOT 10
PROPERTY OF
LARRY R. BELL
LORETTA J. BELL

PLAT BOOK 000 - 13
DEED BOOK 1040 - 887
TAX MAP 437.1-1-11
PARTY CHIEF R. J.
DRAWN I.R.
DATE FEB. -25-86
DWG. NO. 14679

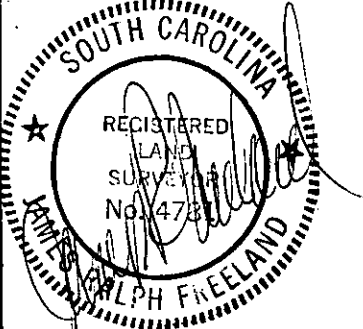

RLS: JAMES R. FREELAND
NO: 4781