

MICROFILMED

N 6° 59' E -- 80.0

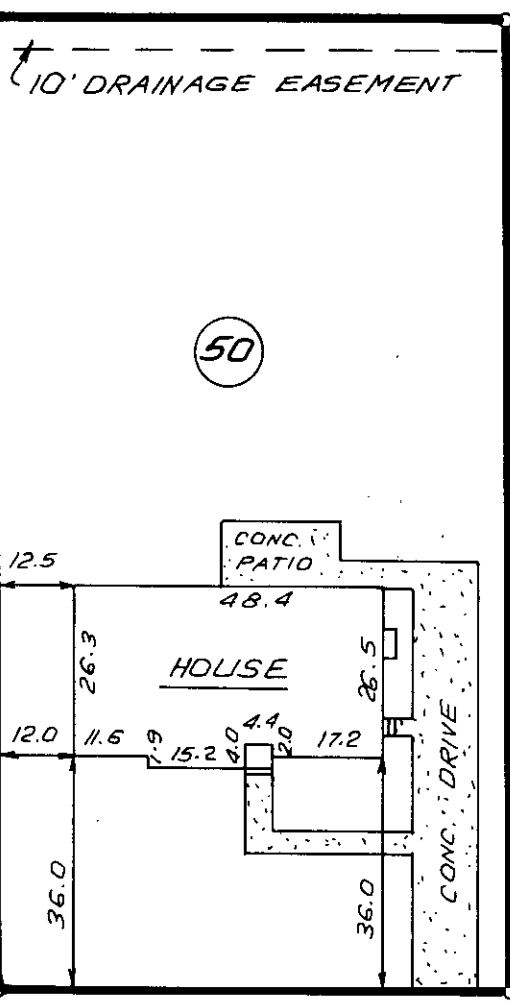
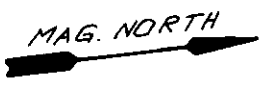

FILED
GREENVILLE CO., S.C.
JAN 17 4 46 PM '86
DUNNIE S. TANKERSLEY
R.M.C.

49

51

221.7' ± TO
STOKES ROAD

S 7-12 W 80.0

JAN 17 1986

23853

BROCKMERE ROAD

12-I-21



NOTE: 5' DRAINAGE & UTILITY EASEMENT
EACH SIDE OF ALL SIDE & REAR
LOT LINES.

THIS IS TO CERTIFY THAT THE PROPERTY SHOWN ON THIS PLAT WAS SURVEYED UNDER MY DIRECT SUPERVISION
PROPERTY LINES AND IMPROVEMENTS SHOWN ARE LOCATED CORRECTLY AND THAT NO VISIBLE ENCROACHMENTS
EXIST UNLESS OTHERWISE SHOWN. THIS PROPERTY IS NOT LOCATED IN A DESIGNATED FLOOD HAZARD AREA

300 3
31A01

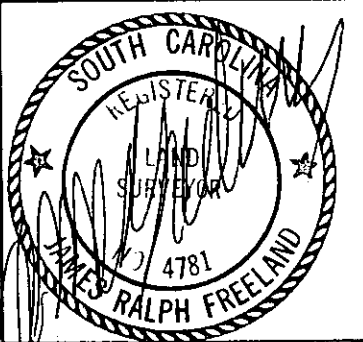

PLS JAMES R. FREELAND
NO 4781

**STATE OF SOUTH CAROLINA
GREENVILLE COUNTY**

BELLINGHAM
SEC. IV; LOT 50
PROPERTY OF
THOMAS G. GIORDANO
JOANN T. GIORDANO

FREELAND & ASSOCIATES
Engineers • Land Surveyors
318 WEST STONE AVENUE.
GREENVILLE, S.C.
(803) 271-4924

PLAT BOOK	5P-48
DEED BOOK	
TAX MAP	300.1-1-16.2
PARTY CHIEF	R.J.
DRAWN	I.R.
DATE	JAN.-14-86
DWG NO	14,485