

LOCATION MAP

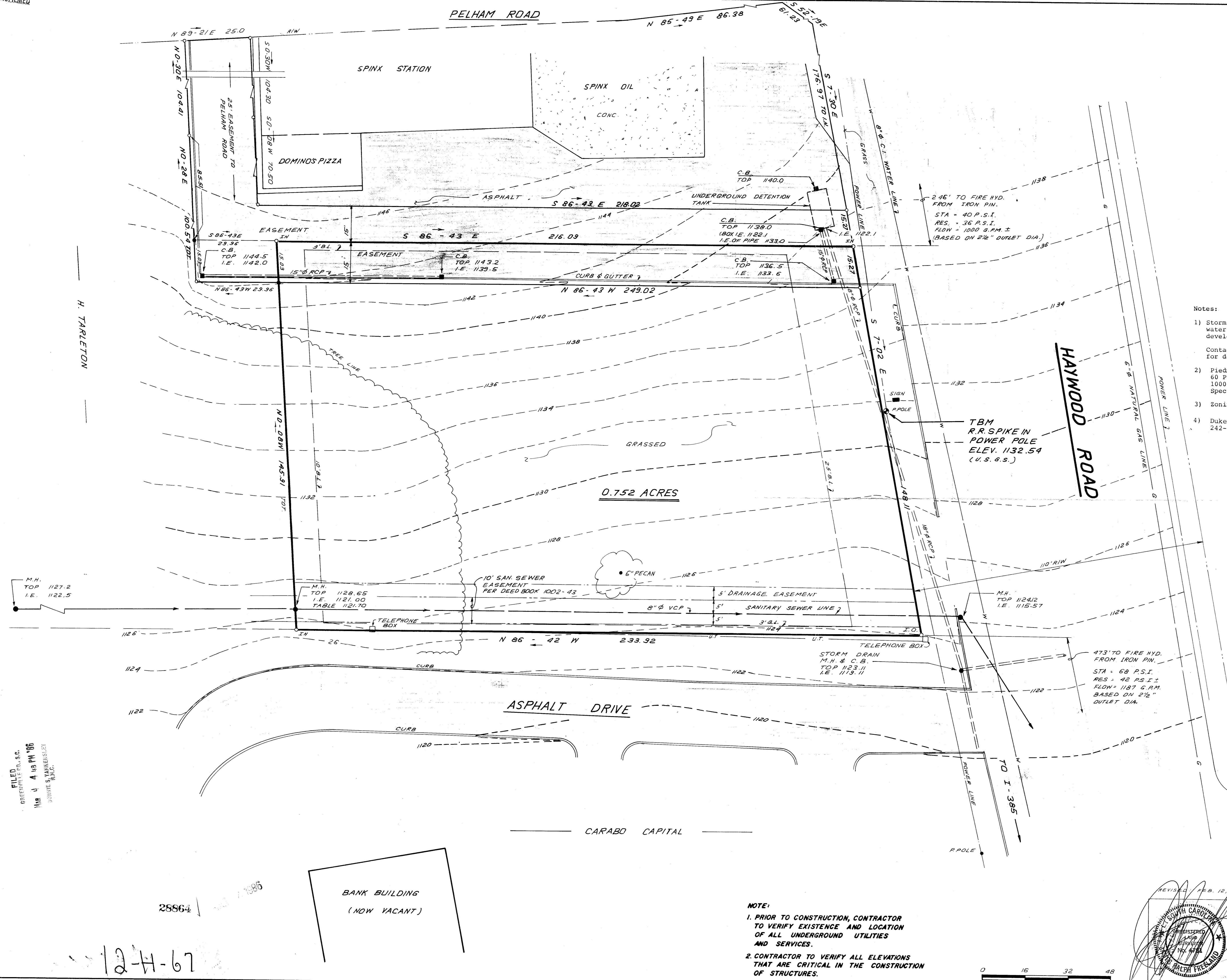

- Notes:
- 1) Storm Water: City of Greenville uses the rational method for water run off. After development outflow has to equal prior development outflow based on 10 year storm plan.
Contact City of Greenville Engineering Department (Don Fogle) for design manual.
 - 2) Piedmont Natural Gas 232-5141
60 PSI
1000 BTU / Cubic Feet
Specific Gravity 0.6
 - 3) Zoning: C-3
 - 4) Duke Power Company
242-5111

I hereby certify that the ratio of precision of the field survey is 1/10,000 as shown hereon and the area was determined by DMD Method.
James R. Freeland
James R. Freeland RLS & PE 4781

FILED
GREENVILLE CO., S.C.
MAR 4 4 09 PM '86
JOHN S. TANKERSLEY
R.M.C.

- NOTE:
1. PRIOR TO CONSTRUCTION, CONTRACTOR TO VERIFY EXISTENCE AND LOCATION OF ALL UNDERGROUND UTILITIES AND SERVICES.
 2. CONTRACTOR TO VERIFY ALL ELEVATIONS THAT ARE CRITICAL IN THE CONSTRUCTION OF STRUCTURES.

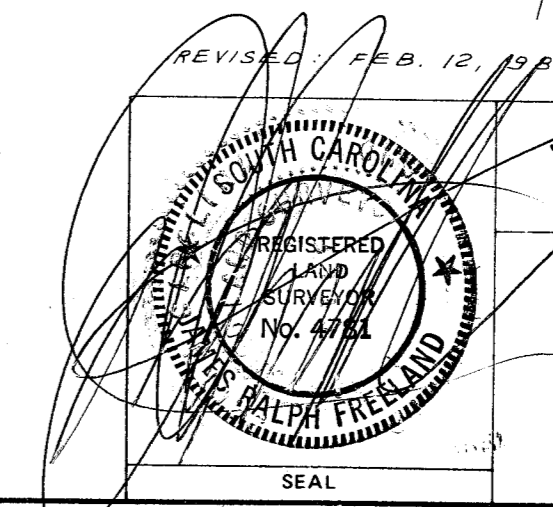
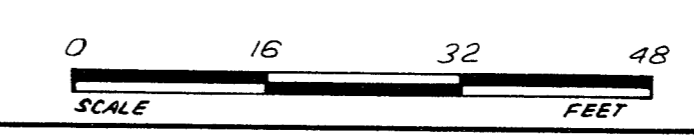

STATE OF SOUTH CAROLINA
GREENVILLE COUNTY

TOPOGRAPHIC SURVEY
FOR
FIRESTONE TIRE &
RUBBER COMPANY, INC. MR. 4 86

FREELAND & ASSOCIATES Engineers & Land Surveyors GREENVILLE, S.C.	
SURVEY	J.C.
DRAWN	I.R.
CHECK	M.L.C.
SCALE	1" = 16'
DATE	NOV. - 29 '85
DWG. NO.	14222

12-4-67

12-4-68

ORCHARD PARK DRIVE
MAR 4 1986
28864