

MICROFILMED

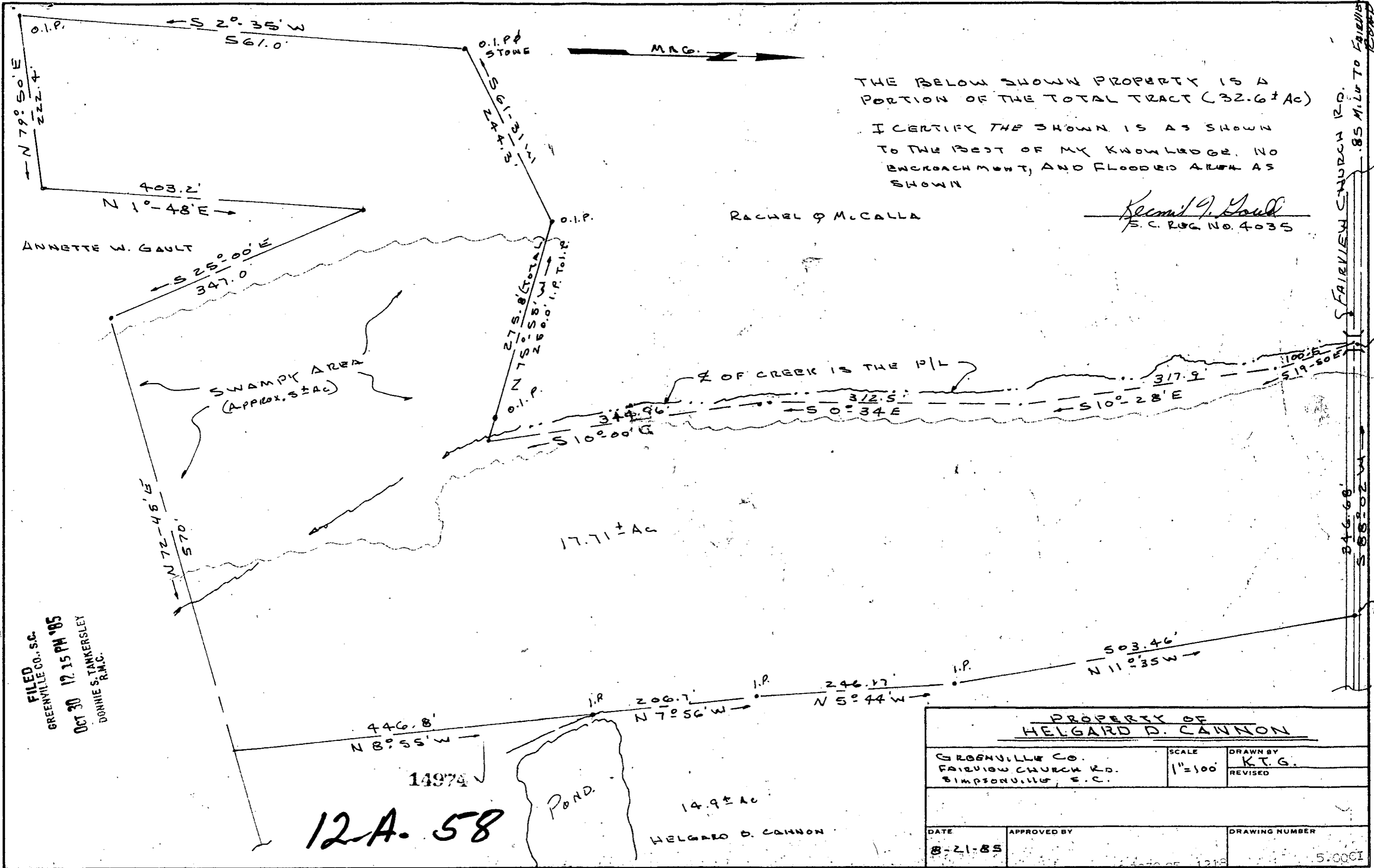

THE BELOW SHOWN PROPERTY IS A PORTION OF THE TOTAL TRACT (32.6±Ac)
 I CERTIFY THE SHOWN IS AS SHOWN TO THE BEST OF MY KNOWLEDGE, NO ENCROACHMENT, AND FLOODED AREA AS SHOWN

RACHEL O. McALLA

Kenneth J. Gould
 S.C. REG. NO. 4035

ANNETTE W. GAULT

SWAMPY AREA
 (APPROX. 3±Ac)

17.71±Ac

14.9±Ac
 HELGARD D. CANNON

12A.58

FILED
 GREENVILLE CO., S.C.
 OCT 30 12 15 PM '85
 DONNIE S. TANKERSLEY
 R.M.C.

PROPERTY OF HELGARD D. CANNON		
GREENVILLE CO. FAIRVIEW CHURCH R.D. SIMPSONVILLE, S.C.	SCALE 1"=100'	DRAWN BY K.T.G. REVISED
DATE 8-21-85	APPROVED BY	DRAWING NUMBER 5.000CI

FAIRVIEW CHURCH R.D. .85 MI. TO FAIRVIEW

MICROFILMED