

MICROFILMED

HUGHS

JONES

N 49°-28' W

348.5'

N 41°-15' E
377.4'

N 25°-50' W

850.2'

MAGNETIC

S 13°-55' E

5.0 AC. ±

MONOS

1204.9'

FOUNDATION SURVEY

PROPERTY OF

WILLIAM C. VAUGHN

AND

DEBORAH T. VAUGHN

GREENVILLE COUNTY, SOUTH CAROLINA
JUNE 27, 1984 SCALE 1"=100'

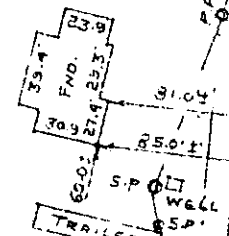

ONESVILLE ROAD

160' TO MCKINNY RD.

FILED
GREENVILLE CO., S.C.
SEP 13 12 22 PM '85
DONNIE S. TANKERSLEY
R.M.C.

This is to certify that on June 27, 1984, I located the foundation on this property known as PROPERTY OF WILLIAM C. and DEBORAH T. VAUGHN, as recorded in the RMC Office for Greenville County in Plat Book , at Page and that the property lines, walls and foundation are as shown hereon, and that the foundation located on said lot does not project nor encroach on adjacent streets or property, and that no adjacent walls or buildings project nor encroach on said lot.

NOTE: This property is not located within a flood hazard area.

8975 ✓

Surveyed by: Richard D. Wooten, Jr.
Greenville, South Carolina

Richard D. Wooten, Jr.
S. C. R. L. S. No. 4678

11-y-11

SEP 13 1985

Dwg. No. 3208

RECORDABLE PLAT

300 3
1041