

PLANTATION DRIVE
WATER & SEWER LINES

MICROFILMED

FILED
GREENVILLE CO., S.C.
SEP 3 4 30 PM 1985
DONNIE S. TANKERSLEY
R.M.O.

MAG
1989

Note: 5' drainage & utility easement each side all side and rear lot lines unless otherwise shown.

SWAMP AREA

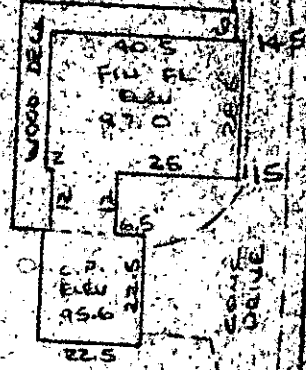

30
BC

Note: Finished floor of house should be elevation 95 + to be above flood plain, in accordance with plat dated 8/28/79, Freelend & Assoc. recorded in Plat Book " 7 - N " at Page 26.

SEP 3 1985

17677

11-W-51

PROPERTY OF
WILLIAM R. ZIMMERMAN & CORETTA M. ZIMMERMAN
GREENVILLE COUNTY, S.C.
SCALE 1" = 40' 21 AUG 1985



This is to certify that on the 21st day of Aug. 1985, I surveyed the property shown on this plat, being known as lot 130 (0.67 ac.) on plat of PROPERTY OF FRANKLIN ENTERPRISES and recorded in the RMC Office Greenville County, S. C., in Plat Book " 7 - N " at Page 26; and that the property lines, walls and buildings are as shown hereon, and that the walls and buildings located on said lot do not encroach or project on adjacent street or property, and that no adjacent walls or buildings encroach or project on said premises, and no power lines cross this property except as shown hereon.

CAROLINA SURVEYING CO.
112 Manly St.
Greenville, S. C.

R. B. Bruce, R.L.S. #1952

Recordable Plat

240/54A

548 1-1-24A

16576