

GREENVILLE, S.C. 29615
 AUG 2 12 32 PM '84
 DONALD S. WOODS, SURVEYOR

NOTE:
 PARCEL "C" GRAYSTONE III IS PROVIDED PUBLIC ROAD ACCESS BY A RIGHT-OF-WAY AND EASEMENT 20' IN WIDTH FOR PURPOSES OF INGRESS AND EGRESS TO STALLINGS ROAD ACROSS PROPERTY OF ACADEMY RENTAL COMPANY, INC. AS RECORDED IN DEEDBOOK 1156 PAGE 460.

CERTIFICATION:
 1. () This is to certify that the bearings and distances, and/or measurements, shown on this plat are correct and that all rights of way, easements, and encroachments, obvious and apparent from field observation of the subject property of the time of the survey are as shown.

2. () This is to certify that the area of the subject property shown on this plat was computed by the coordinate method of area calculation and that this is a CLASS _____ survey.

3. () The Department of Housing and Urban Development Floodway Data for Greenville County shows this property () to be in a flood plain, () not to be in a flood plain, () location cannot be determined.

William V. Wood
 SIGNATURE OF REGISTERED LAND SURVEYOR DATE 8/2/84 REG. NO. 726

REFERENCES

PB 8 N - 36	DB 1064 - 509	BB P - 23
PB 8 I - 65	DB	BB
PB 8 I - 73	DB	BB
PB	DB	BB

REVISIONS AND RECERTIFICATIONS

NO.	BY	DATE	DESCRIPTION	JOB NO. REFERENCE	APPROVED
1	WNS	22-10-82	REVISED BOUNDARY	80062	C.J.R.
2	RES	10-JUL-84	ADDED EASEMENT	84111	JDM

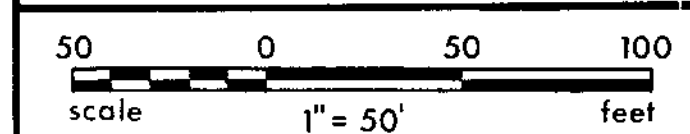
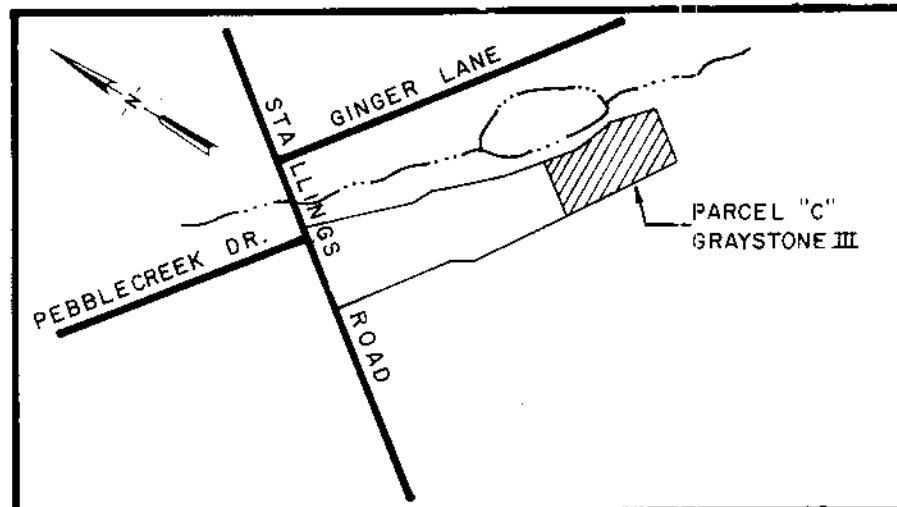

Arbor Engineering, Inc.
 P.O. BOX 263, GREENVILLE, S.C.
 LANDSCAPE ARCHITECTS · ENGINEERS · RECREATIONAL PLANNERS

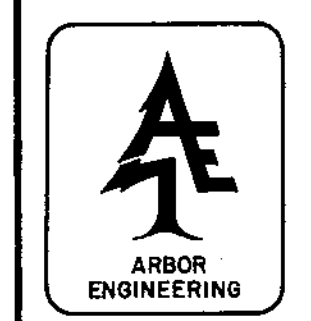

SEAL

PARCEL "C" GRAYSTONE III

**PROPERTY SURVEY FOR
 PEBBLE CREEK P.U.D.
 PHASE IX SECTION I**

GREENVILLE SOUTH CAROLINA

DRAWN	WNS	DESIGN	TAG	CHECK	CJR	DATE	26 OCT 1982
SCALE	1" = 50'	FILE		DWG. NO.			82184

AUG 3 1984
 10-4-57 3922