

MICROFILMED

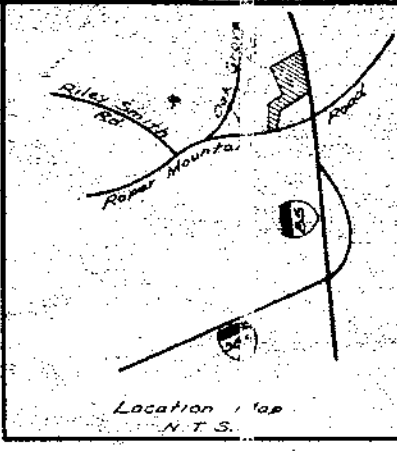

AREA - 778,619 Sq. Ft. - 17.875 Ac.

248 Units

496 Parking Spaces

Note:
Tennis Court Area
Information From Plat
By G. C. Jones, Engr.
Dated April 27, 1984

ROPER MT. ROAD

Huntington Arms
151' From P.O. To
Cox Grove Lake Road

AS BUILT SURVEY
FOR

ROPER MOUNTAIN VILLAS

GREENVILLE CO., S.C.

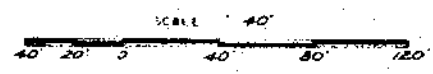

MARCH 6, 1984
Boundary & Area Revised May 7, 1984

FILED
GREENVILLE CO., S.C.
MAY 28 12 54 PM '84
DONNIE STANKERLEY
R.M.C.

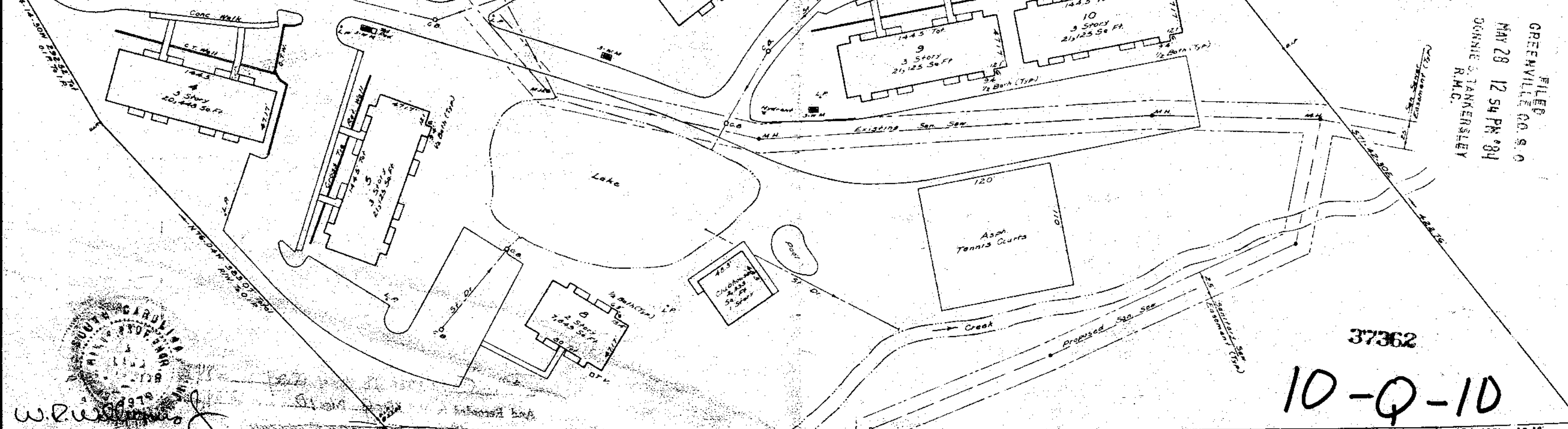

37362

10-Q-10

INTERSTATE 85

MAY 28 1984

W. R. Williams
W.R.W. ENGINEERS
13 S. MAIN STREET
TRAVELERS REST, S.C.
29680