

FILED
GREENVILLE, S.C.

MAY 23 9 06 AM '84
JUNNIE S. JANKERSLEY
R.M.C.

BLOCKLEY AVENUE
WATER & SEWER IN ST. R/W

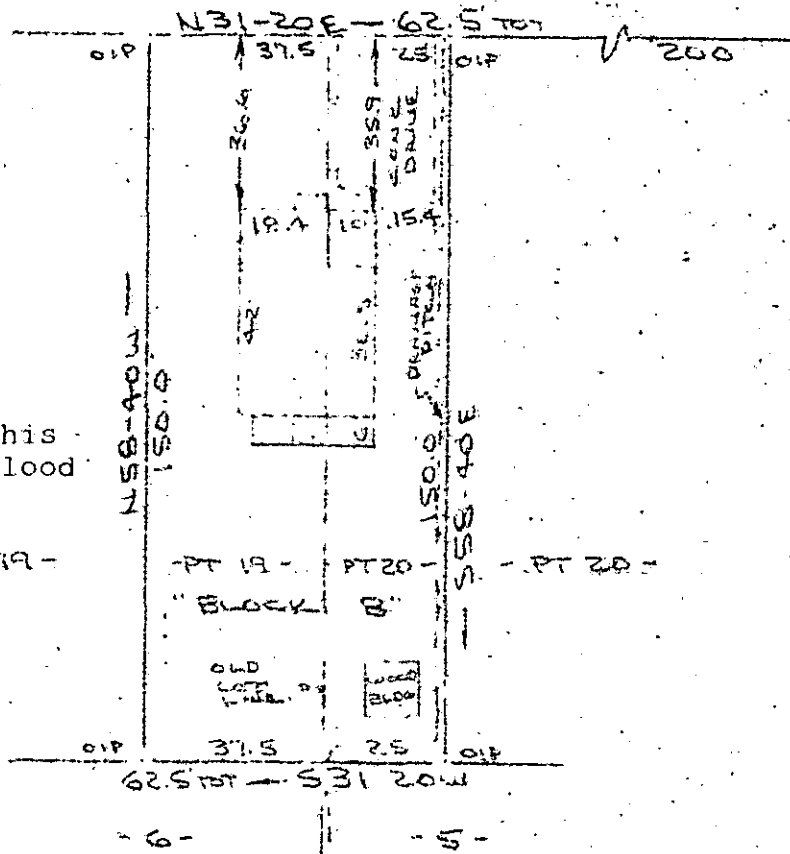

Note: Improvements on this lot are not in a flood hazard area.

PROPERTY OF
PHILLIP E. GRISWOLD
GREENVILLE, S.C.

21 MAY 1984

MAY 23 1984

10P-88 36863

This is to certify that on the 21st day of May, 1984, I surveyed the property shown on this plat being known as part of lot 19 and part of lot 20 on plat of Map Of FAIR HEIGHTS and recorded on the RMC Office Greenville, County, S.C. in plat book " F " at page 257; and that the property lines, walls and buildings are as shown hereon, and that the buildings located on said lot do not encroach or project on adjacent street or property, and that no adjacent buildings or walls encroach or project on said premises.

R. B. Bruce
R.B. Bruce, RLS, # 1952

CAROLINA SURVEYING CO.
112 Manly St.
Greenville, S. C.

Recordable Plat

GC10 -- 1 MY23 84 1004

3.0001