

**NOTES**

1. THERE IS A 5' UTILITY AND DRAINAGE EASEMENT ALONG EACH SIDE OF ALL SIDE PROPERTY LINES, AND A 5' EASEMENT ALONG EACH SIDE OF REAR PROPERTY LINES.
2. THERE ARE DISCREPANCIES IN THIS SURVEY AND PLAT 9W-46.
3. THE MONUMENTATION APPEARS TO BE MONUMENTATION OF RECORD.
4. PINS ALONG FRONT OF PROPERTY AGREE WITH OTHER FRONT PINS OF RECORD.
5. PINS ALONG REAR OF PROPERTY AGREE WITH OTHER REAR PINS OF RECORD.

**REVISIONS AND RECERTIFICATIONS**

NO.	BY	DATE	DESCRIPTION	JOB NO.	REFERENCE	APP.
1						
2						
3						
4						

**REFERENCES**

BB 275.1-1-19	DB 1153-408	PB 9W-46
BB	DB	PB 8Q-64
BB	DB	PB
BB	DB	PB

**LOCATION MAP**

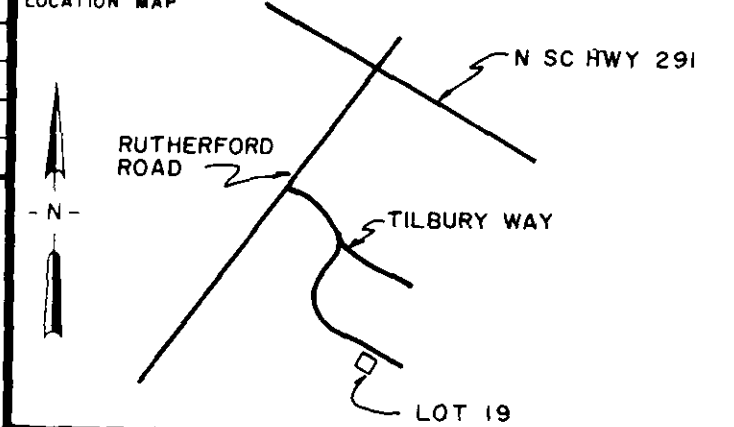

FILED  
GREENVILLE CO. S.C.  
MAY 2 3 51 PM '84  
DONNIE S. TANKERSLEY  
R.M.C.

LOT 18

LOT 19

LOT 20

MAY 2 1984

34365

V 10-N-53

M A G N E T I C

**CERTIFICATION**

THIS IS TO CERTIFY TO J. FRANK & MARY M. BLACK THAT AN ACTUAL FIELD SURVEY WAS PERFORMED ON THIS PROPERTY UNDER MY SUPERVISION AND I DECLARE THAT:

- (1) THE FIELD SURVEY AND THIS PLAT REPRESENT A DEPENDENT RESURVEY OF THE SUBJECT PROPERTY AND THAT THE INFORMATION SHOWN HEREON IS CORRECT TO THE BEST OF MY PROFESSIONAL KNOWLEDGE AND BELIEF.
- (2) ALL RIGHTS OF WAY, EASEMENTS AND ENCROACHMENTS OBVIOUS AND APPARENT FROM FIELD OBSERVATION OF THE SUBJECT PROPERTY AT THE TIME OF THE SURVEY ARE AS SHOWN.
- (3) THE AREA OF THE SUBJECT PROPERTY WAS CALCULATED BY COORDINATES AND THAT THIS IS A CLASS B SURVEY.

*William L. ...*  
SIGNATURE OF REGISTERED LAND SURVEYOR DATE 29 APR 84 S.C. REG. NO. 2761

THIS IS TO CERTIFY TO J. FRANK & MARY M. BLACK THAT THIS DRAWING IS A COMPOSITE PLAT AND DOES NOT CONSTITUTE AN ACTUAL FIELD SURVEY, AND THAT ANY USE OF THIS DRAWING FOR ANY PURPOSE OTHER THAN GENERAL REFERENCE IS DONE SO WITH THE UNDERSTANDING THAT ARBOR ENGINEERING INC. ASSUMES NO RESPONSIBILITY OR LIABILITY FOR ITS ACCURACY OR CORRECTNESS.

SIGNATURE OF REGISTERED LAND SURVEYOR DATE S.C. REG. NO.

THE DEPARTMENT OF HOUSING AND URBAN DEVELOPMENT FLOOD WAY DATA FOR GREENVILLE COUNTY SHOWS THIS PROPERTY  TO BE IN A FLOOD PLAIN AREA  NOT TO BE IN A FLOOD PLAIN AREA  LOCATION CANNOT BE DETERMINED.

**PROPERTY SURVEY FOR  
J. FRANK BLACK AND  
MARY M. BLACK**

**LOT No. 19  
STONE GLEN SUBDIVISION  
GREENVILLE SOUTH CAROLINA**

SCALE 20 0 20 40

RESEARCH TAG DRAWN WNS CHECK TAG DATE 29 APR 1984  
FILE FIELD WORK BY T.R. & P.G. JOB NO. 84125

**ARBOR ENGINEERING**  
P.O. BOX 263, GREENVILLE, S.C.  
LANDSCAPE ARCHITECTS ENGINEERS LAND SURVEYORS