

MICROFILMED

WESTWOOD ; SEC. III

FILED  
GREENVILLE CO. S.C.

APR 16 3 16 PM '84

DONNIE S. BANKERSLEY  
R.M.C.

S 23 21 E 200.0

N

38-18 E

161.0

17

18

16

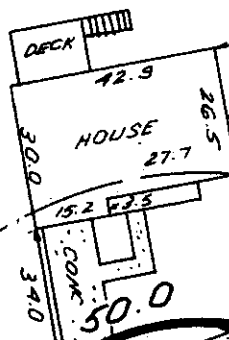

46.9

147.2

N 82-10 W

30' BL.

N 42-34 W

50' RAD

661.72 ± TO  
PINE DR.

NEEDLES  
DRIVE

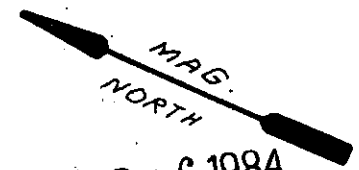

APR 16 1984

10-L-98

NOTE: 5' UTILITY &  
DRAINAGE EASEMENT  
EACH SIDE OF ALL SIDE  
& REAR LOT LINES.

32216



THIS IS TO CERTIFY THAT THE PROPERTY SHOWN ON THIS PLAT WAS SURVEYED UNDER MY DIRECT SUPERVISION. PROPERTY LINES AND IMPROVEMENTS SHOWN ARE LOCATED CORRECTLY AND THAT NO VISIBLE ENCROACHMENTS EXIST UNLESS OTHERWISE SHOWN. THIS PROPERTY IS NOT LOCATED IN A DESIGNATED FLOOD HAZARD AREA.

STATE OF SOUTH CAROLINA  
GREENVILLE COUNTY

FREELAND & ASSOCIATES  
Engineers • Land Surveyors  
318 WEST STONE AVENUE.  
GREENVILLE, S.C.  
(803) 271-4924

PINE TREE  
LOT 17  
PROPERTY OF  
PAUL K. RAPPOLD

PLAT BOOK	500 63
DEED BOOK	
TAX MAP	574.12-1-17
PARTY CHIEF	P.J.
DRAWN	K.E.G.
DATE	4/12/84
DWG. NO.	10874

31801

REGISTERED LAND SURVEYOR  
SOUTH CAROLINA  
4781  
JAMES B. FREELAND  
R.M.C.  
NO: 4781