

MICROFILMED

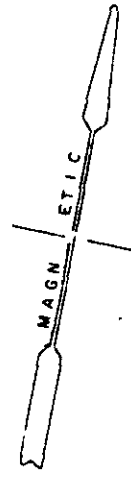

PLAT RMC G 30
 PT. - LOT 16 & 17
 MRS. B. E. BURNS PROP.

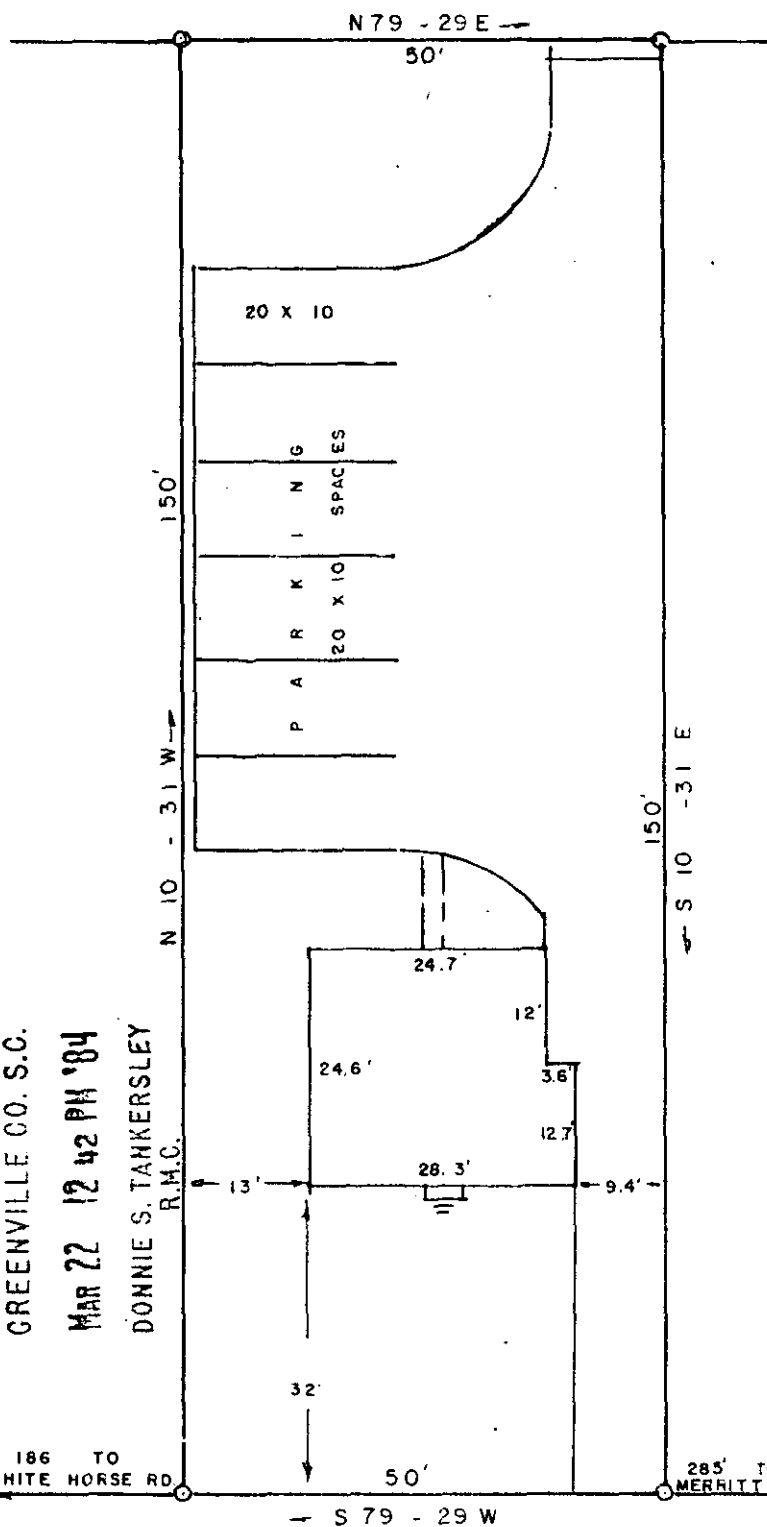
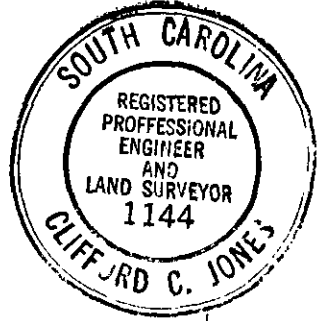

29222

10-J-100

FILED GREENVILLE CO. S.C. MAR 22 12 42 PM '84 DONNIE S. TANKERSLEY R.M.C.

BENT BRIDGE RD.

PROPERTY OF

MAR 22 1984

PITTMAN'S TEXTILE MACHINERY

& SUPPLY CO. INC.

GREENVILLE COUNTY, S. C.

SCALE 1" = 20' OCT. 15, 1975

3.00CI