

MICROFILMED

53

52

53 A



54

56

N 72-18 E 104.2

175.8

170.4

PART LOT 55

PT 55

50' B.L. ?

N 14-46 W

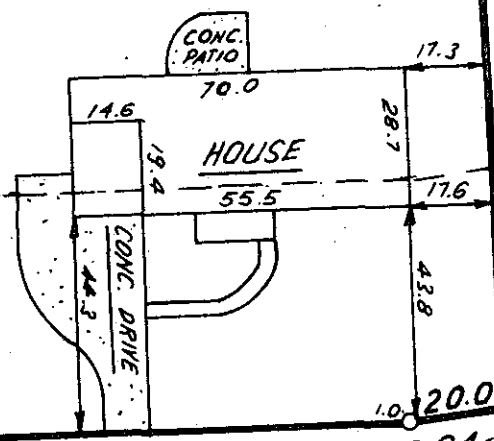

FILED
GREENVILLE CO. S.C.
MAR 19 3 26 PM '84
DONNIE S. TANKERSLEY
R.M.C.

36.7' ± TO
ASHMORE BRIDGE RD.

S 70-48 W 100.0

S 19-35 E
S 64-58 W

MAPLE DRIVE

MAR 19 1984

28764

10J-85



THIS IS TO CERTIFY THAT THE PROPERTY SHOWN ON THIS PLAT WAS SURVEYED UNDER MY DIRECT SUPERVISION. PROPERTY LINES AND IMPROVEMENTS SHOWN ARE LOCATED CORRECTLY AND THAT NO VISIBLE ENCROACHMENTS EXIST UNLESS OTHERWISE SHOWN. THIS PROPERTY IS NOT LOCATED IN A DESIGNATED FLOOD HAZARD AREA.

SOUTH CAROLINA
REGISTERED
LAND SURVEYOR
NO. 4781
JAMES R. FREELAND

P.S. JAMES R. FREELAND
NO. 4781

**STATE OF SOUTH CAROLINA
GREENVILLE COUNTY**

**PEACHTREE TERRACE
LOT PT. 55
PROPERTY OF
DAVID B. MILL
ROBIN B. MILL**

FREELAND & ASSOCIATES
Engineers • Land Surveyors
318 WEST STONE AVENUE.
GREENVILLE, S.C.
(803) 271-4924

PLAT BOOK	92-90
DEED BOOK	1196-573
TAX MAP	M 62-1-98
PARTY CHIEF	J. E. C.
DRAWN	B. R.
DATE	3-13-84
DWG. NO.	10,690