

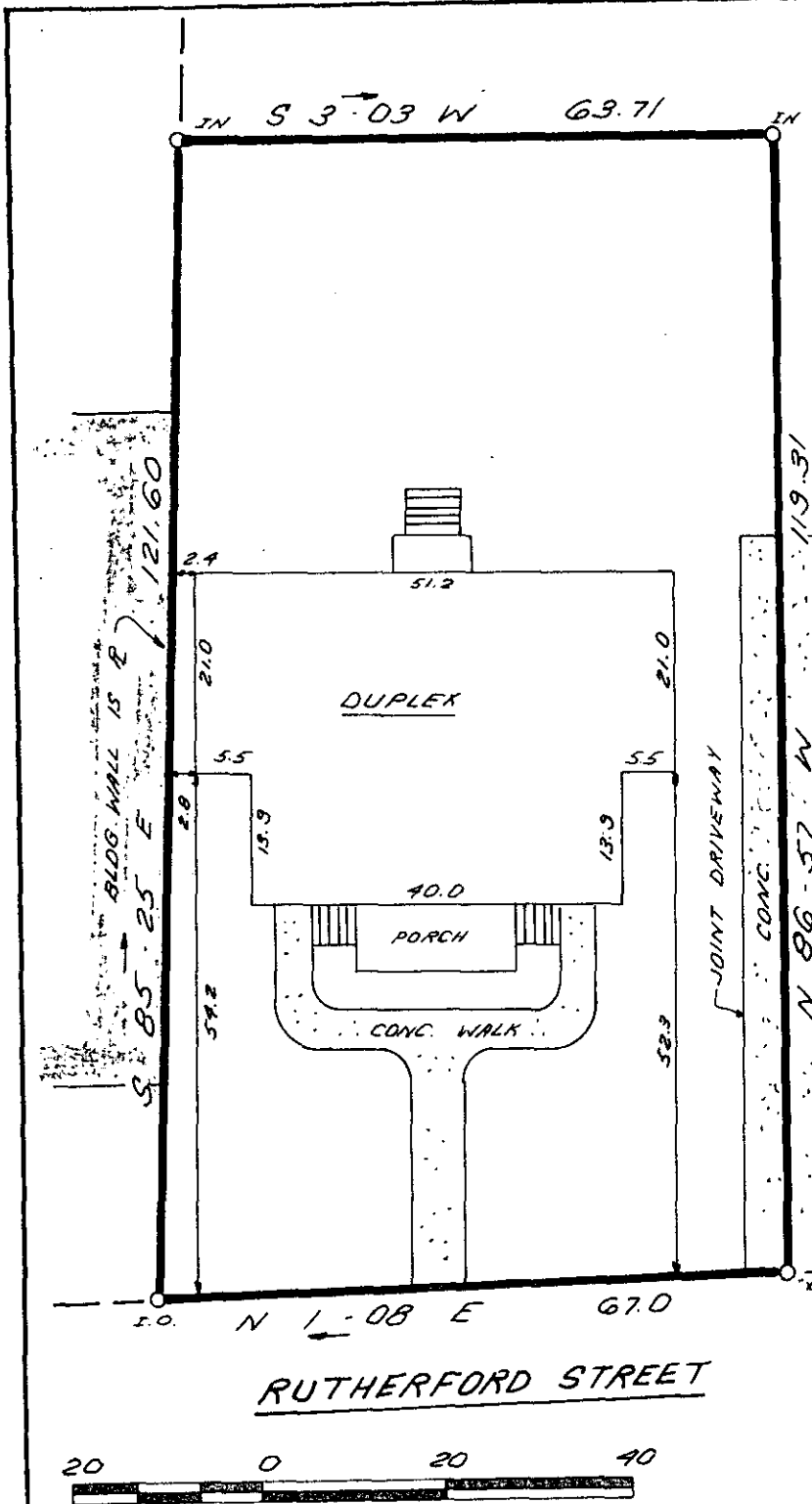

This is to certify that on February 9, 1984, I surveyed the property shown on this plat, and that the property lines, walls and buildings are as shown hereon; that the building located on said lot does not encroach or project on adjacent streets or property, and that no adjacent walls or buildings encroach or project on said premises, and that no utility lines cross this property except as shown hereon. This property is not located in a designated flood hazard area.

Fredrick E. Landrith
Fredrick E. Landrith
RLS 9545

FILED
GREENVILLE CO. S. C.
FEB 10 3 12 PM '84
DONNIE S. JANKENSLY
R.M.C.



RUTHERFORD STREET

141' ± TO
RANDALL ST.

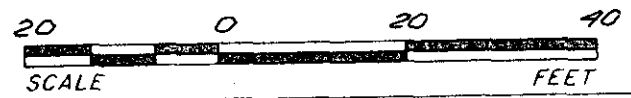

STATE OF SOUTH CAROLINA
GREENVILLE COUNTY

FREELAND & ASSOCIATES
Engineers • Land Surveyors
GREENVILLE, S.C.

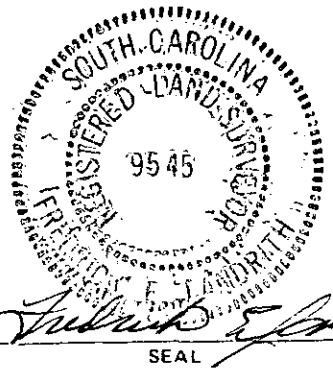

PROPERTY OF
DEAN O. WEBB

21775

SURVEY	F. E. L.
DRAWN	K. E. G.
CHECK	M. C.
SCALE	1" = 20'
DATE	2-9-84
DWG. NO.	9924

10-H-47

THE PRINT MACHINE, INC. N30331