

MICROFILMED

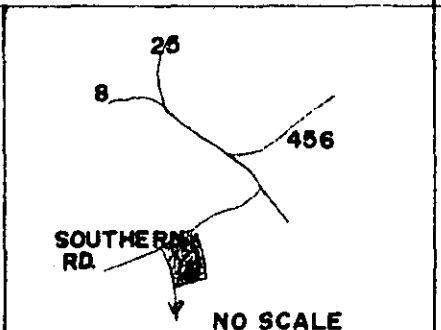

FILED  
GREENVILLE CO. S. C.  
JUL 25 1983 43 PH '83  
DONNIE TANKERSLEY  
R.M.C.  
S76-18E197' N.C.  
S70-11E198' N.C.  
S81-17E2268' N.C.  
N81-20E180' N.C.  
IP N62-35E58' N.C.

SOUTHERN ROAD RW UNKNOWN

BEVER DAM CREEK THE LINE  
N11-59W 1436.4'

(23.82) AC±

S17-40E 1240.46'  
KEN PENSMTITH

MAGNETIC

IP858'  
S79-37W 870'  
BEULAH STOKES EST.

JUL 25 1983

STATE OF SOUTH CAROLINA  
GREENVILLE COUNTY  
PLAT OF PROPERTY OWNED BY THOMAS R. IRBY AND SHELVY JEAN IRBY.  
COMPILED FROM OLD PLATS AND DRAWN JULY 19, 1983. NO SURVEY AT THIS TIME.

JOHN C. SMITH & SON  
REG. LS. CMO. 11413 & 7882  
P.O. BOX 732  
EASLEY, S.C. 29610

2752

9-V-73

5010 --- 1 JUL 25 83 448

3.000

