

-NIF M.R. RAINES-

GREENVILLE
FILED 09-00E

S10-58E
68.3'

JUL 8 9 00 AM '83
DONNIE S. R.M.C.

-13-

PROPOSED HOUSE
FIN. FL. ELEV. 336.5

GROUND ELEVATIONS
IN CLEARED AREA

-15-

-14-

-NIF W.D. SWEATHEER COLLINS-

N73-43E
259.0'

204.8'
S73-33W

30'
BL

112.3'
N50-52W
BERRY RD.

TOP M.H. IS P.M.
ELEV 842.75'
INV ELEV. 342.75'

136'
N16-43W

W SURVEY FOR
H. ALFORD
NEAR GREENVILLE, S.C.
50.7 JUL 0 1983 50.

885

9-V-15 ✓

I Certify That The Ratio Of Precision Of The Field Survey
Is 1/5000 As Shown Hereon And That The Area
Determined By D.M.C. Method Of AREA CALCULATION.

R. B. [Signature]

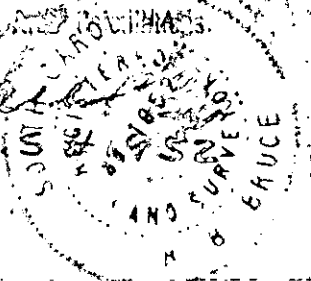

CAROLINA SURVEYING CO
112 MANLY ST
GREENVILLE, S.C.

MICROFILMED

253/30 133

01 OF
J38.8-1-2

SECTION 8 JUL 8 83

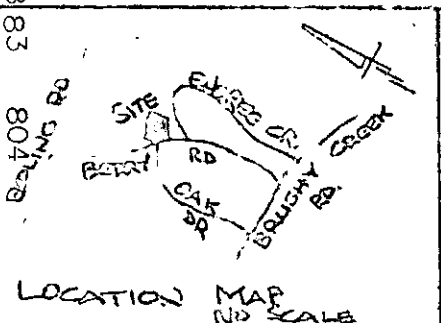

1000 3