

MICROFILMED

FILED
GREENVILLE CO. S. C.

MAY 10 4 46 PM '83

DONNIE S. TANKERSLEY
I.B.M.C.

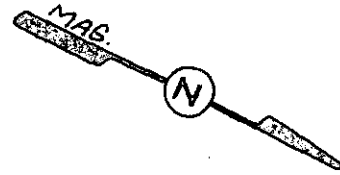

N 25-57 W 86.20

10

139.27

7

S 64-10 W

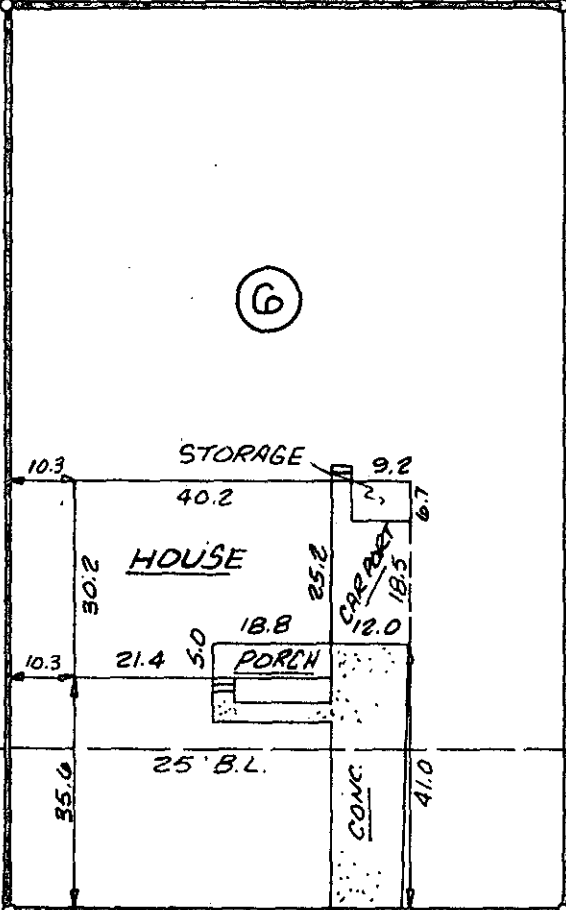

139.24

N 64-10 E

This is to certify that on April 25, 1983, I surveyed the property shown on this plat, known as Lot 6 on the plat of Luis Moreno Property, recorded in the RMC Office of Greenville County in Plat Book 9F on page 20 and that the property lines, walls and buildings are as shown hereon; that the building located on said lot does not encroach or project on adjacent streets or property, and that no adjacent walls or buildings encroach or project on said premises, and that no utility lines cross this property except as shown hereon. This property is not located in a designated flood hazard area.

James R. Freeland
James R. Freeland PE and RLS 4781

5' drainage & utility easement along each side and rear lots line.

S 25-58 E 86.20

CARDINAL DRIVE

620.08' ± TO
LEE RD.

MAY 10 1983

9-S-55

29752



5010
2 MT 1083
392
S. 0061



SEAL

STATE OF SOUTH CAROLINA
GREENVILLE COUNTY

LUIS MORENO PROPERTY
LOT 6
PROPERTY OF
DOUGLAS E. GRACELY
PHYLLIS H. GRACELY

FREELAND & ASSOCIATES
Engineers • Land Surveyors

GREENVILLE, S.C.

SURVEY LT

DRAWN KEG

CHECK *JRF*

SCALE 1" = 30'

DATE 4-25-83

DWG. NO. 8822